

CONTRACT NO.				
F.A. RTE.	SECTION	COUNTY	TOTAL SHEETS	SHEET NO.
1407	66 R	DUPAGE	412	175
STA. 23+00.00		TO STA. 144+00.00		
FED. ROAD DIST. NO.		ILLINOIS FED. AID PROJECT		
CONTRACT 62376				

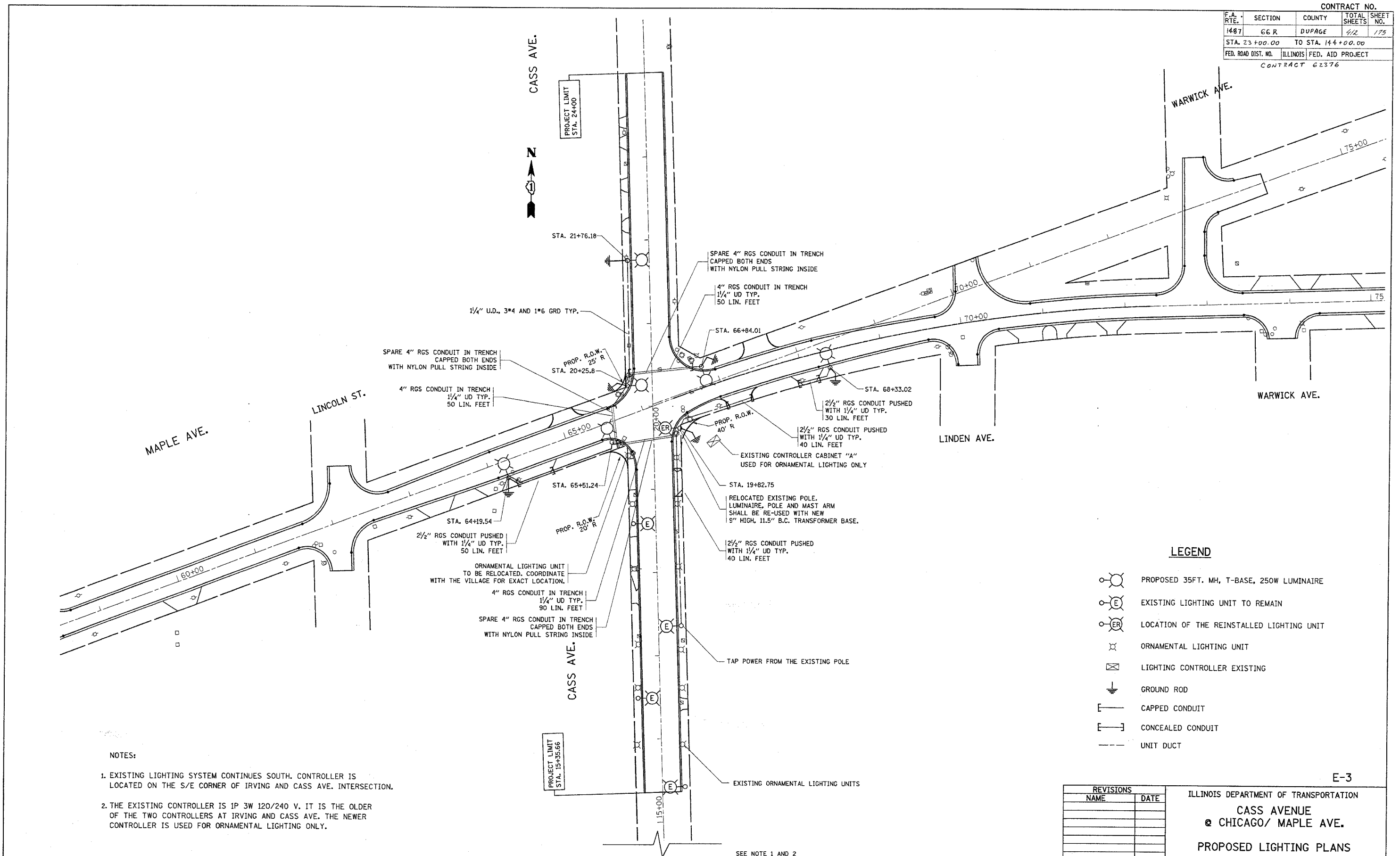

- NOTES:**
- EXISTING LIGHTING SYSTEM CONTINUES SOUTH. CONTROLLER IS LOCATED ON THE S/E CORNER OF IRVING AND CASS AVE. INTERSECTION.
 - THE EXISTING CONTROLLER IS 1P 3W 120/240 V. IT IS THE OLDER OF THE TWO CONTROLLERS AT IRVING AND CASS AVE. THE NEWER CONTROLLER IS USED FOR ORNAMENTAL LIGHTING ONLY.

LEGEND

	PROPOSED 35FT. MH, T-BASE, 250W LUMINAIRE
	EXISTING LIGHTING UNIT TO REMAIN
	LOCATION OF THE REINSTALLED LIGHTING UNIT
	ORNAMENTAL LIGHTING UNIT
	LIGHTING CONTROLLER EXISTING
	GROUND ROD
	CAPPED CONDUIT
	CONCEALED CONDUIT
	UNIT DUCT

REVISIONS	
NAME	DATE

ILLINOIS DEPARTMENT OF TRANSPORTATION
CASS AVENUE
@ CHICAGO/ MAPLE AVE.
PROPOSED LIGHTING PLANS

SCALE: VERT. 1"=10'
 HORIZ. 1"=40'
 DATE 11/17/2004

DRAWN BY 100T
 CHECKED BY 100T

SEE NOTE 1 AND 2