

| | | | | |
|---------------------|----------|-------------------|--------------|-----------|
| CONTRACT NO. | | | | |
| F.A. RTE. | SECTION | COUNTY | TOTAL SHEETS | SHEET NO. |
| 1487 | 66R | DUPAGE | 4/2 | 176 |
| STA. 23+00.00 | | TO STA. 144+00.00 | | |
| FED. ROAD DIST. NO. | ILLINOIS | FED. AID PROJECT | | |
| CONTRACT 62376 | | | | |

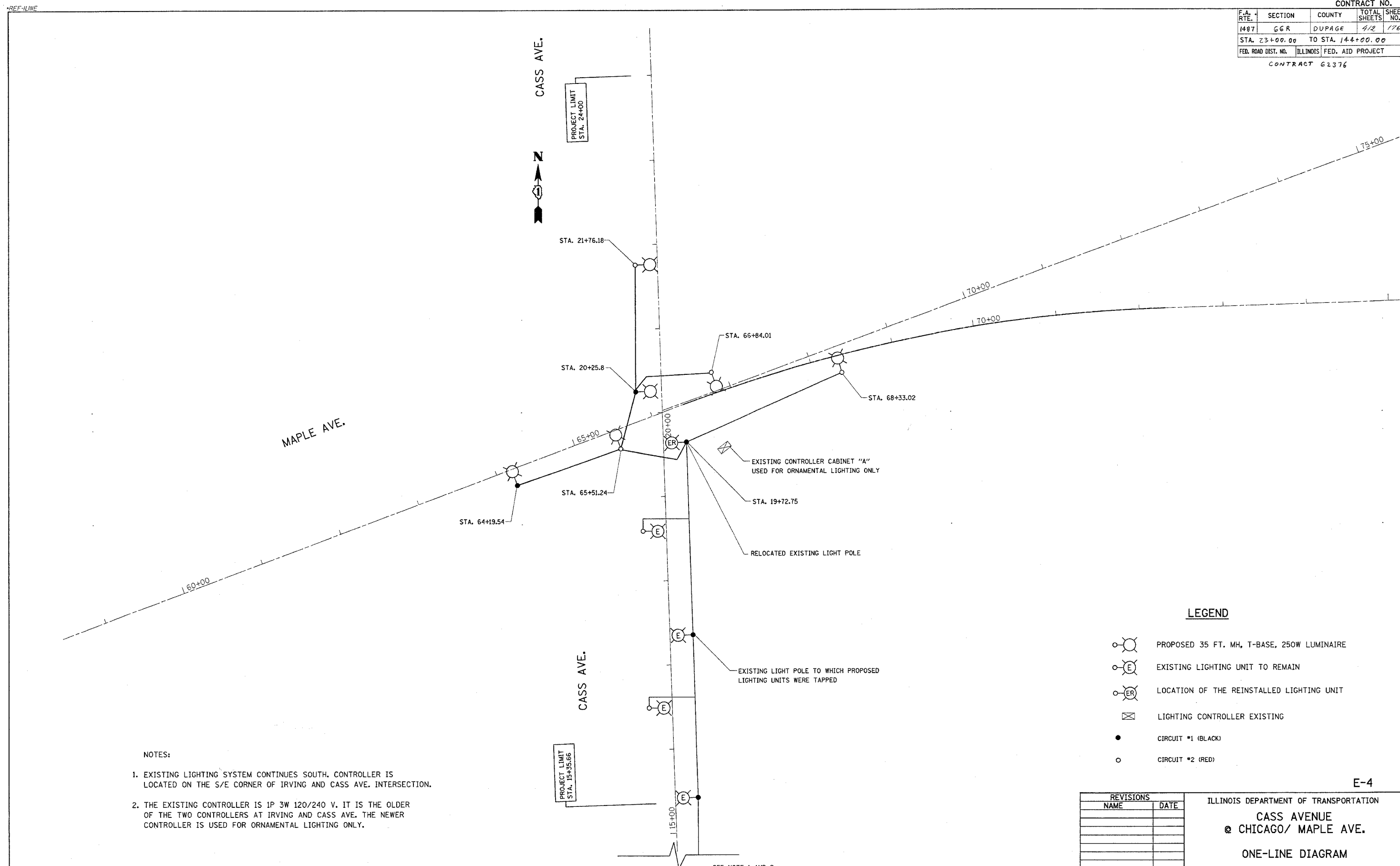

- NOTES:
- EXISTING LIGHTING SYSTEM CONTINUES SOUTH. CONTROLLER IS LOCATED ON THE S/E CORNER OF IRVING AND CASS AVE. INTERSECTION.
 - THE EXISTING CONTROLLER IS 1P 3W 120/240 V. IT IS THE OLDER OF THE TWO CONTROLLERS AT IRVING AND CASS AVE. THE NEWER CONTROLLER IS USED FOR ORNAMENTAL LIGHTING ONLY.

LEGEND

- PROPOSED 35 FT. MH, T-BASE, 250W LUMINAIRE
- EXISTING LIGHTING UNIT TO REMAIN
- LOCATION OF THE REINSTALLED LIGHTING UNIT
- LIGHTING CONTROLLER EXISTING
- CIRCUIT #1 (BLACK)
- CIRCUIT #2 (RED)

E-4

| REVISIONS | |
|-----------|------|
| NAME | DATE |
| | |
| | |
| | |
| | |
| | |
| | |
| | |
| | |
| | |
| | |

ILLINOIS DEPARTMENT OF TRANSPORTATION
CASS AVENUE
@ CHICAGO/ MAPLE AVE.
ONE-LINE DIAGRAM

SCALE: VERT. 1"=100'
 HORIZ. 1"=100'
 DATE 11/17/2004

DRAWN BY 100T
 CHECKED BY 100T

SEE NOTE 1 AND 2