

DATE _____ BY _____
 SURVEYED _____
 FINAL SURVEY _____
 NOTE BOOK _____
 NO. _____
 AREAS CHECKED _____

DATE _____ BY _____
 SURVEYED _____
 ORIGINAL SURVEY _____
 NOTE BOOK _____
 NO. _____
 AREAS CHECKED _____

F.A.U. RTE. 1487	SECTION 66R	COUNTY DuPAGE	TOTAL SHEETS 412	SHEET NO. 407
STA. 23+00.00		TO STA. 144+00.00		
FED. ROAD DIST. NO. ILLINOIS		FED. AID PROJECT		
CONTRACT NO. 62376				

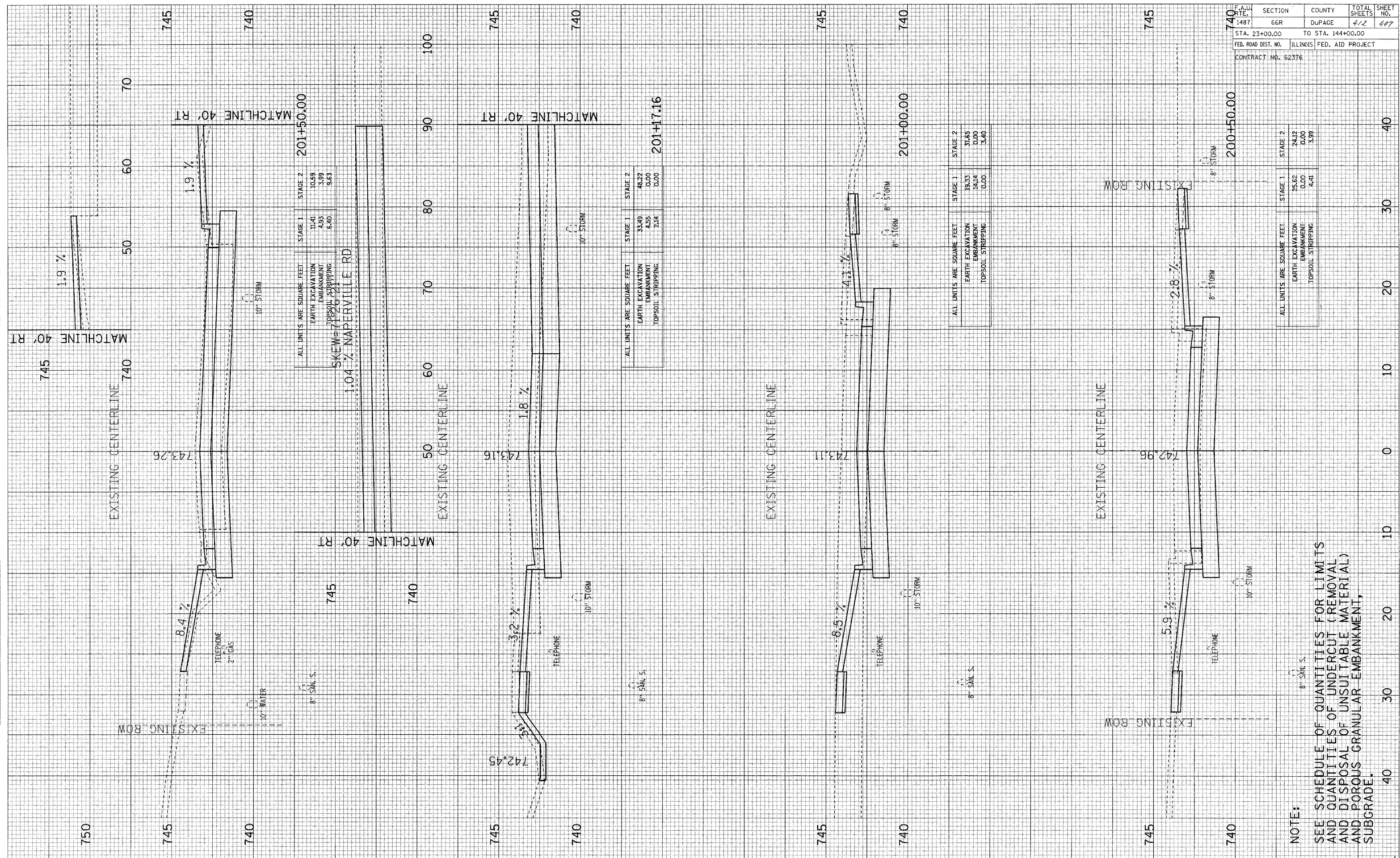

NOTE:
 SEE SCHEDULE OF QUANTITIES FOR LIMITS
 AND QUANTITIES OF UNDERCUT (REMOVAL
 AND DISPOSAL OF UNSUITABLE MATERIAL)
 AND POROUS GRANULAR EMBANKMENT,
 SUBGRADE.