

FAP 330	SECTION	COUNTY	TOTAL SHEETS	SHEET NO.
FAI 90/94	2004-1241	COOK	36	26

CONTRACT 62603

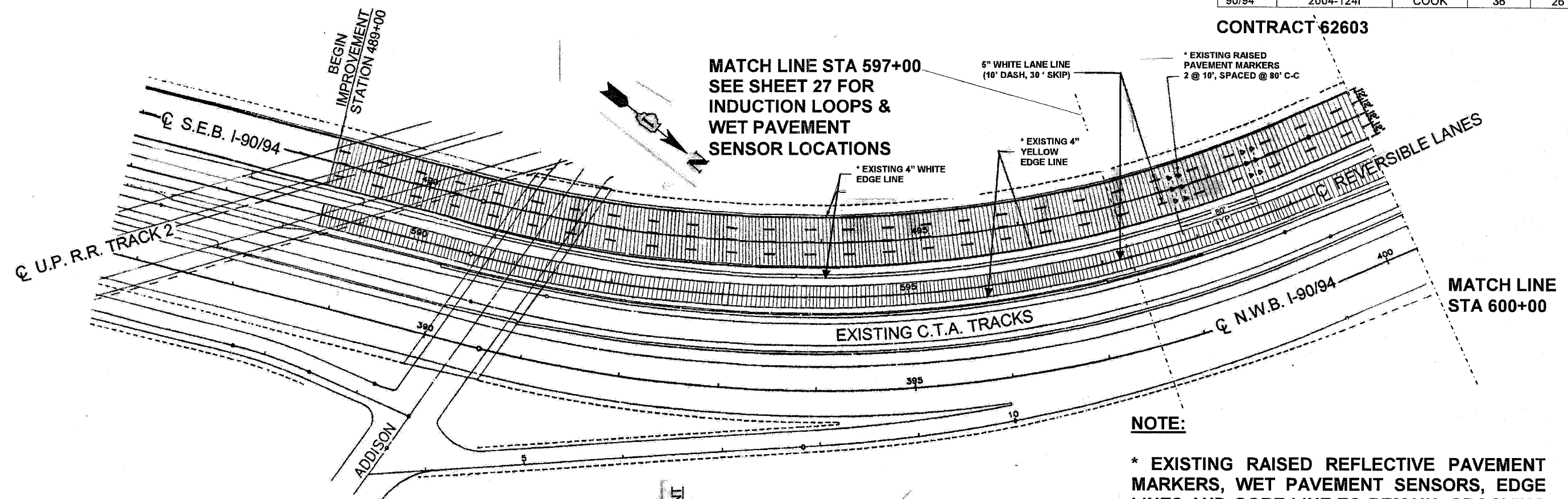

MATCH LINE STA 597+00
SEE SHEET 27 FOR
INDUCTION LOOPS &
WET PAVEMENT
SENSOR LOCATIONS

NOTE:

* EXISTING RAISED REFLECTIVE PAVEMENT MARKERS, WET PAVEMENT SENSORS, EDGE LINES AND GORE LINE TO REMAIN. GROOVING SHALL STOP WITHIN 2" ± 1" OF EITHER SIDE OF THE RAISED REFLECTIVE PAVEMENT MARKERS SO AS NOT TO DAMAGE EXISTING RAISED REFLECTIVE PAVEMENT MARKERS. GROOVING SHALL STOP WITHIN 2" ± 1" OF THE WET PAVEMENT SENSOR SO AS NOT TO DAMAGE THE WET PAVEMENT SENSOR. GROOVING SHALL STOP 2" ± 1" OF THE EDGE LINES OR GORE LINES SO AS NOT TO DAMAGE EXISTING EDGE OR GORE LINES.

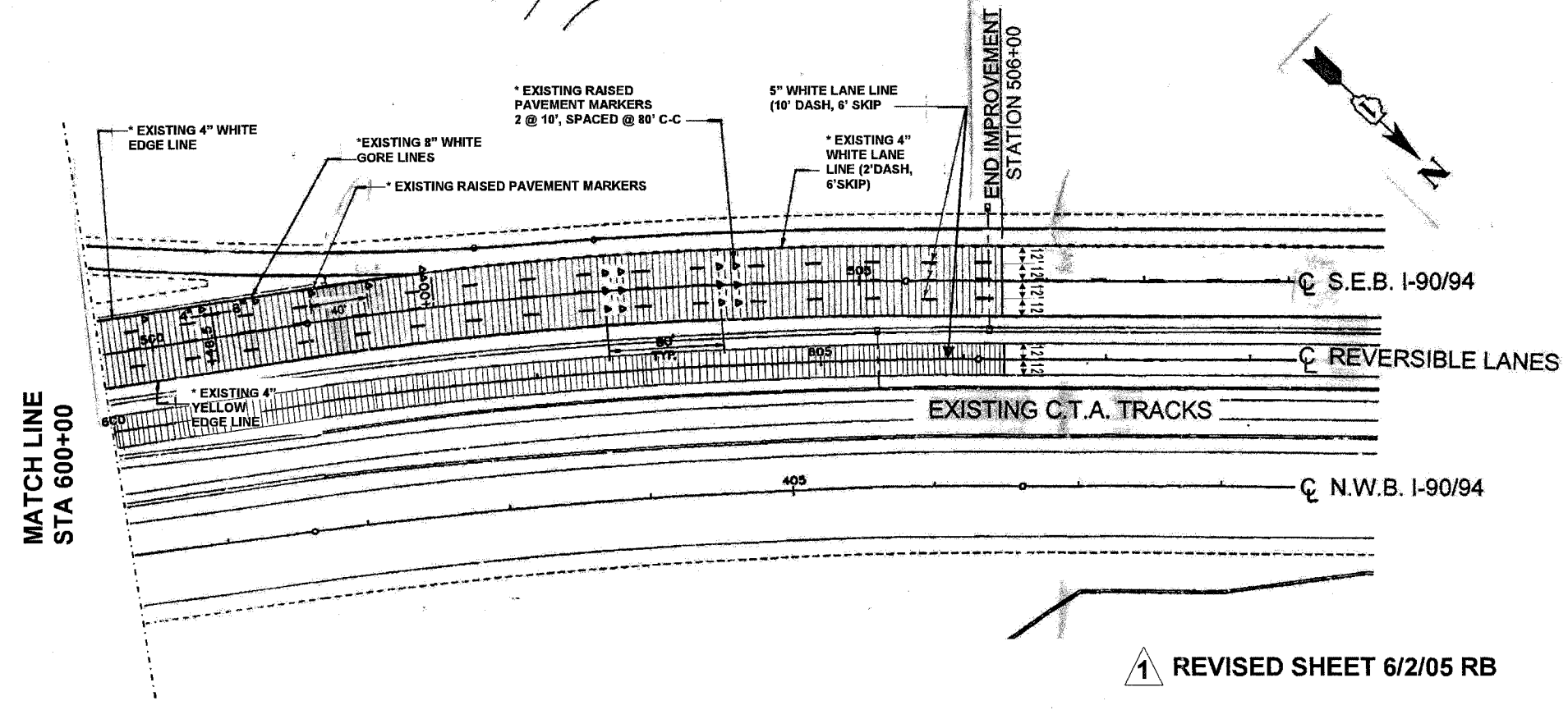

 PAVEMENT GROOVING

ILLINOIS DEPARTMENT OF TRANSPORTATION
PAVEMENT GROOVING PLAN
LOCATION 2: I 90/94

1 REVISED SHEET 6/2/05 RB

Microsoft Word - I90-9411X17GROOVINGPLAN.doc: 06:11:38 06/02/2005