

F.A.I. RTE.	SECTION	COUNTY	TOTAL SHEETS	SHEET NO.
94		COOK	860	63
STA. 2200+00.00		TO STA. 2362+00.00		
FED. ROAD DIST. NO.		ILLINOIS FED. AID PROJECT		
* (1516.1, 1717 & 1818) R-8		62694		

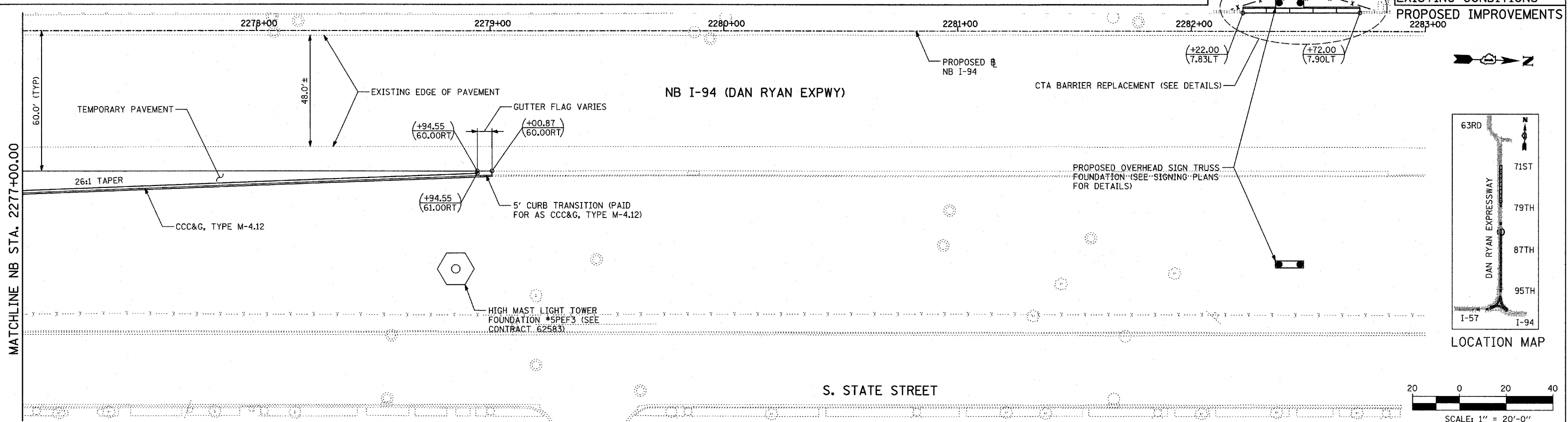
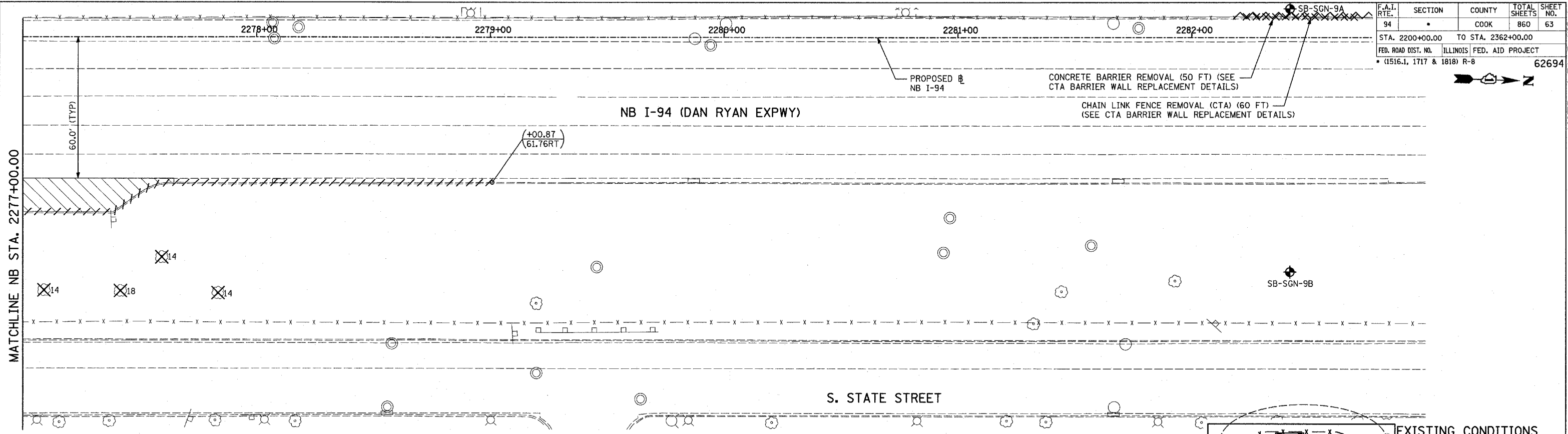

LEGEND:

- | | | | | | |
|--|------------------------------------|--|---|--|---|
| | PAVEMENT REMOVAL | | COMB CONC CURB & GUTTER REMOVAL | | MAINLINE # STATION/OFFSET |
| | PAVED SHOULDER REMOVAL | | CHAIN LINK FENCE REMOVAL | | RAMP # STATION/OFFSET |
| | PAVEMENT/SHOULDER REMOVAL, SPECIAL | | CONCRETE BARRIER/GUARDRAIL REMOVAL | | |
| | | | TREE REMOVAL (UNITS) (NO UNIT SHOWN = <6) | | NOTES: |
| | | | SOIL BORING LOCATIONS | | - ALL STATION/OFFSET/RADIUS CALLOUTS MEASURED TO EDGE OF PAVEMENT UNLESS OTHERWISE NOTED. |
| | | | LIGHT POLE FOUNDATION REMOVAL (SEE EXISTING ELECTRICAL PLANS) | | - EXACT LOCATIONS OF EXISTING PIERS/ABUTMENTS TO BE FIELD VERIFIED |

REVISIONS	
NAME	DATE

ILLINOIS DEPARTMENT OF TRANSPORTATION
F.A.I. 94 (DAN RYAN EXPRESSWAY)
 EXISTING AND PROPOSED PLAN
 NB 87th STREET ENTRANCE RAMP
 NB I-94 STA. 2277+00.00 TO 2279+00.87
 SCALE: 1"=20'
 DATE: MARCH 18, 2005
 DRAWN BY: MPG
 CHECKED BY: JPM

TYLIN INTERNATIONAL

