

F.A.I. RTE.	SECTION	COUNTY	TOTAL SHEETS	SHEET NO.
94		COOK	860	64
STA. 2200+00.00 TO STA. 2362+00.00				
FED. ROAD DIST. NO. ILLINOIS		FED. AID PROJECT		
* (1516.1, 1717 & 1818) R-8		62694		

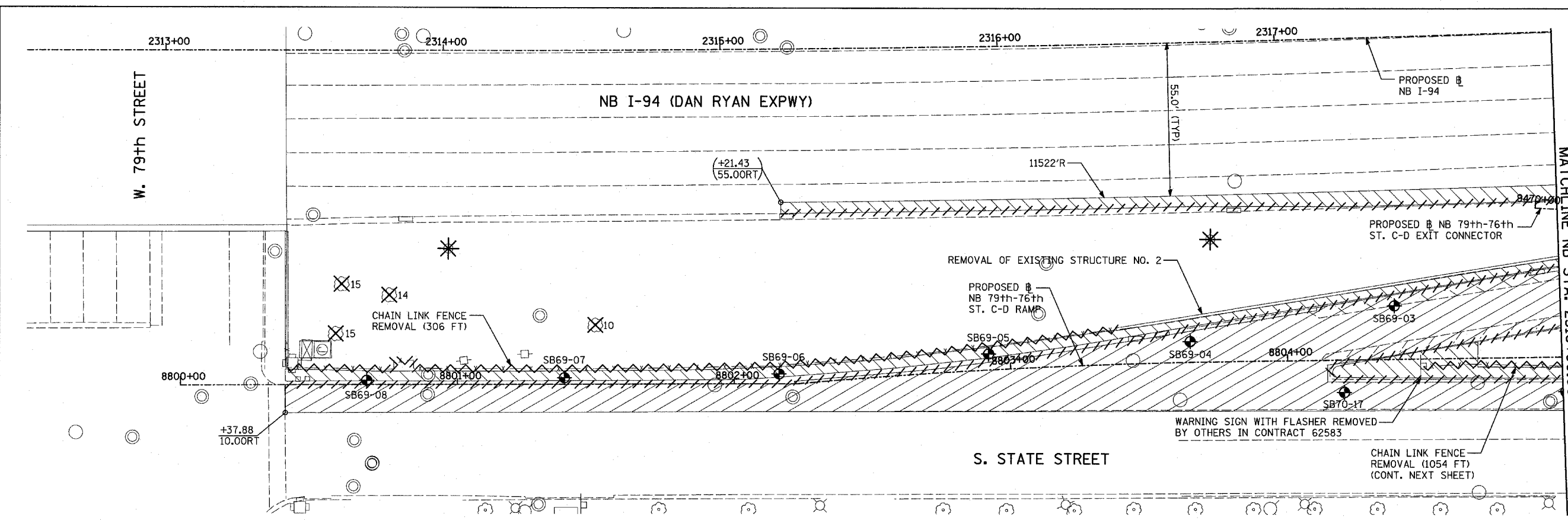

EXISTING CONDITIONS  
PROPOSED IMPROVEMENTS

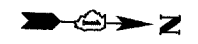
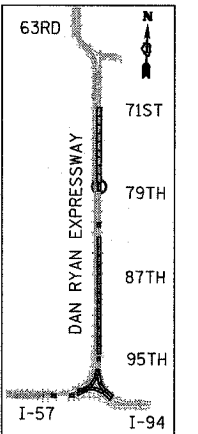
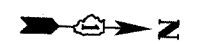
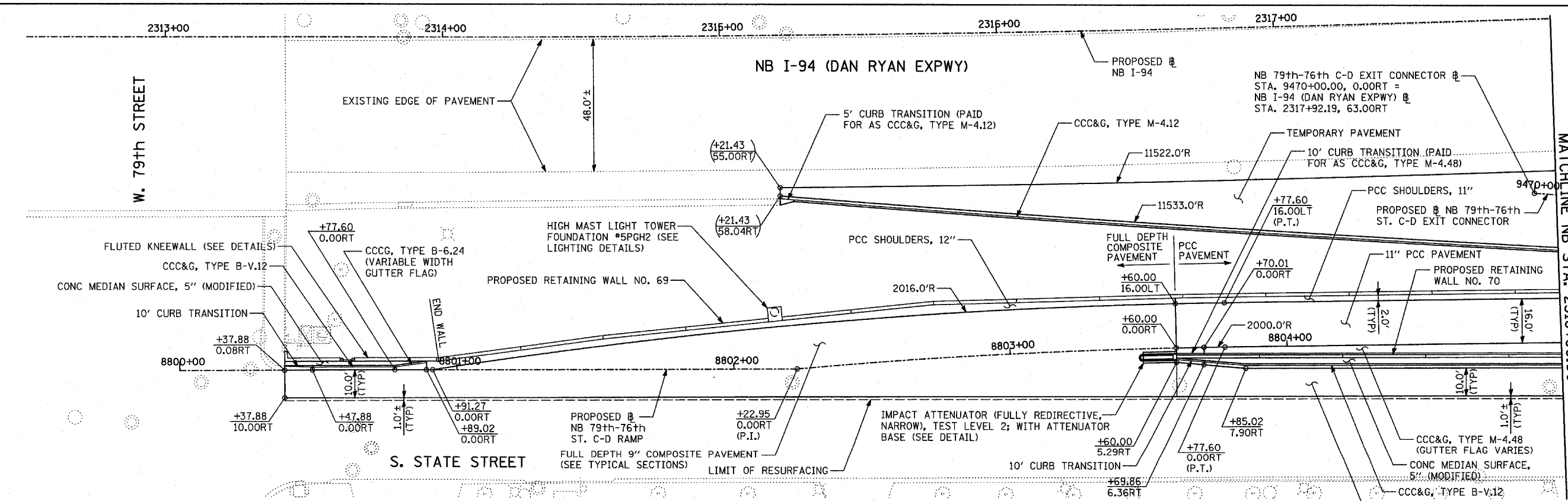

LOCATION MAP

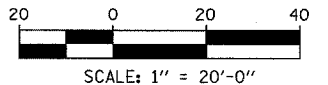

SHEET 23 OF 41

**LEGEND:**

	PAVEMENT REMOVAL		COMB CONC CURB & GUTTER REMOVAL		SOIL BORING LOCATIONS
	PAVED SHOULDER REMOVAL		CHAIN LINK FENCE REMOVAL		LIGHT POLE FOUNDATION REMOVAL (SEE EXISTING ELECTRICAL PLANS)
	PAVEMENT/SHOULDER REMOVAL, SPECIAL		CONCRETE BARRIER/GUARDRAIL REMOVAL		TREE REMOVAL (UNITS) (NO UNIT SHOWN = <6)

**NOTES:**

- ALL STATION/OFFSET/RADIUS CALLOUTS MEASURED TO EDGE OF PAVEMENT UNLESS OTHERWISE NOTED.
- EXACT LOCATIONS OF EXISTING PIERS/ABUTMENTS TO BE FIELD VERIFIED

REVISIONS	
NAME	DATE

ILLINOIS DEPARTMENT OF TRANSPORTATION  
F.A.I. 94 (DAN RYAN EXPRESSWAY)

EXISTING AND PROPOSED PLAN  
NB 79th TO 76th STREET C-D RAMP  
NB I-94 STA. 2313+43.22 TO 2318+00.00

SCALE: 1"=20'  
DATE: MARCH 18, 2005

DRAWN BY: MPG  
CHECKED BY: JPM

TYLIN INTERNATIONAL