

F.A.I. RTE.	SECTION	COUNTY	TOTAL SHEETS	SHEET NO.
94		COOK	860	134
STA. 2200+00.00 TO STA. 2362+00.00				
FED. ROAD DIST. NO. ILLINOIS		FED. AID PROJECT		
• (1516.1, 1717 & 1818) R-8		62694		

MATCHLINE NB I-94 STA. 2250+00.00 (PREV. SHEET)

MATCHLINE NB I-94 STA. 2265+00.00 (BELOW)

MATCHLINE NB I-94 STA. 2265+00.00 (ABOVE)

MATCHLINE NB I-94 STA. 2280+00.00 (NEXT SHEET)

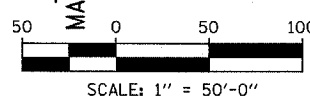
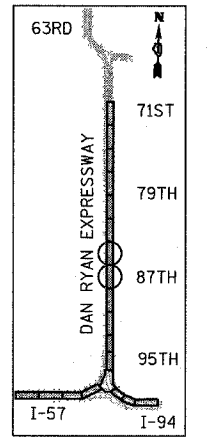
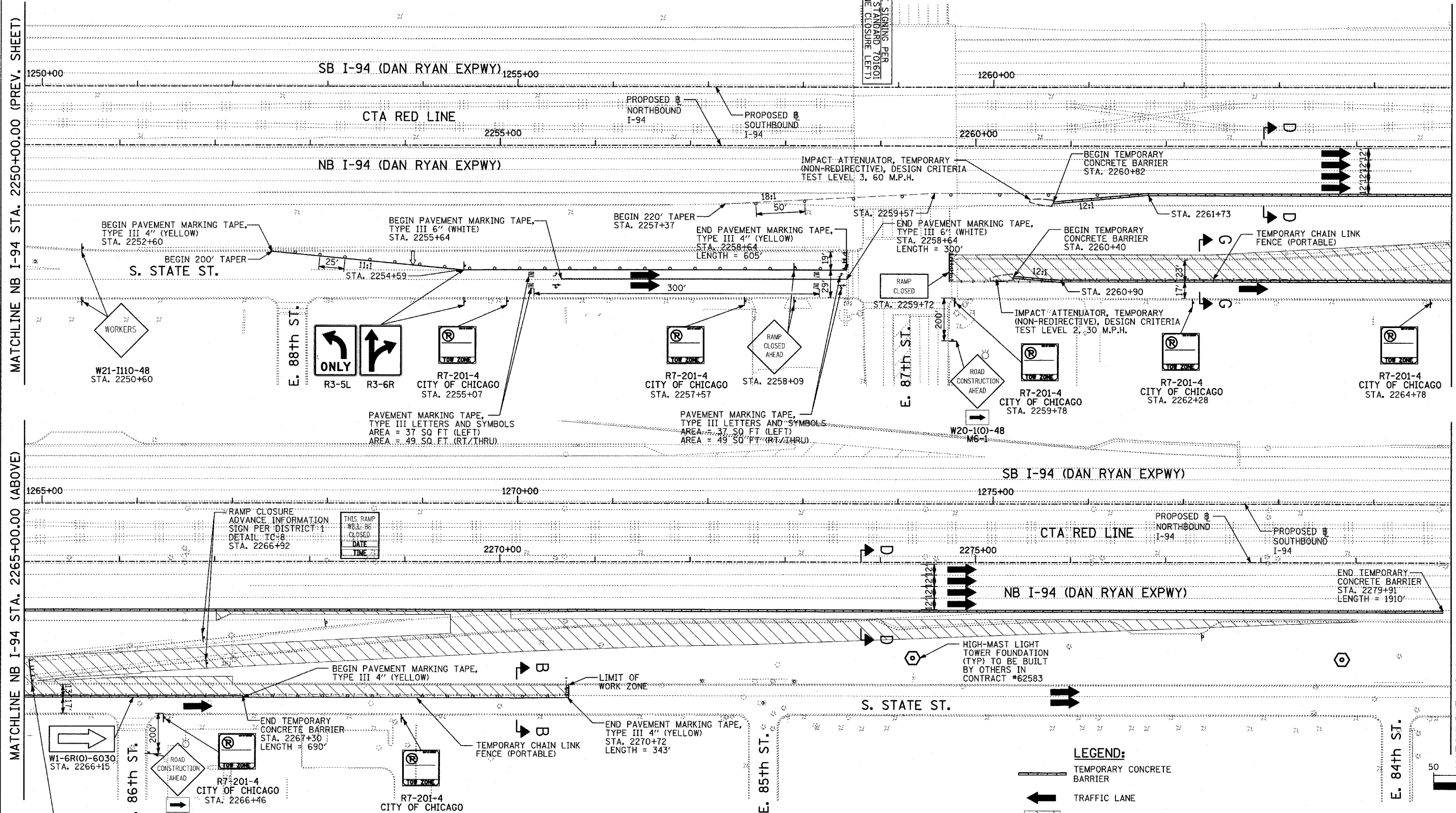

**LEGEND:**

- TEMPORARY CONCRETE BARRIER
- TRAFFIC LANE
- WORK ZONE
- BARRICADE, TYPE III
- DRUM WITH MONO-DIRECTIONAL STEADY BURNING LIGHT
- ARROW BOARD

REVISIONS	
NAME	DATE

ILLINOIS DEPARTMENT OF TRANSPORTATION  
**F.A.I. 94 (DAN RYAN EXPRESSWAY)**  
**MAINTENANCE OF TRAFFIC PLAN**  
**STAGE 1 - I-94**  
**NB I-94 STA. 2250+00.00 TO 2280+00.00**  
**SHEET 8 OF 11**

SCALE: 1"=50'-0" DRAWN BY: RTM  
DATE: MARCH 18, 2005 CHECKED BY: JPA

**TYLIN INTERNATIONAL**

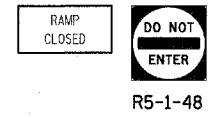

THE "RAMP CLOSED" AND "DO NOT ENTER" SIGNS ARE PER DISTRICT 1 DETAIL TC-8 STA. 2265+08

03/25/2005 11:41:47 AM