

F.A.I. RTE.	SECTION	COUNTY	TOTAL SHEETS	SHEET NO.
94	•	COOK	860	140
STA. 2200+00.00 TO STA. 2362+00.00		FED. ROAD DIST. NO. ILLINOIS FED. AID PROJECT		
		• (1516.1, 1717 & 1818) R-8		
				62694

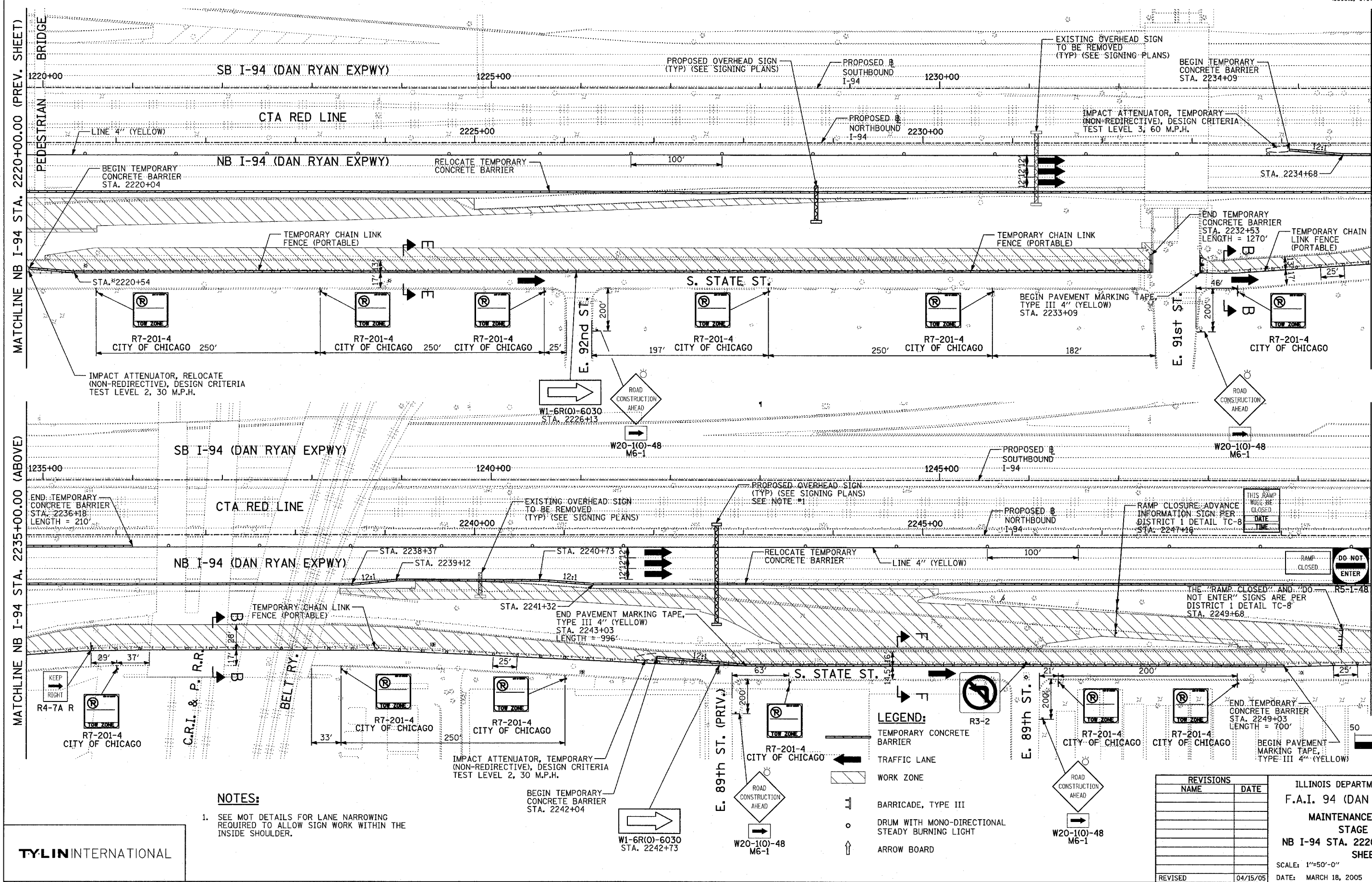

MATCHLINE NB I-94 STA. 2235+00.00 (BELOW)

MATCHLINE NB I-94 STA. 2250+00.00 (NEXT SHEET)

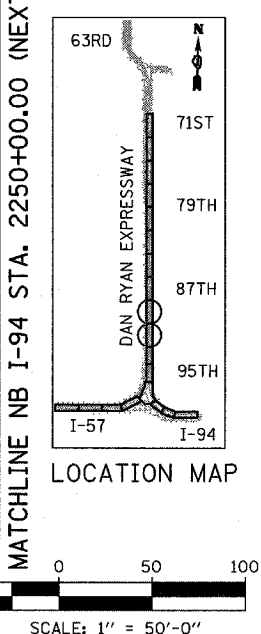

04/13/2005 03:59:54 PM