

F.A.I. RTE.	SECTION	COUNTY	TOTAL SHEETS	SHEET NO.
94		COOK	860	173
STA. 2200+00.00 TO STA. 2362+00.00				
FED. ROAD DIST. NO.		ILLINOIS	FED. AID PROJECT	
		• (1516.1, 1717 & 1818) R-8		62694

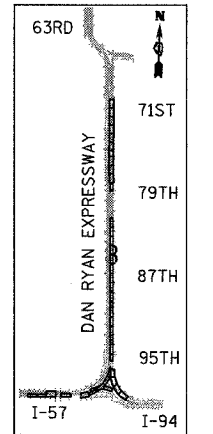
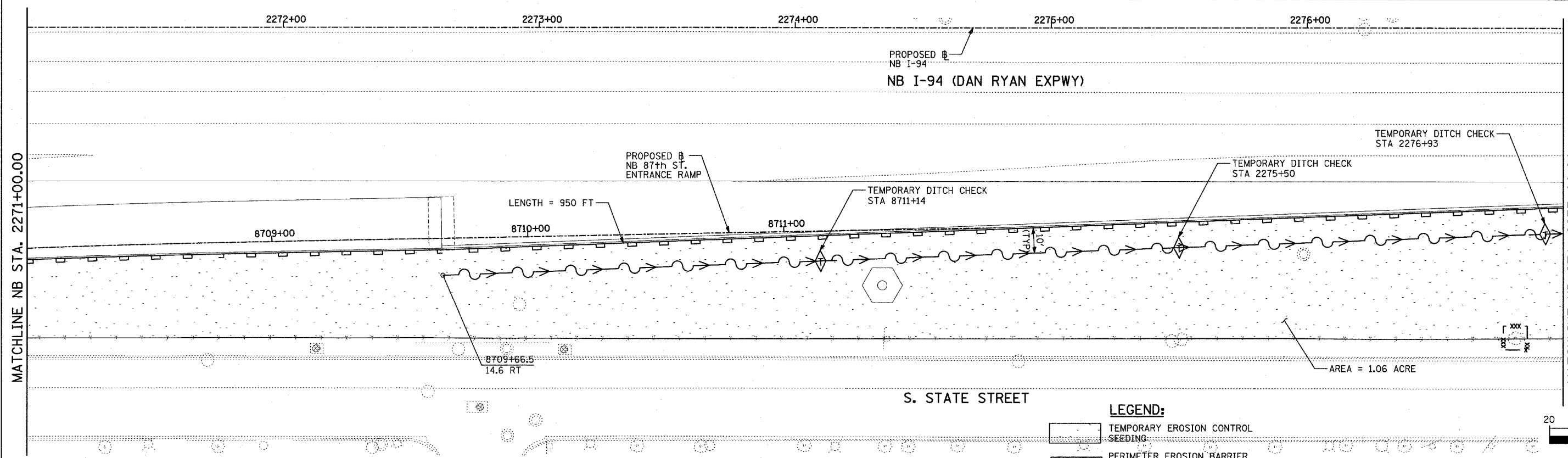
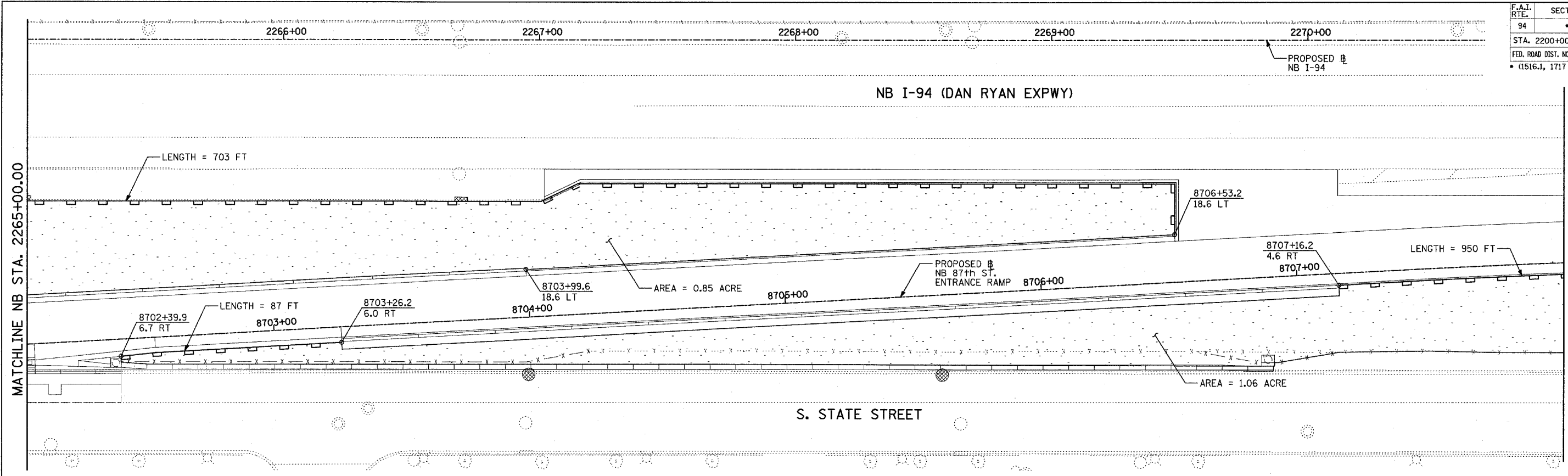

- LEGEND:**
- TEMPORARY EROSION CONTROL SEEDING
  - PERIMETER EROSION BARRIER
  - INLET FILTER, TO BE INSTALLED IN OFF PROJECT DRAINAGE STRUCTURES ACCEPTING STORMWATER RUNOFF
  - TEMPORARY FENCE
  - TEMPORARY DITCH
  - TEMPORARY DITCH CHECK
  - TEMPORARY FENCE FOR TREE PROTECTION (15 FEET PER SIDE = 60 FEET TOTAL)

REVISIONS	
NAME	DATE

ILLINOIS DEPARTMENT OF TRANSPORTATION  
F.A.I. 94 (DAN RYAN EXPRESSWAY)  
**EROSION CONTROL PLAN**  
NB 87th STREET ENTRANCE RAMP  
NB I-94 STA. 2265+00.00 TO 2277+00.00

SCALE: 1"=20'  
DATE: MARCH 18, 2005

DRAWN BY: JJS  
CHECKED BY: JPM, MAG

**TYLIN** INTERNATIONAL

NUMBER OF TREES TO BE PROTECTED THIS SHEET = 1

03/25/2005 09:33:07 PM