

F.A.I. RTE.	SECTION	COUNTY	TOTAL SHEETS	SHEET NO.
94		COOK	860	208
STA. 2200+00.00 TO STA. 2362+00.00		ILLINOIS FED. AID PROJECT		
FED. ROAD DIST. NO.		1516.1, 1717 & 1818 R-8		
				62694

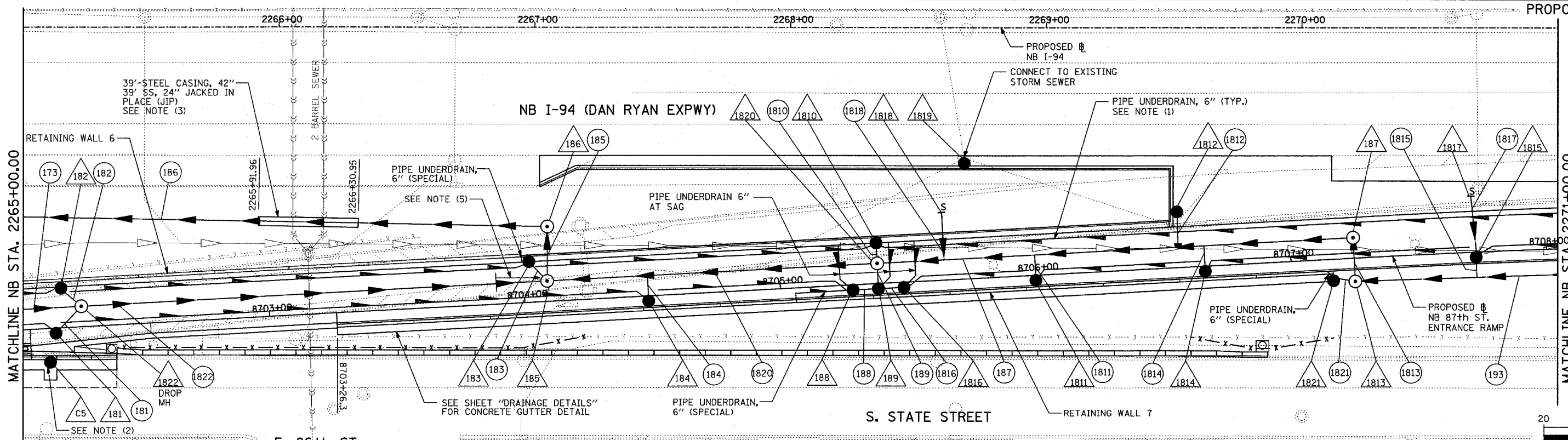

EXISTING CONDITIONS
PROPOSED IMPROVEMENTS

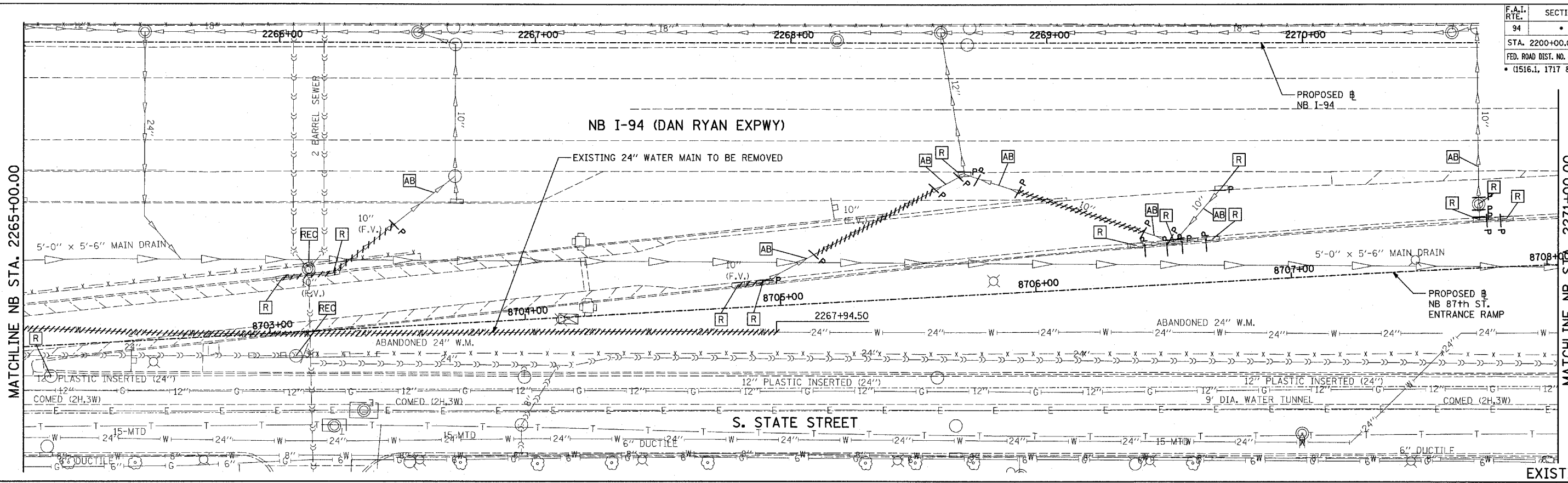
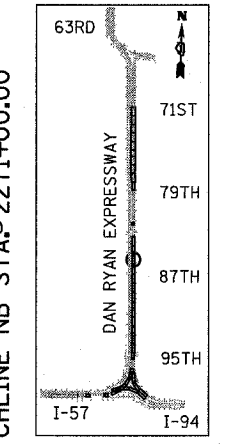

LOCATION MAP

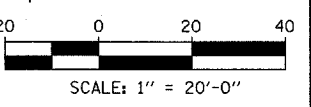

E. 86th ST. LEGEND:

- | | | | |
|--|--|--|---|
| | EXISTING COMBINED SEWER | | HIGH MAST LIGHT TOWER FOUNDATION (BY OTHERS - SEE CONTRACT 62583) |
| | PROPOSED STORM SEWER NUMBER (X=Sheet No., Y=PIPE NO.) | | HIGH MAST LIGHT TOWER FOUNDATION, WALL MOUNTED |
| | PROPOSED STRUCTURE NUMBER (X=Sheet No., Y=STRUCTURE NO.) | | HIGH MAST LIGHT TOWER FOUNDATION (BY OTHERS - SEE CONTRACT 62583) |
| | PIPE STUBOUT TO BE PLUGGED | | F.V. FIELD VERIFY |
| | UTILITY REMOVAL | | |
| | UTILITY REMOVAL PLUG | | |

NOTES:

- FOR CLARITY, PIPE UNDERDRAINS ARE SHOWN OFFSET FROM THEIR PROPOSED LOCATIONS. FOR DETAILED PLACEMENT, SEE SHEET "PIPE UNDERDRAINS ALONG RAMPS DETAIL."
- CONNECT TO EXISTING CDWM COMBINED SEWER. SEE COMBINED SEWER DRAINAGE SCHEDULE FOR DETAILS (TYP.).
- CARE SHALL BE TAKEN NOT TO DAMAGE EXISTING CDWM COMBINED SEWER. EXISTING SEWER TO BE VIDEO TAPED BEFORE AND AFTER CONSTRUCTION. ALL WORK SHALL BE COORDINATED WITH THE CITY OF CHICAGO.
- "FOR "POROUS GRANULAR EMBANKMENT, SUBGRADE" REQUIRED DURING SEWER INSTALLATION, SEE SCHEDULE OF QUANTITIES." PROPOSED QUANTITIES - SHEET 5.
- CONCRETE ENCASE SEWER 1822 FROM STA. 8703+89.12 TO STA. 8704+09.12 (+/- 20'). COST SHALL NOT BE PAID FOR SEPARATELY BUT SHALL BE INCLUDED IN SEWER PAY ITEM.

REVISIONS	
NAME	DATE

ILLINOIS DEPARTMENT OF TRANSPORTATION
F.A.I. 94 (DAN RYAN EXPRESSWAY)
DRAINAGE AND UTILITY PLANS
NB 87th STREET ENTRANCE RAMP
NB I-94 STA. 2265+00.00 TO 2271+00.00

SCALE: 1"=20'
DATE: MARCH 18, 2005
DRAWN BY: MB
CHECKED BY: DA