

F.A.I. RTE.	SECTION	COUNTY	TOTAL SHEETS	SHEET NO.
90/94	*	COOK	860	390
STA. 1269+00		TO STA. 1282+00		
FED. ROAD DIST. NO.	ILLINOIS	FED. AID PROJECT		
* (1516,1,1717 & 1818) R-8				62694

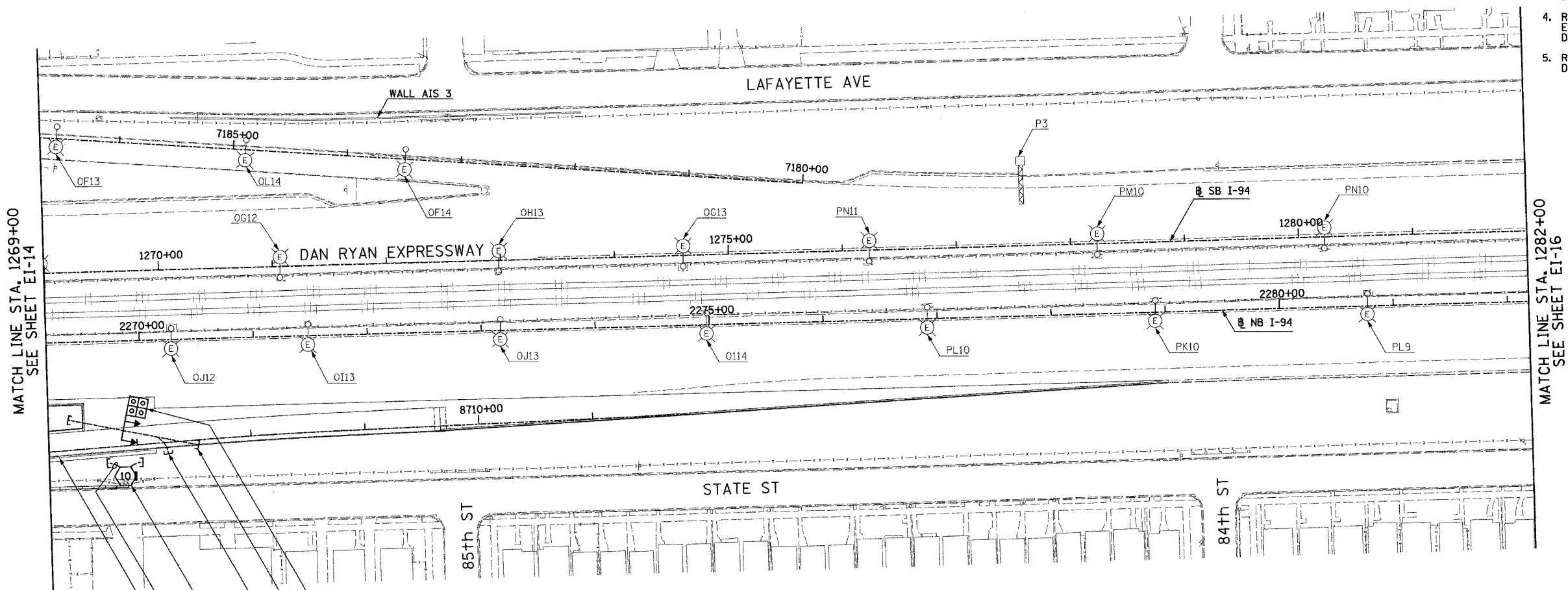

- NOTES:
- SEE DRAWINGS EI-100 AND EI-101 FOR ELECTRICAL SYMBOLS AND ABBREVIATIONS.
  - COORDINATE ALL WORK WITH IDOT CONTRACTS 62583 AND 62695.
  - UNLESS NOTED OTHERWISE, ALL ITEMS AND WORK SHOWN IN HEAVY LINE WEIGHT ON THIS DRAWING ARE PROPOSED NEW ITEMS AND WORK.
  - REFER TO STRUCTURAL DRAWINGS AND EI-104 FOR CONDUIT INSTALLATION DETAILS FOR LIGHT TOWER FOUNDATIONS
  - REFER TO SHEETS EI-102 AND ME-04 FOR DUCTBANK INSTALLATION DETAILS.



MATCH LINE STA. 1269+00  
SEE SHEET EI-14

MATCH LINE STA. 1282+00  
SEE SHEET EI-16

- (2)-4" PVC CONDUITS TYPICAL
- FOUNDATION FOR 5 PEF4 NOTE 4
- (3)-4" CNC AND (1)-3" CNC CONCRETE ENCASED, REINFORCED, (ITS) 80 LF, NOTE 5
- (3)-4" CNC CONCRETE ENCASED, 36 LF, NOTE 5
- 3" RGC CONCRETE ENCASED, 19 LF, NOTE 5

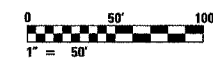

17A/EI-15

**SINGH** 300 W. ADAMS ST.  
CHICAGO, IL 60606  
SINGH & ASSOCIATES, INC. TEL: (312) 629-0240  
CONSULTING ENGINEERS FAX: (312) 629-8449

REVISIONS	
NAME	DATE
REVISOR	5/06/05

ILLINOIS DEPARTMENT OF TRANSPORTATION  
F.A.I. 90/94 (DAN RYAN EXPRESSWAY)

ELECTRICAL INFRASTRUCTURE PLANS  
PROPOSED IMPROVEMENTS

SCALE: 1"=50' DRAWN BY: VK  
DATE: MARCH 18, 2005 CHECKED BY: TM

5/5/2005 5:03:37 PM