

| | | | | |
|------------------------------------|---------|----------|------------------|-----------|
| F.A.I. RTE. | SECTION | COUNTY | TOTAL SHEETS | SHEET NO. |
| 94 | • | COOK | 860 | 456 |
| STA. 2200+00.00 TO STA. 2362+00.00 | | | | |
| FED. ROAD DIST. NO. | | ILLINOIS | FED. AID PROJECT | |
| (1516.1, 1717 & 1818) R-8 | | 62694 | | |

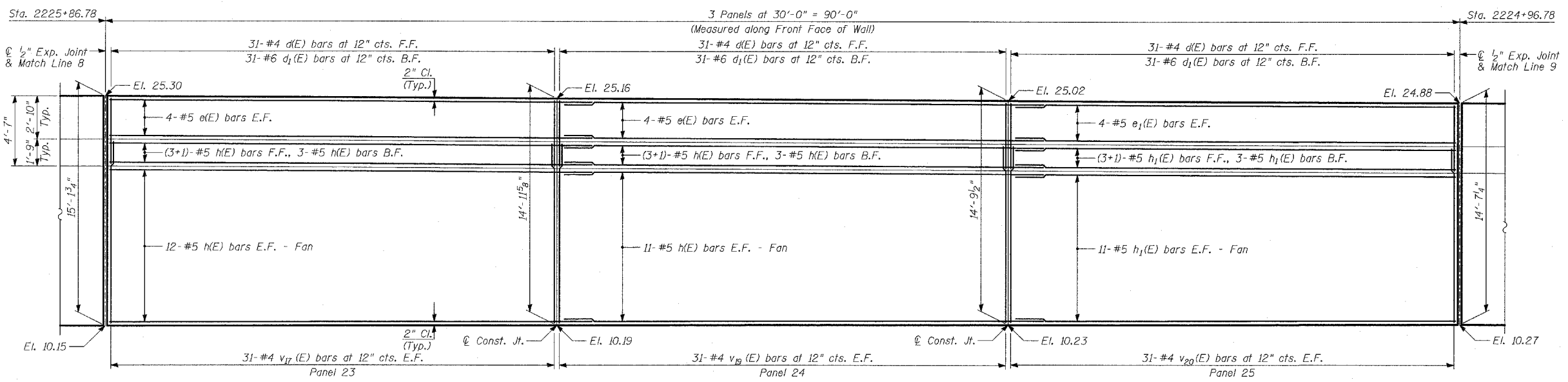

ELEVATION

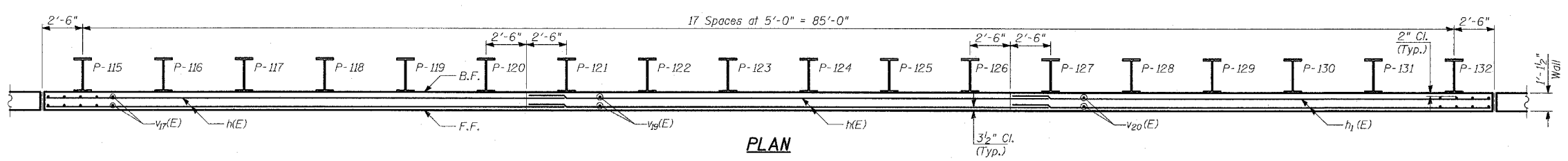

PLAN

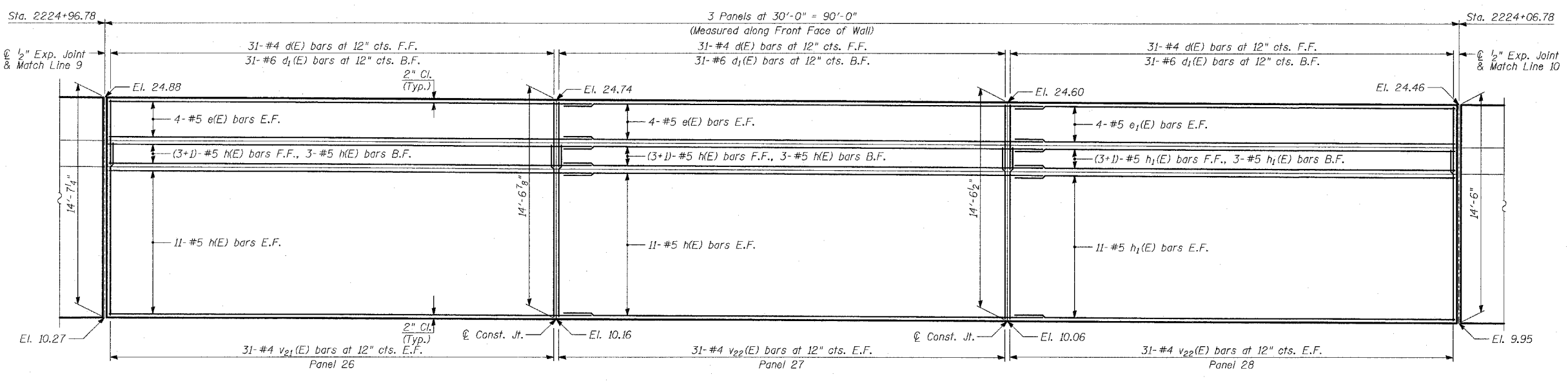

ELEVATION

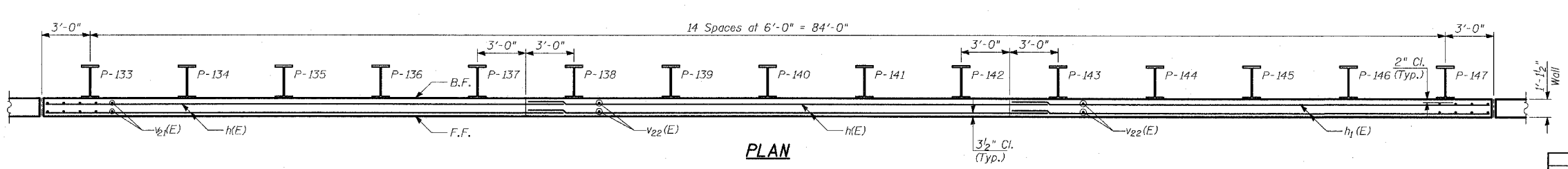

PLAN

- NOTES:**
1. B.F. - denotes Back Face.
 2. E.F. - denotes Each Face.
 3. F.F. - denotes Front Face.
 4. Work this Sheet with Sheets 11, 12 & 17 thru 20 of 33.
 5. File spacing measured along front face of wall.
 6. For Lap Splices, see Sheet 12 of 33.

| REVISIONS | |
|-----------|------|
| NAME | DATE |
| | |
| | |
| | |
| | |
| | |
| | |
| | |
| | |
| | |

ILLINOIS DEPARTMENT OF TRANSPORTATION
 F.A.I. 94 (DAN RYAN EXPRESSWAY)
 RETAINING WALL ALONG STATE ST.
 93RD ST. TO 91ST ST.
 WALL 2B - PLAN AND ELEVATION
 STA. 2225+86.78 TO STA. 2224+06.78
 S.N. 016-W961 DESIGNED BY: MI, DJR
 SCALE: N.T.S. DRAWN BY: DJR, MAF
 DATE: MARCH 18, 2005 CHECKED BY: TD, MI

TYLININTERNATIONAL

03/27/2005 02:27:45 PM