

WALL DETAIL AT FLUTED PARAPET

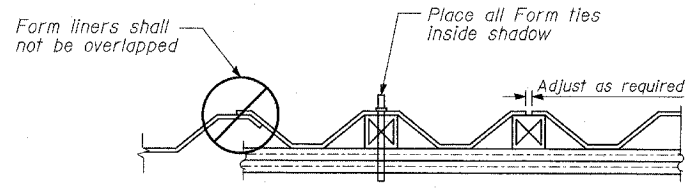

SUGGESTED FORMWORK DETAIL

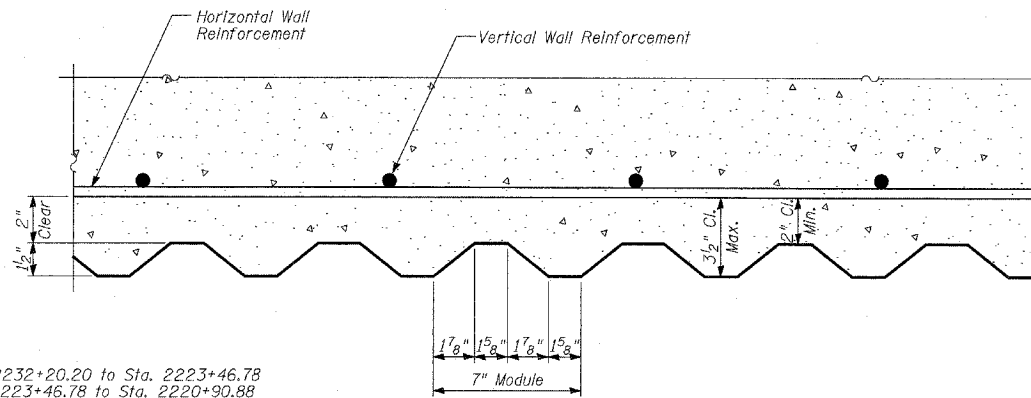

SECTION A-A

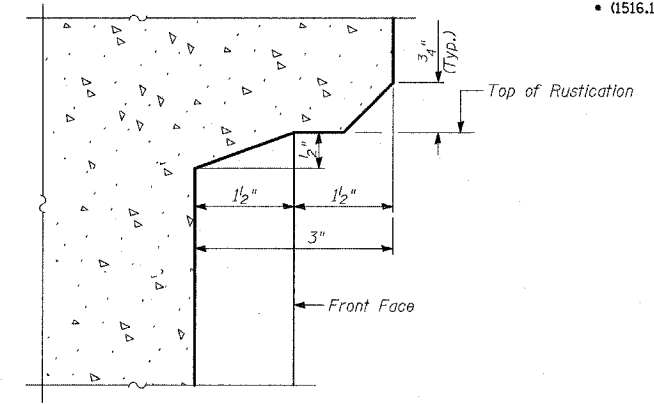

DETAIL A

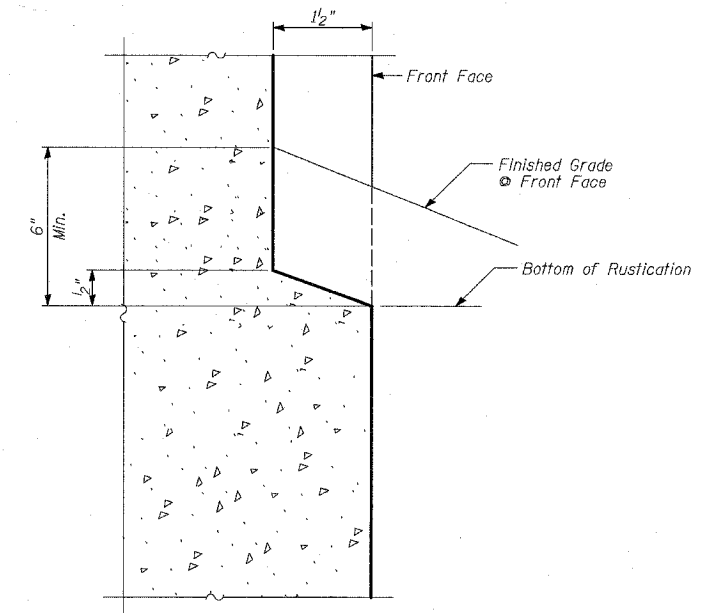

DETAIL B

* Contract 62304 Sta. 2232+20.20 to Sta. 2223+46.78
 Contract 62694 Sta. 2223+46.78 to Sta. 2220+90.88
 ** Contract 62694 Sta. 2232+20.20 to Sta. 2223+46.78

BILL OF MATERIAL

ITEM	UNIT	TOTAL
Rustication Finish	SQ FT	11,051

NOTES

1. See Sheet 18 of 33 for expansion and construction joint details.

LEGEND

HMLT - denotes High Mast Light Tower.

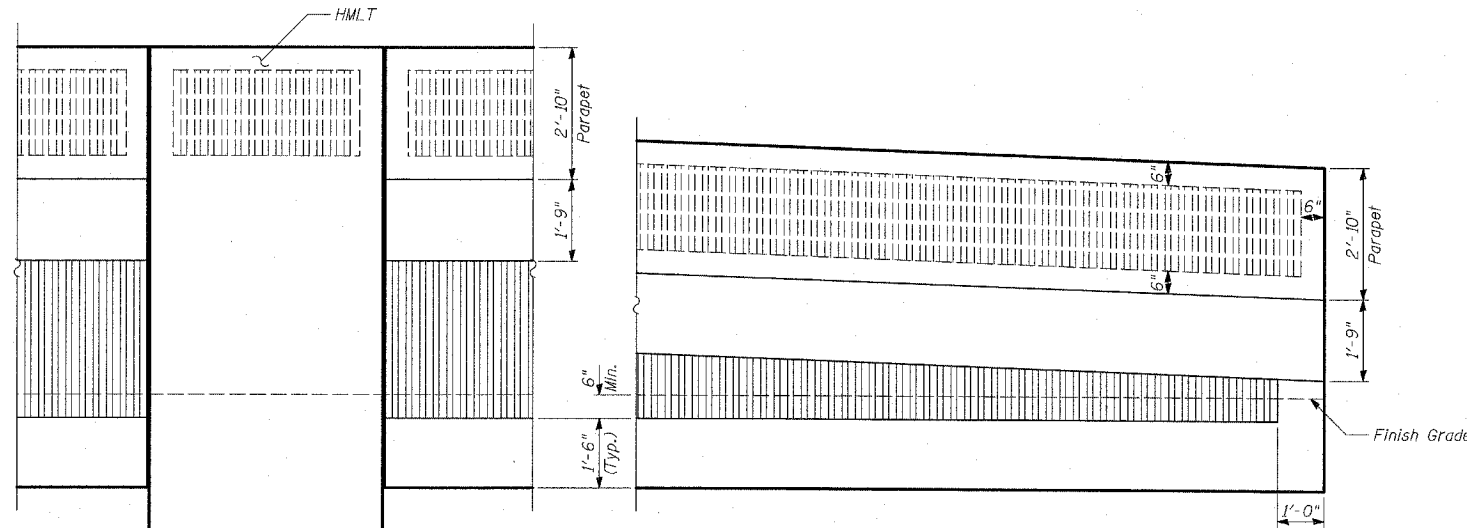

RUSTICATION DETAIL
(At HMLT with Embankment)

RUSTICATION DETAIL
(At End Panel with Embankment)

REVISIONS	
NAME	DATE

SHEET 19 OF 33

ILLINOIS DEPARTMENT OF TRANSPORTATION
F.A.I. 94 (DAN RYAN EXPRESSWAY)
RETAINING WALL ALONG STATE ST.
93RD ST. TO 91ST ST.
WALL 2B
RUSTICATION DETAILS

S.N. 016-W961 DESIGNED BY: MI, DJR
 SCALE: N.T.S. DRAWN BY: DJR, MAF
 DATE: MARCH 18, 2005 CHECKED BY: TD, MI