

F. & M. NO.	SECTION	COUNTY	TOTAL SHEETS	SHEET NO.
			860	737
STA.	TO STA.			
FED. ROAD DIST. NO.	ILLINOIS	FED. AID PROJECT		

62694

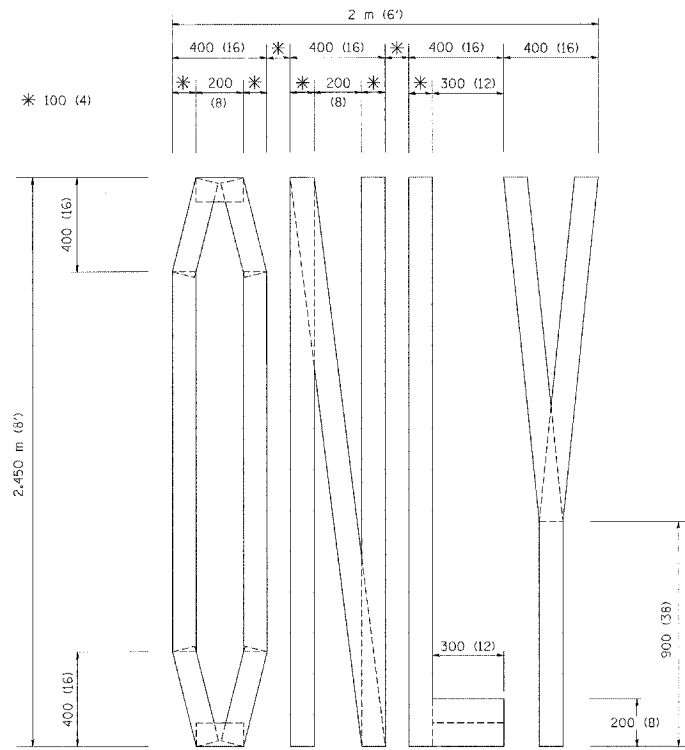

QUANTITY
 100 (4) LINE = 19.7 m (64.1 ft.)
 1.97 sq. m (21.1 sq. ft.)

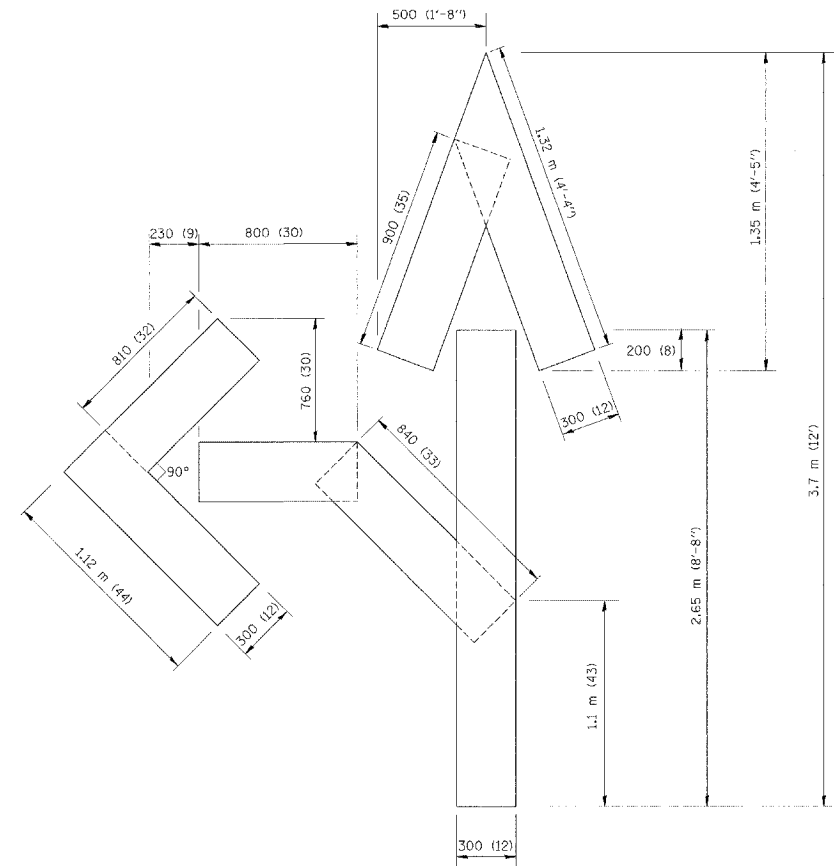

QUANTITY
 100 (4) LINE = 25.3 m (82.5 ft.)
 2.53 sq. m (27.5 sq. ft.)

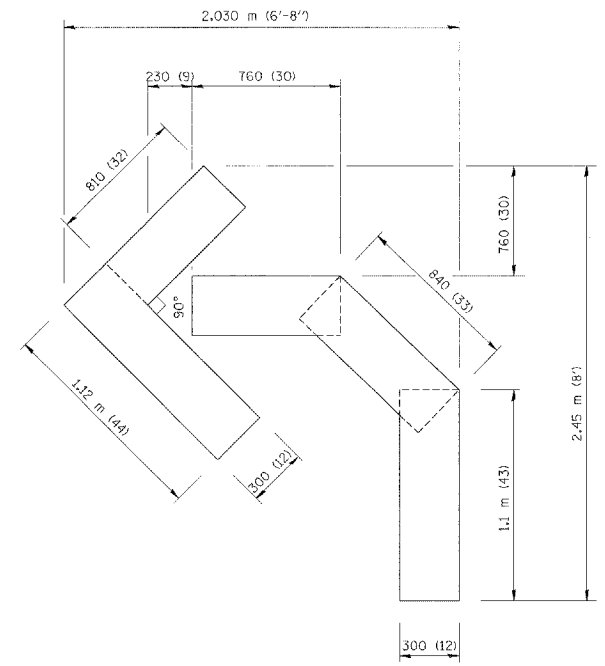

QUANTITY
 100 (4) LINE = 13.9 m (45.5 ft.)
 1.39 sq. m (15.2 sq. ft.)

All dimensions are in millimeters (inches) unless otherwise shown.

REVISIONS	
NAME	DATE
T. RAMMACHER	09/18/94
J. OBERLE	06/01/96
T. RAMMACHER	06/05/96
T. RAMMACHER	11/04/97
T. RAMMACHER	03/02/98
E. GOMEZ	08/28/00

ILLINOIS DEPARTMENT OF TRANSPORTATION
**PAVEMENT MARKING
 LETTERS AND SYMBOLS
 FOR TRAFFIC STAGING**
 SCALE: NONE
 DATE 10/18/2002
 DRAWN BY CADD
 CHECKED BY
 TC-16
 REVISION DATE: 08/28/00