

NOTE BOOK
NO. _____
DATE CHECKED _____
BY _____
STRUCTURE NOTATIONS CHECKED _____

F.A.I. RTE.	SECTION	COUNTY	TOTAL SHEETS	SHEET NO.
90/94	•	COOK	860	747
STA. 2200+00.00 TO STA. 2362+00.00		ILLINOIS FED. AID PROJECT		
• (1516.1, 1717 & 1818) R-8		62694		

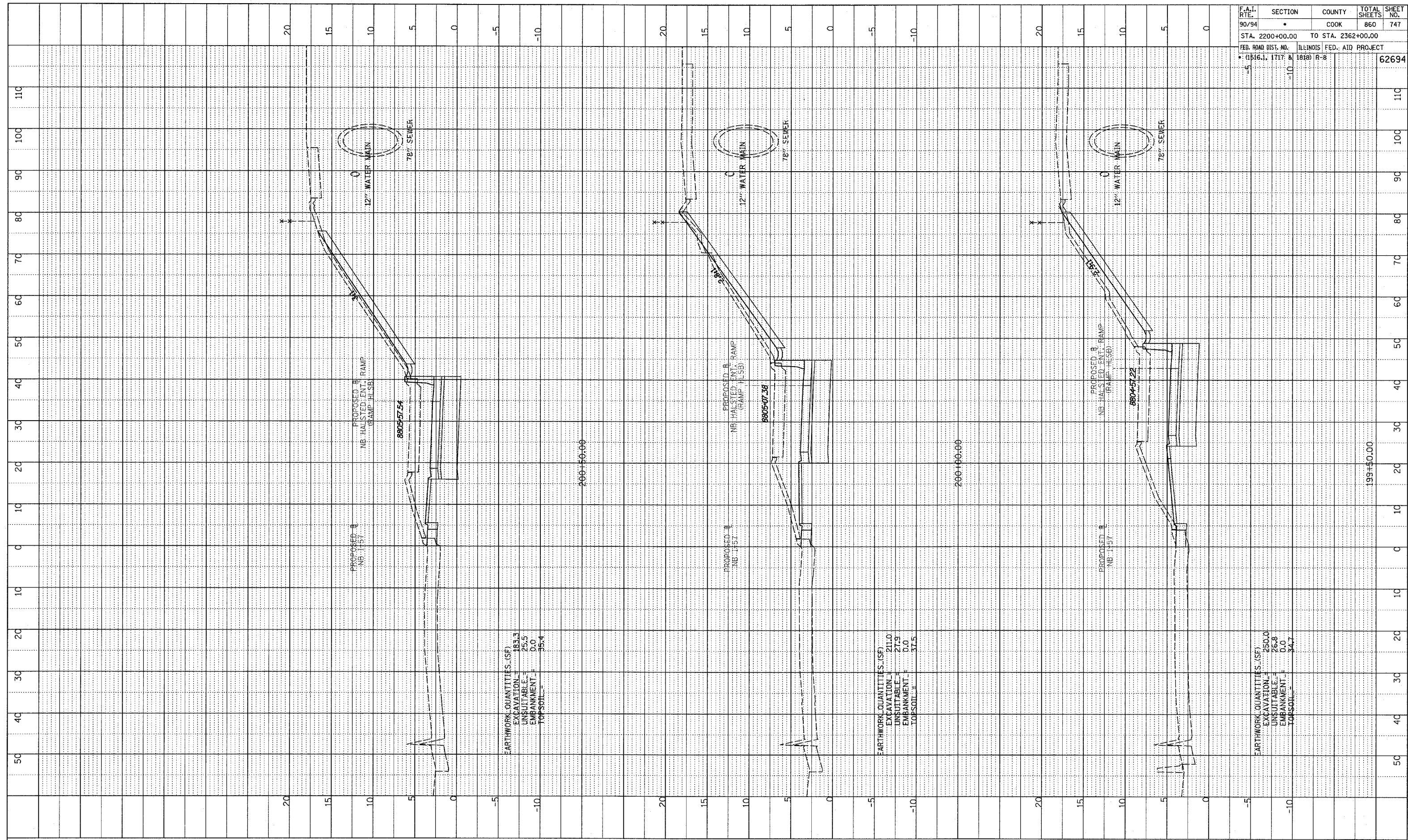

TYLINT INTERNATIONAL

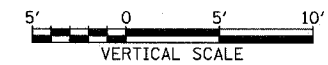

NB HALSTED ST. ENTRANCE RAMP
STA. 199+50 TO STA. 200+50

PLAN OF ST. 3 ROAD AND TANGENT TO SEWER