

PLOTTED  
 GRADES CHECKED  
 STRUCTURE NOTATION CPAD  
 NO.

F.A.I. RTE.	SECTION	COUNTY	TOTAL SHEETS	SHEET NO.
90/94		COOK	860	759
STA. 2200+00.00 TO STA. 2362+00.00		FED. ROAD DIST. NO. ILLINOIS FED. AID PROJECT		
		• (1516, 1, 1717 & 1818) R-8		
				62694

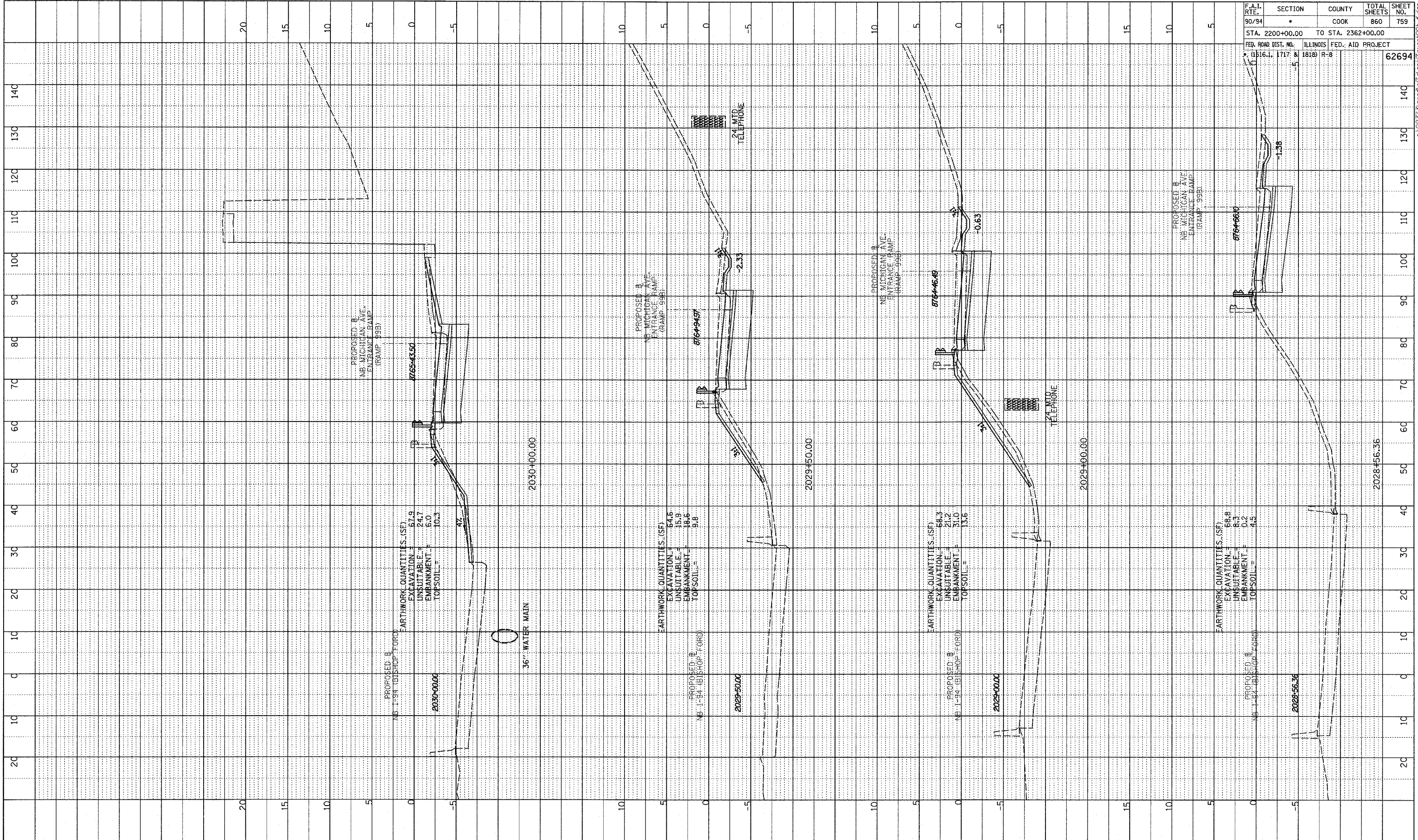

TYLIN INTERNATIONAL

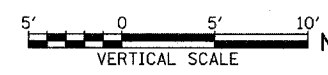
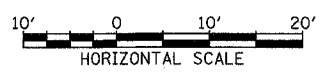

NB MICHIGAN AVE, ENTRANCE RAMP  
 STA. 2028+56 TO STA. 2030+00

P:\0237\3\road\cvt\eng\k\cross\99b\_7.dgn