

NOTE BOOK
 NO. _____
 PLANTED
 BANKS CHECKED
 STRUCTURE NOTARIS CPND

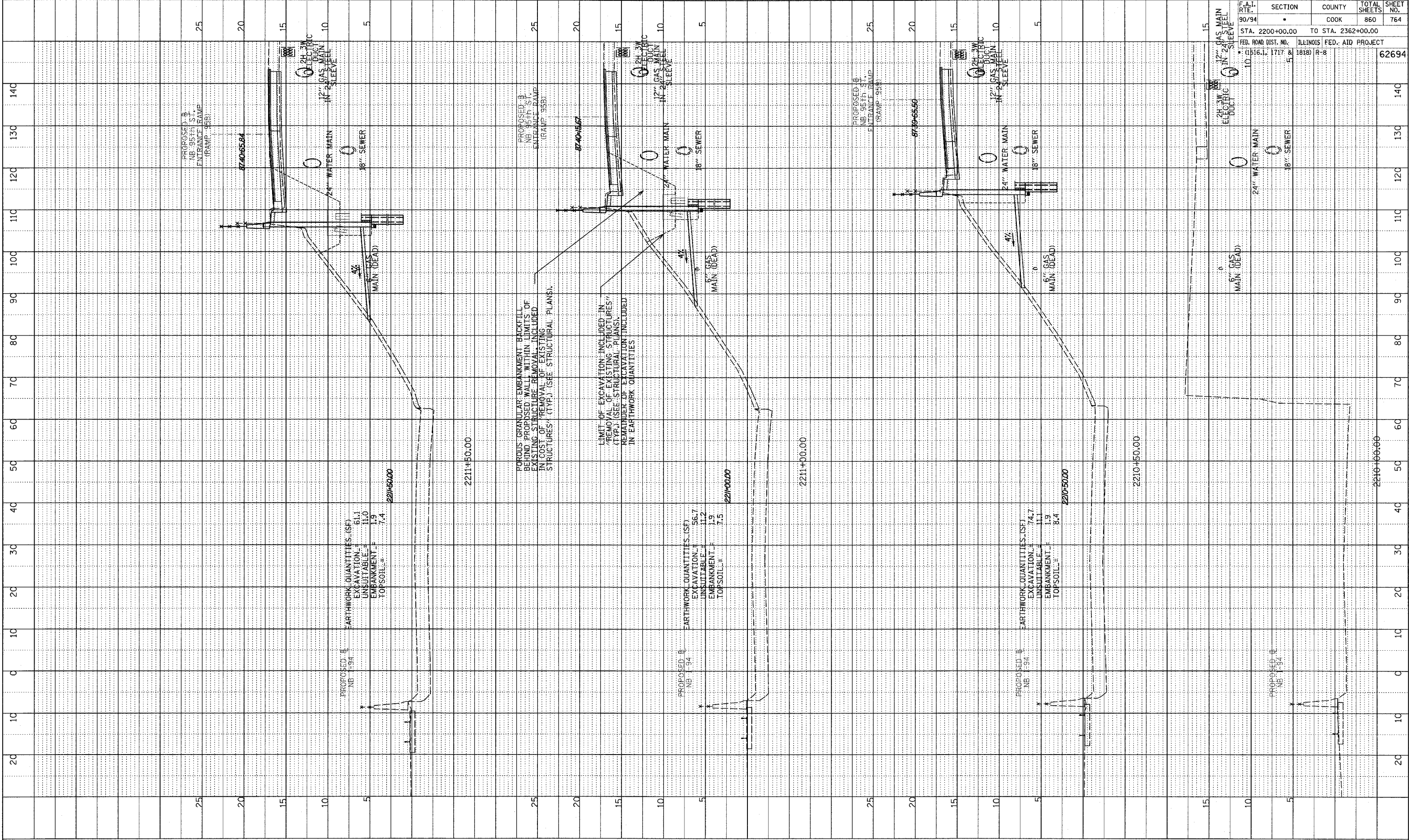

F.A.I. RTE.	SECTION	COUNTY	TOTAL SHEETS	SHEET NO.
90/94		COOK	860	764
STA. 2200+00.00 TO STA. 2362+00.00		ILLINOIS FED. AID PROJECT		
FED. ROAD DIST. NO. (1516.1, 1717 & 1818) R-8		62694		

TYLIN INTERNATIONAL

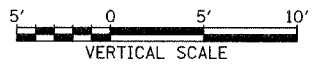

NB 95th ST. ENTRANCE RAMP
 STA. 2210+00 TO STA. 2211+50

pa-02373.yroadnct\gagok\T\axss\95b_1.dgn