

PLOTTED
BY: J. W. BEECHER
DATE: 11/11/03
STRUCTURE: NOTATION: CP10

F.A.I. SITE	SECTION	COUNTY	TOTAL SHEETS	SHEET NO.
90/94		COOK	860	769
STA. 2200+00.00 TO STA. 2362+00.00		ILLINOIS FED. AID PROJECT		
FED. ROAD DIST. NO. (1516.1, 1717 & 1818) R-8		62694		

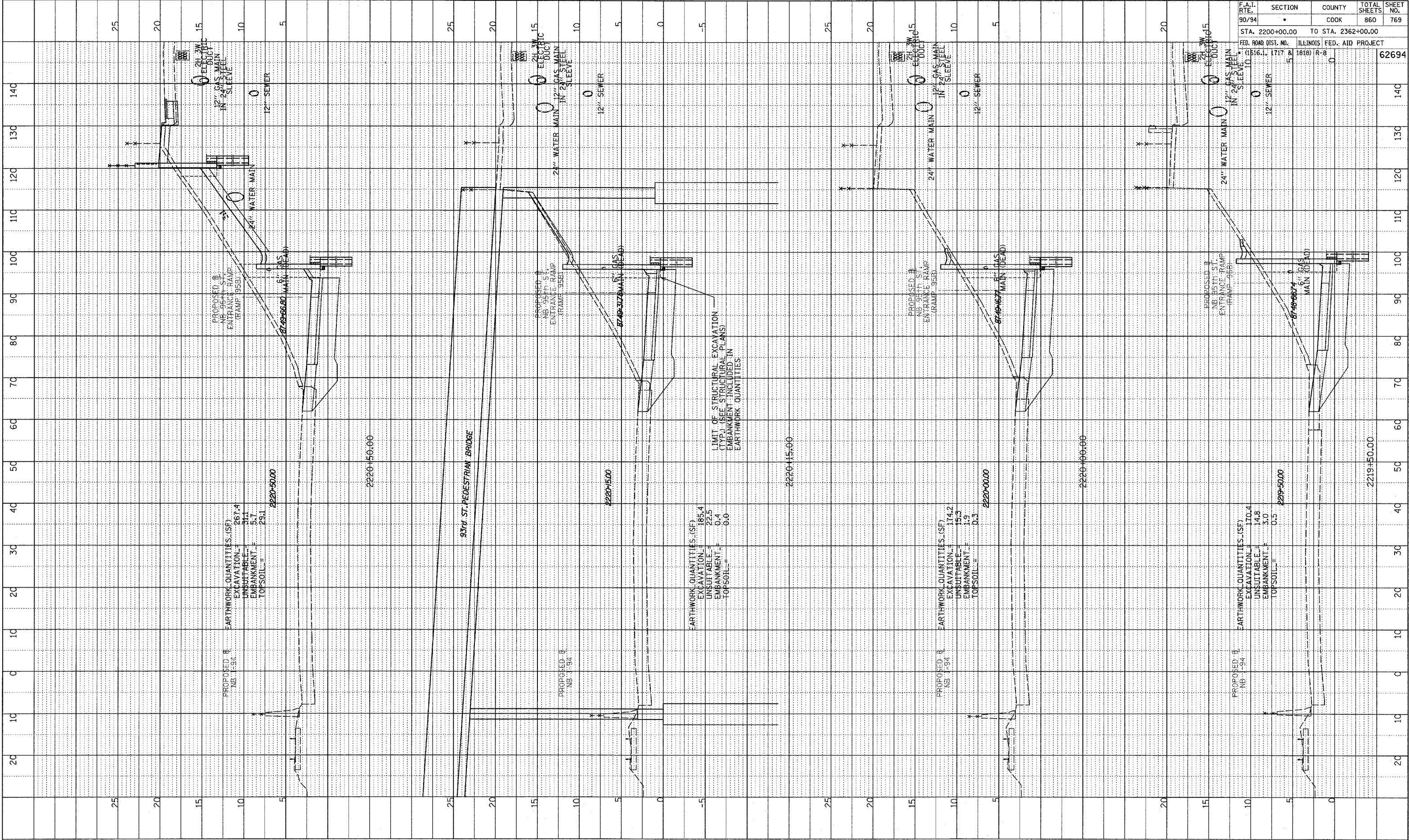

TYLIN INTERNATIONAL

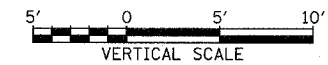
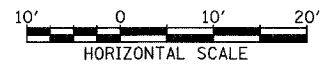

NB 95th ST. ENTRANCE RAMP
STA. 2219+50 TO STA. 2220+50

P:\02-31\road\cag\k\cass\95b.f.dwg