

NOTE BOOK  
 GRADES CHECKED  
 ELEM. NOTED  
 ELEM. DATE NOTED (MS. DRW.)  
 NO.

REVISED 05/06/05

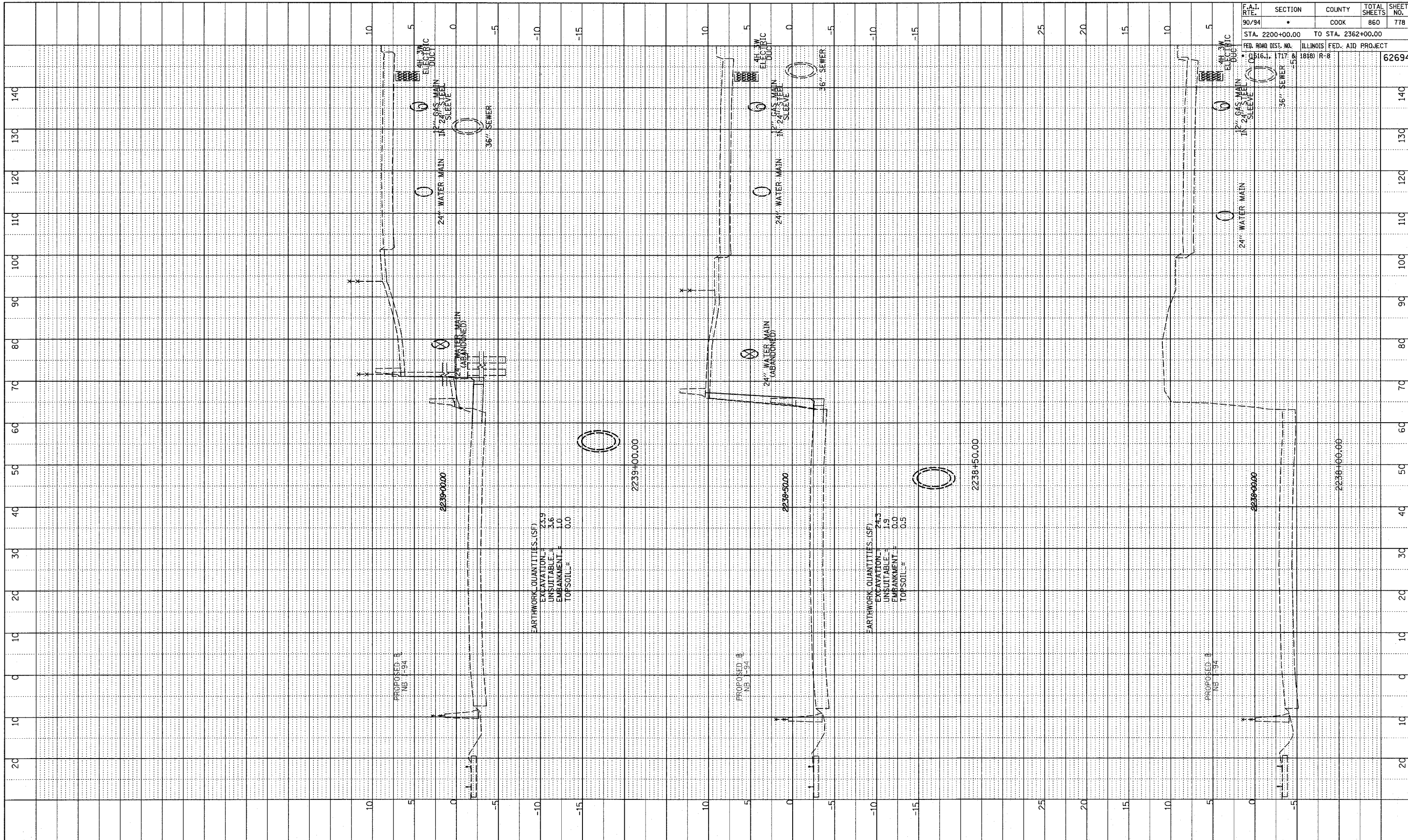

F.A.I. RTE.	SECTION	COUNTY	TOTAL SHEETS	SHEET NO.
90/94	•	COOK	860	778
STA. 2200+00.00		TO STA. 2362+00.00		
FED. ROAD DIST. NO.		ILLINOIS FED. AID PROJECT		
• 0616.1, 1717 & 1818		R-8		62694

EARTHWORK QUANTITIES (SF)  
 EXCAVATION = 23.9  
 UNSUITABLE = 3.6  
 EMBANKMENT = 1.0  
 TOPSOIL = 0.0

EARTHWORK QUANTITIES (SF)  
 EXCAVATION = 24.3  
 UNSUITABLE = 1.9  
 EMBANKMENT = 0.0  
 TOPSOIL = 0.5

TYLIN INTERNATIONAL

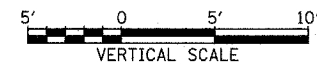
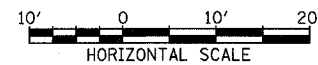

NB 87th ST. EXIT RAMP  
 STA. 2238+00 TO STA. 2239+00

P:\02373\Road\07\agk\7\axis\87C-F.dgn