

NOTED
 PLANNED
 STRUCTURE NOTATIONS CHNO

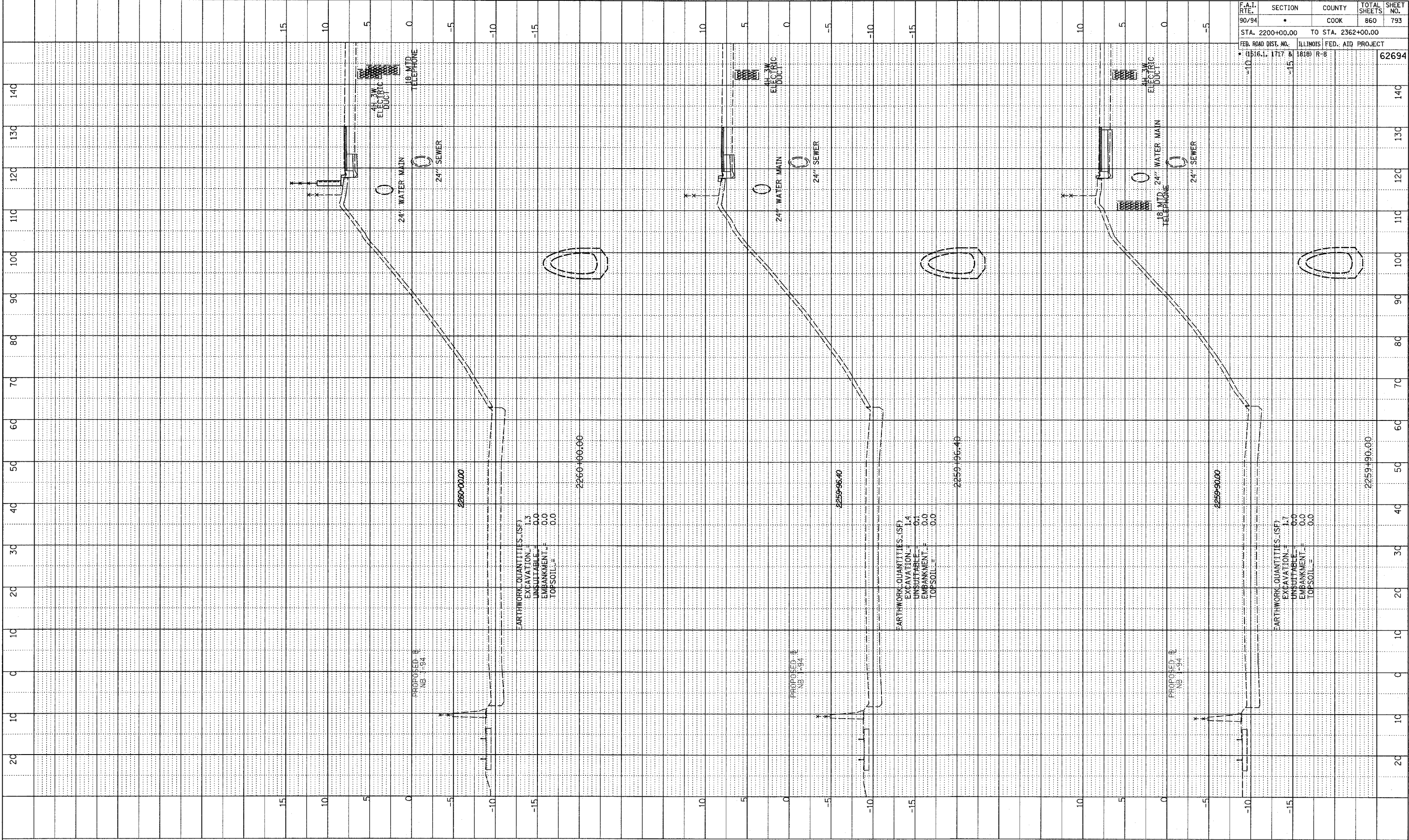

F.A.T. RTE.	SECTION	COUNTY	TOTAL SHEETS	SHEET NO.
90/94		COOK	860	793
STA. 2200+00.00 TO STA. 2362+00.00				
FED. ROAD DIST. NO.		ILLINOIS FED. AID PROJECT		
(1516.1, 1717 & 1818) R-8				62694

TYLIN INTERNATIONAL

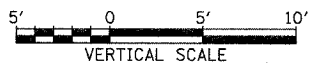
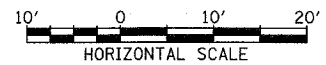

NB 87th ST. ENTRANCE RAMP
 STA. 2259+90 TO STA. 2260+00

PA02373 road.ctb/agk/raas/b.f.dgn