

NOTE BOOK  
 NO. \_\_\_\_\_  
 PLOTTED, CHECKED  
 BY \_\_\_\_\_  
 STRUCTURE NOTATION: CIPD

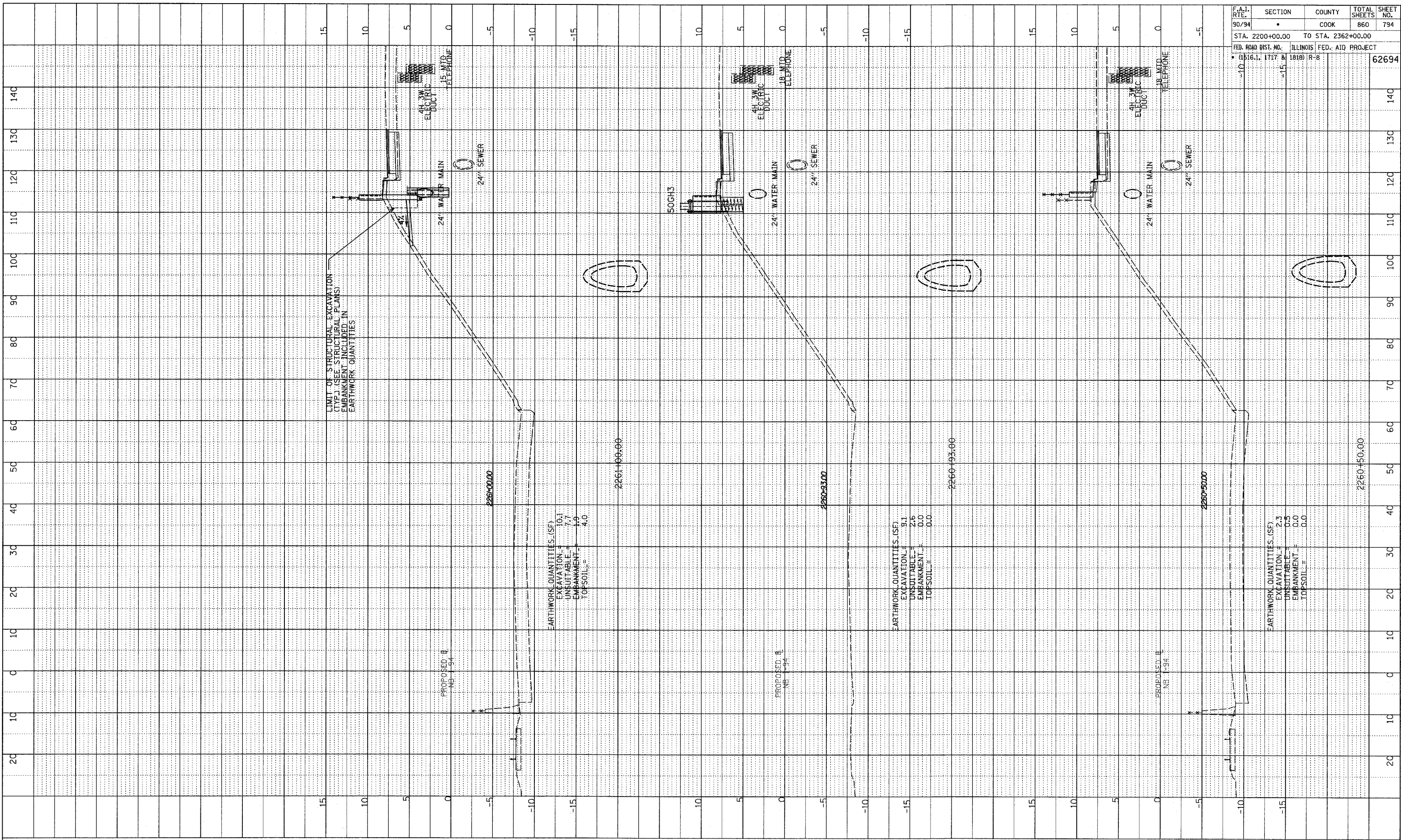

F.A.I. RTE.	SECTION	COUNTY	TOTAL SHEETS	SHEET NO.
90/94		COOK	860	794
STA. 2200+00.00 TO STA. 2362+00.00				
FED. ROAD DIST. NO. ILLINOIS FED. AID PROJECT				
• (1516.1, 1717 & 1818) R-8				
				62694

TYLIN INTERNATIONAL

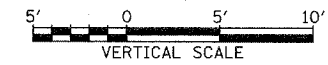

NB 87th ST. ENTRANCE RAMP  
 STA. 2260+50 TO STA. 2261+00

B:\0231\road\01\gpk\Tass87b.dgn