

NOTE BOOK
 GRADES CHECKED
 STRUCTURE NOTATIONS OK'D
 NO. _____
 REVISED 05/06/05

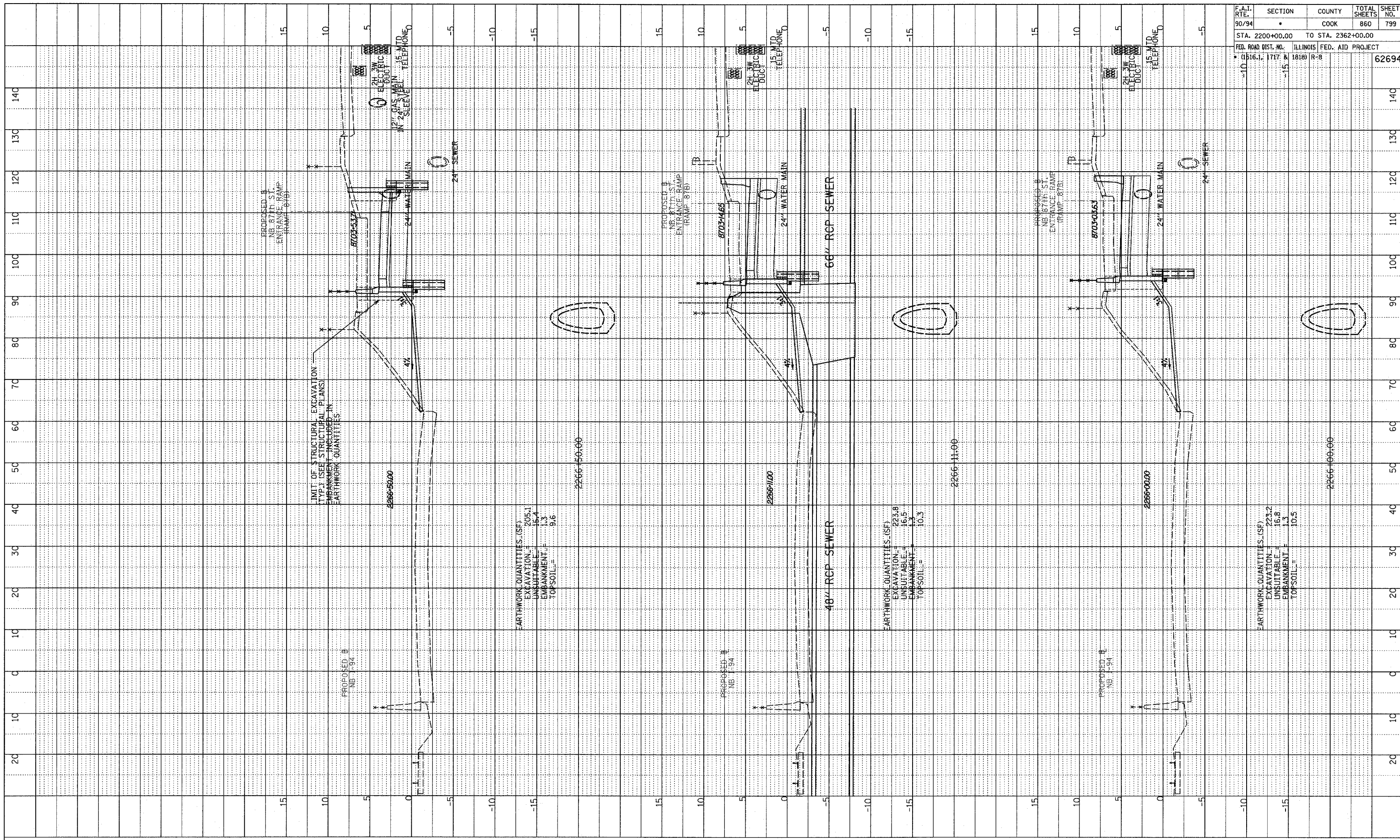

EARTHWORK QUANTITIES (SF)
 EXCAVATION = 205.1
 UNSUITABLE = 45.4
 EMBANKMENT = 1.3
 TOPSOIL = 9.6

EARTHWORK QUANTITIES (SF)
 EXCAVATION = 223.8
 UNSUITABLE = 46.5
 EMBANKMENT = 1.3
 TOPSOIL = 10.3

EARTHWORK QUANTITIES (SF)
 EXCAVATION = 223.2
 UNSUITABLE = 46.8
 EMBANKMENT = 1.3
 TOPSOIL = 10.5

F.A.I. RTE.	SECTION	COUNTY	TOTAL SHEETS	SHEET NO.
90/94	*	COOK	860	799
STA. 2200+00.00		TO STA. 2362+00.00		
FED. ROAD DIST. NO. (1516.1, 1717 & 1818) R-8		ILLINOIS FED. AID PROJECT		62694

TYLIN INTERNATIONAL

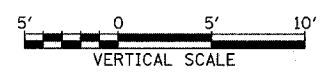
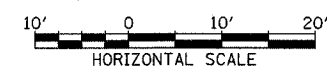

NB 87th ST. ENTRANCE RAMP
 STA. 2266+00 TO STA. 2266+50

P:\02375\Road\07\dwg\sk17\assst87B_F.dgn