

PLOTTED
 DATE: 11/11/94
 BY: J. J. [unreadable]
 NO. [unreadable]
 STRUCTURE NOTATION: CPKO

F.A.I. RTE.	SECTION	COUNTY	TOTAL SHEETS	SHEET NO.
90/94		COOK	860	804
STA. 2200+00.00 TO STA. 2362+00.00				
FED. ROAD DIST. NO. ILLINOIS		FED. AID PROJECT		
• (1516.1, 1717 & 1818) R-8		62694		

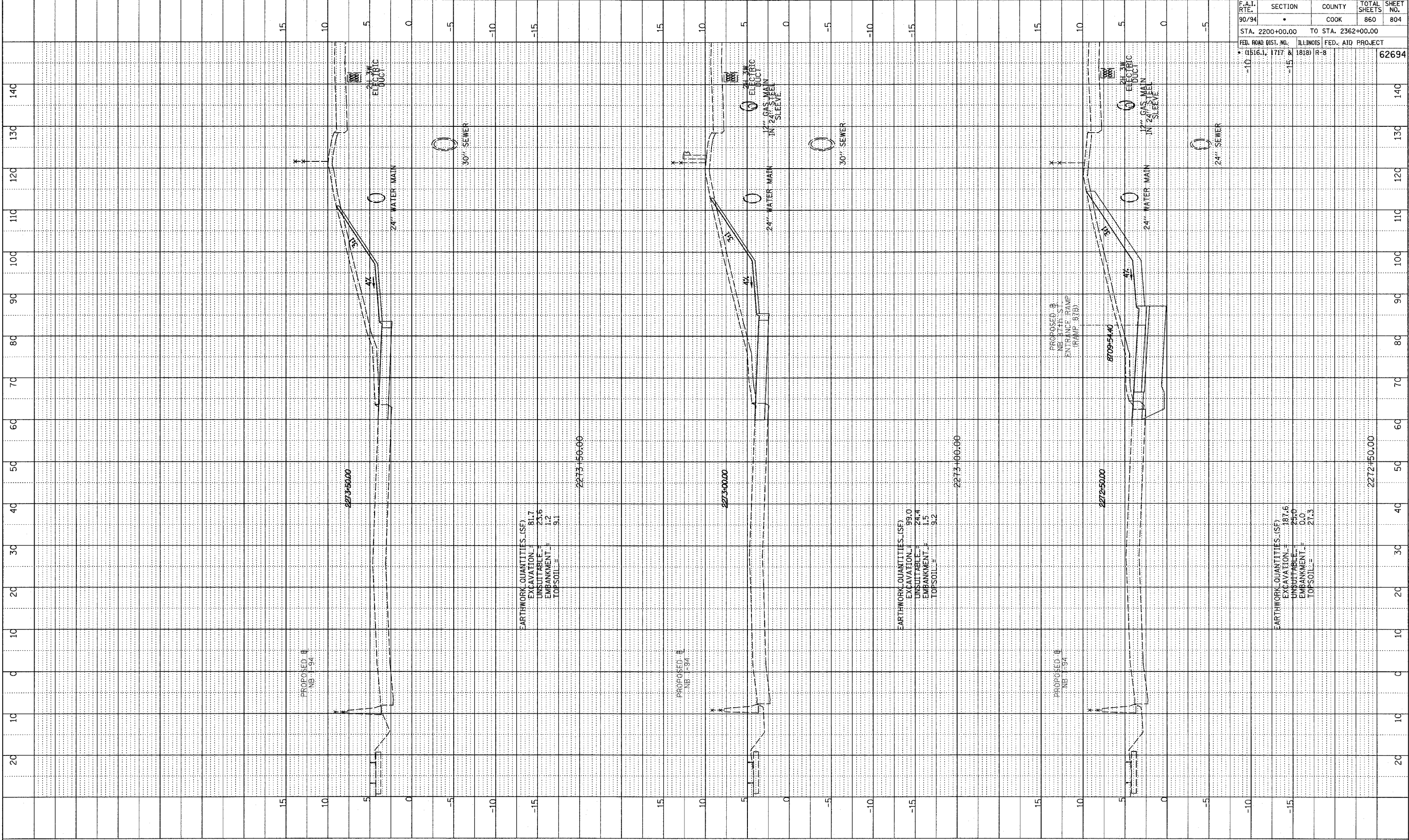

TYLIN INTERNATIONAL

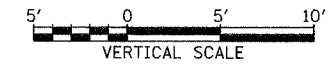

NB 87th ST. ENTRANCE RAMP
 STA. 2272+50 TO STA. 2273+50

Pa:02373road07tagok17ass87b_1.dgn