

NOTE BOOK NO. \_\_\_\_\_  
 DRAWING CHECKED BY \_\_\_\_\_  
 STRUCTURE NOTATIONS CHKD BY \_\_\_\_\_

F.A.I. RTE. 90/94	SECTION	COUNTY COOK	TOTAL SHEETS 860	SHEET NO. 806
STA. 2200+00.00 TO STA. 2362+00.00		ILLINOIS FED. AID PROJECT		
FED. ROAD DIST. NO. (1516.1, 1717 & 1818) R-8		62694		

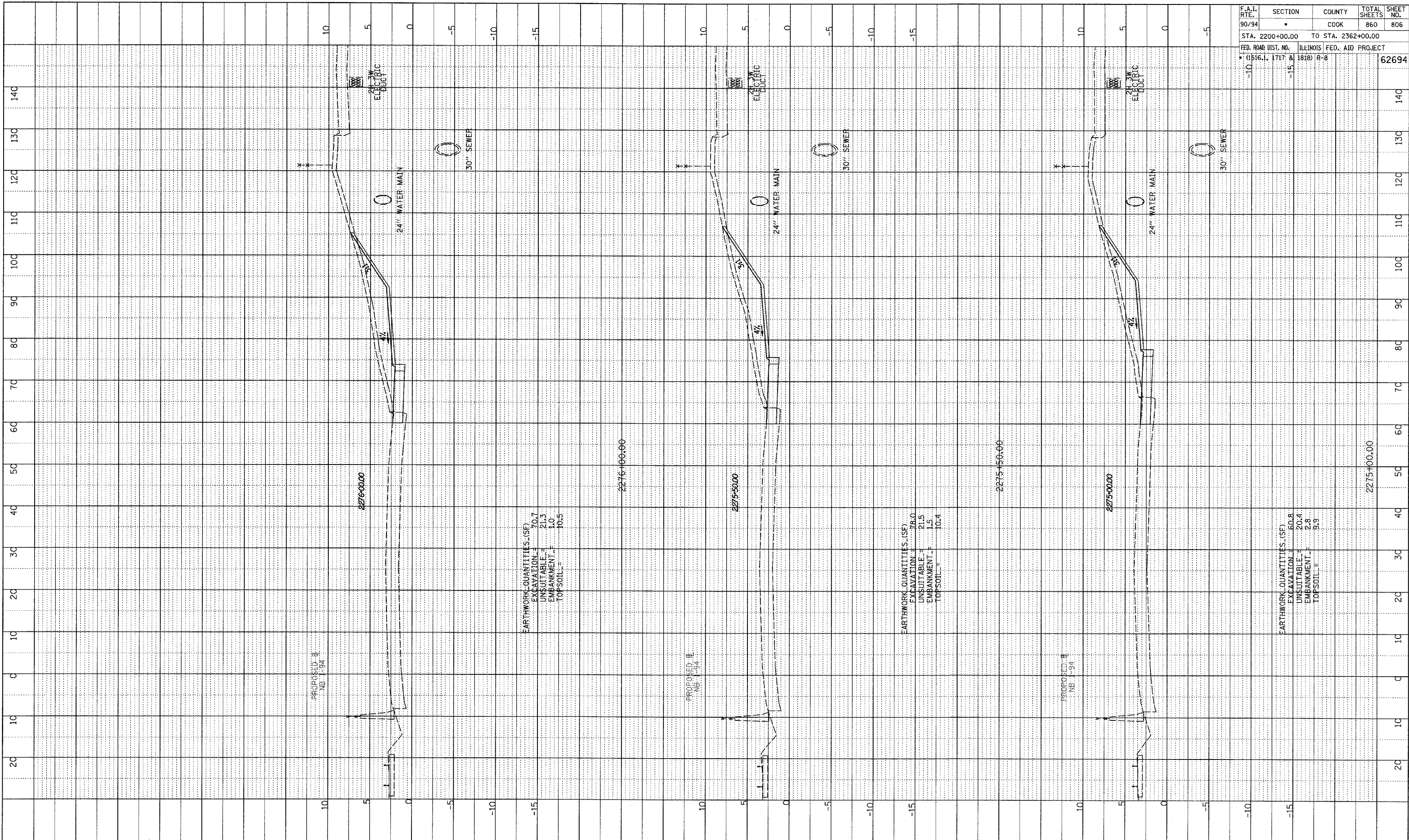

EARTHWORK QUANTITIES (SF)  
 EXCAVATION = 70.7  
 UNSUITABLE = 21.3  
 EMBANKMENT = 1.0  
 TOPSOIL = 10.5

EARTHWORK QUANTITIES (SF)  
 EXCAVATION = 76.0  
 UNSUITABLE = 21.5  
 EMBANKMENT = 1.5  
 TOPSOIL = 10.4

EARTHWORK QUANTITIES (SF)  
 EXCAVATION = 60.8  
 UNSUITABLE = 20.4  
 EMBANKMENT = 2.8  
 TOPSOIL = 8.9

TYLIN INTERNATIONAL

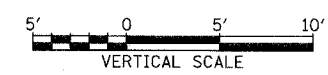
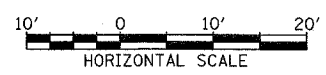

NB 87th ST. ENTRANCE RAMP  
 STA. 2275+00 TO STA. 2276+00

D:\02373\road\27\gpk\Tass\87b.dgn