

PLOTTED
 CHECKED
 NO. _____
 STRUCTURE NOTATIONS OK'D

F.A.I. RTE.	SECTION	COUNTY	TOTAL SHEETS	SHEET NO.
90/94	•	COOK	860	809
STA. 2200+00.00 TO STA. 2362+00.00				
FED. ROAD DIST. NO. ILLINOIS FED. AID PROJECT				
• (1516.1, 1717 & 1818) R-8		62694		

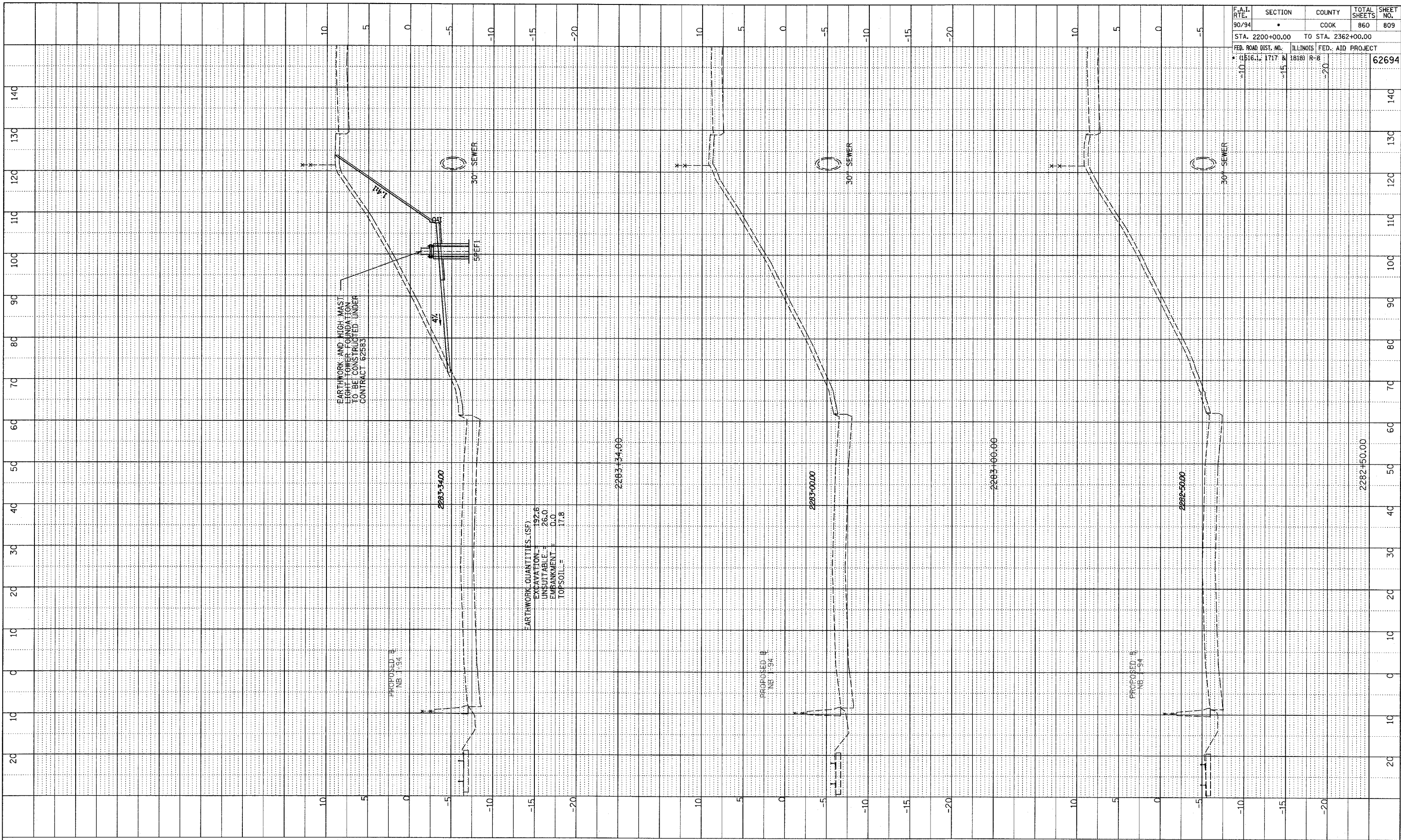

TYLIN INTERNATIONAL

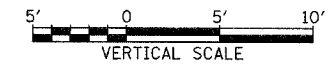

NB 87th ST. ENTRANCE RAMP
 STA. 2282+50 TO STA. 2283+34