

PLOTTED
 DATE: _____
 BY: _____
 CHECKED: _____
 NO. _____
 STRUCTURE NOTATIONS CHFD

F.A.I. RTE.	SECTION	COUNTY	TOTAL SHEETS	SHEET NO.
90/94		COOK	860	811
STA. 2200+00.00 TO STA. 2362+00.00				
FED. ROAD DIST. NO. ILLINOIS FED. AID PROJECT				
• (1516.1, 1717 & 1818) R-8				
				62694

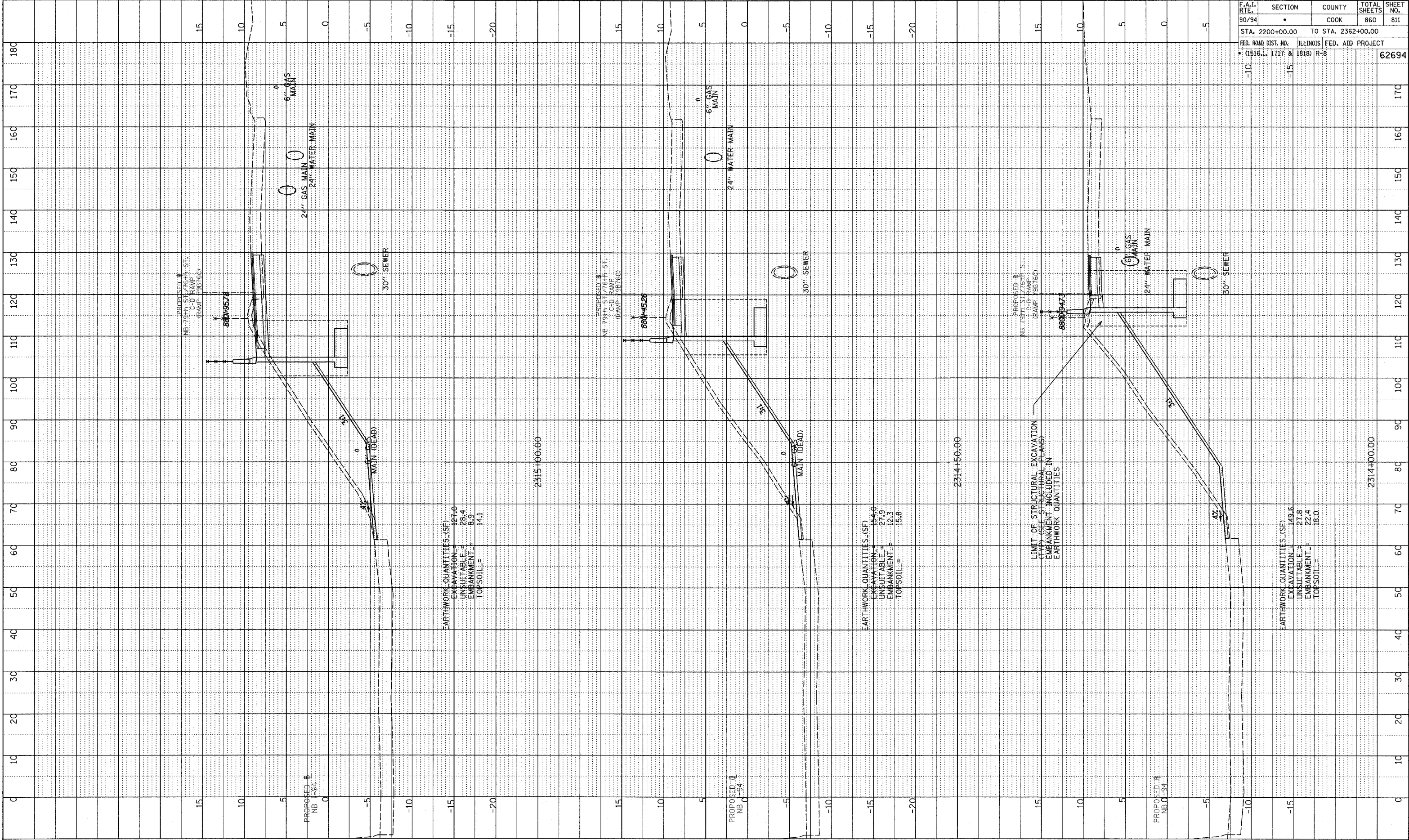

EARTHWORK QUANTITIES (SF)
 EXCAVATION = 127.0
 UNSUITABLE = 28.4
 EMBANKMENT = 8.9
 TOPSOIL = 14.1

EARTHWORK QUANTITIES (SF)
 EXCAVATION = 154.0
 UNSUITABLE = 27.9
 EMBANKMENT = 12.3
 TOPSOIL = 15.8

EARTHWORK QUANTITIES (SF)
 EXCAVATION = 149.5
 UNSUITABLE = 27.8
 EMBANKMENT = 22.4
 TOPSOIL = 18.0

LIMIT OF STRUCTURAL EXCAVATION
 (TYP. SEE STRUCTURAL PLANS)
 EMBANKMENT INCLUDED IN
 EARTHWORK QUANTITIES

TYLIN INTERNATIONAL

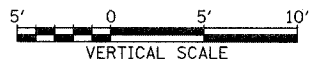

NB 79th TO 76th C-D RAMP
 STA. 2314+00 TO STA. 2315+00

p:\02313\road\76\0\app\traxss\7916_f.dgn