

PLOTTED & CHECKED
 DATE: 11/15/16
 NO. _____
 STRUCTURE NOTATION: CP10

F.A.I. RTE.	SECTION	COUNTY	TOTAL SHEETS	SHEET NO.
90/94	*	COOK	860	815
STA. 2200+00.00		TO STA. 2362+00.00		
FED. ROAD DIST. NO.		ILLINOIS FED. AID PROJECT		
* (1516.1, 1717 & 1818) R-8				62694

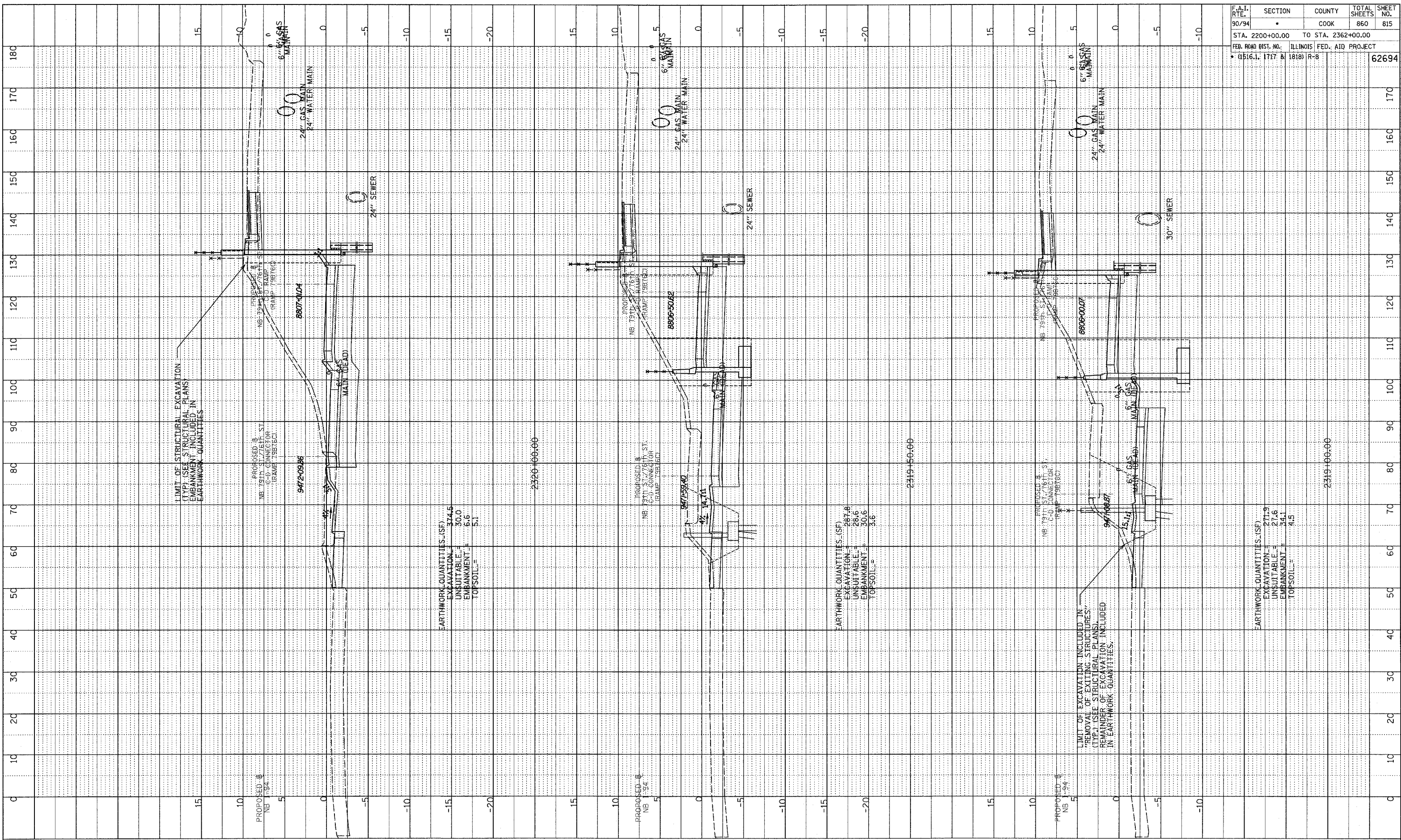

EARTHWORK QUANTITIES (SF)
 EXCAVATION = 374.5
 UNSUITABLE = 30.0
 EMBANKMENT = 6.6
 TOPSOIL = 5.1

EARTHWORK QUANTITIES (SF)
 EXCAVATION = 287.8
 UNSUITABLE = 28.6
 EMBANKMENT = 30.6
 TOPSOIL = 3.6

EARTHWORK QUANTITIES (SF)
 EXCAVATION = 271.9
 UNSUITABLE = 27.6
 EMBANKMENT = 34.1
 TOPSOIL = 4.5

TYLIN INTERNATIONAL

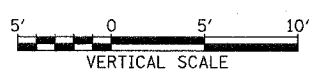
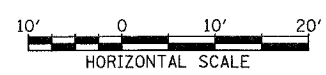

NB 79th TO 76th C-D RAMP
 STA. 2319+00 TO STA. 2320+00

P:\0237\road\cfd\cfd\17\axis\1796_T.dgn