

NOTE BOOK  
 PLOTTED, CHECKED  
 DRAWN BY  
 NO. \_\_\_\_\_  
 STRUCTURE NOTATION CHKO

F.A.I. RTE. 90/94	SECTION •	COUNTY COOK	TOTAL SHEETS 860	SHEET NO. 833
STA. 2200+00.00		TO STA. 2362+00.00		
FED. ROAD DIST. NO. • (1516.1, 1717 & 1818)		ILLINOIS FED. AID PROJECT R-8		62694

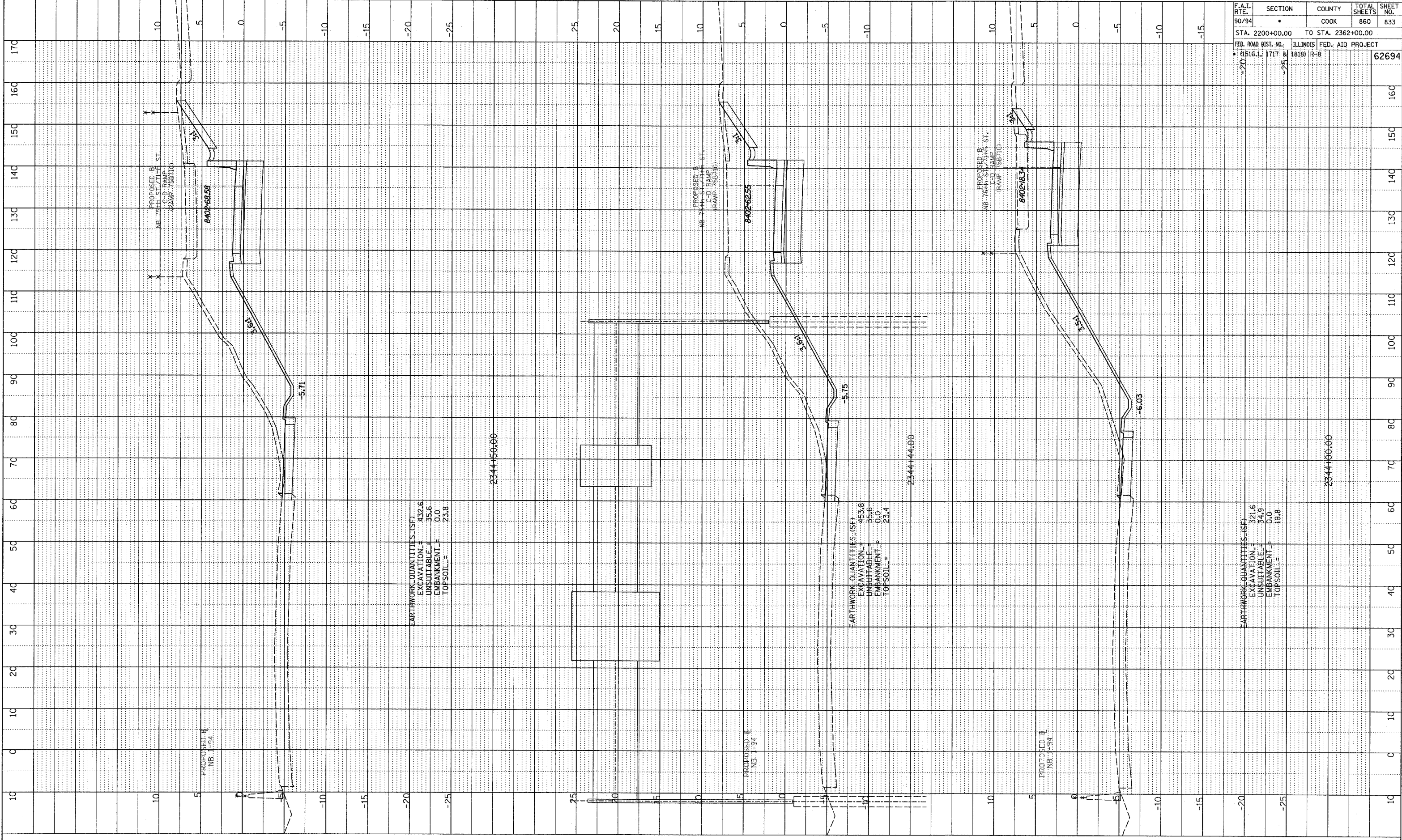

TYLIN INTERNATIONAL

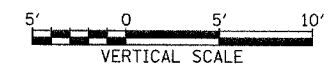

NB 75th TO 71st, C-D RAMP  
 STA. 2344+00 TO STA. 2344+50

D:\0231\Drawings\0231\0231\0231.dwg