

PROFILE SLAVED
 GRADES CHECKED
 NOTE BOOK NO. _____
 DATE _____
 DRAWN BY _____
 CHECKED BY _____

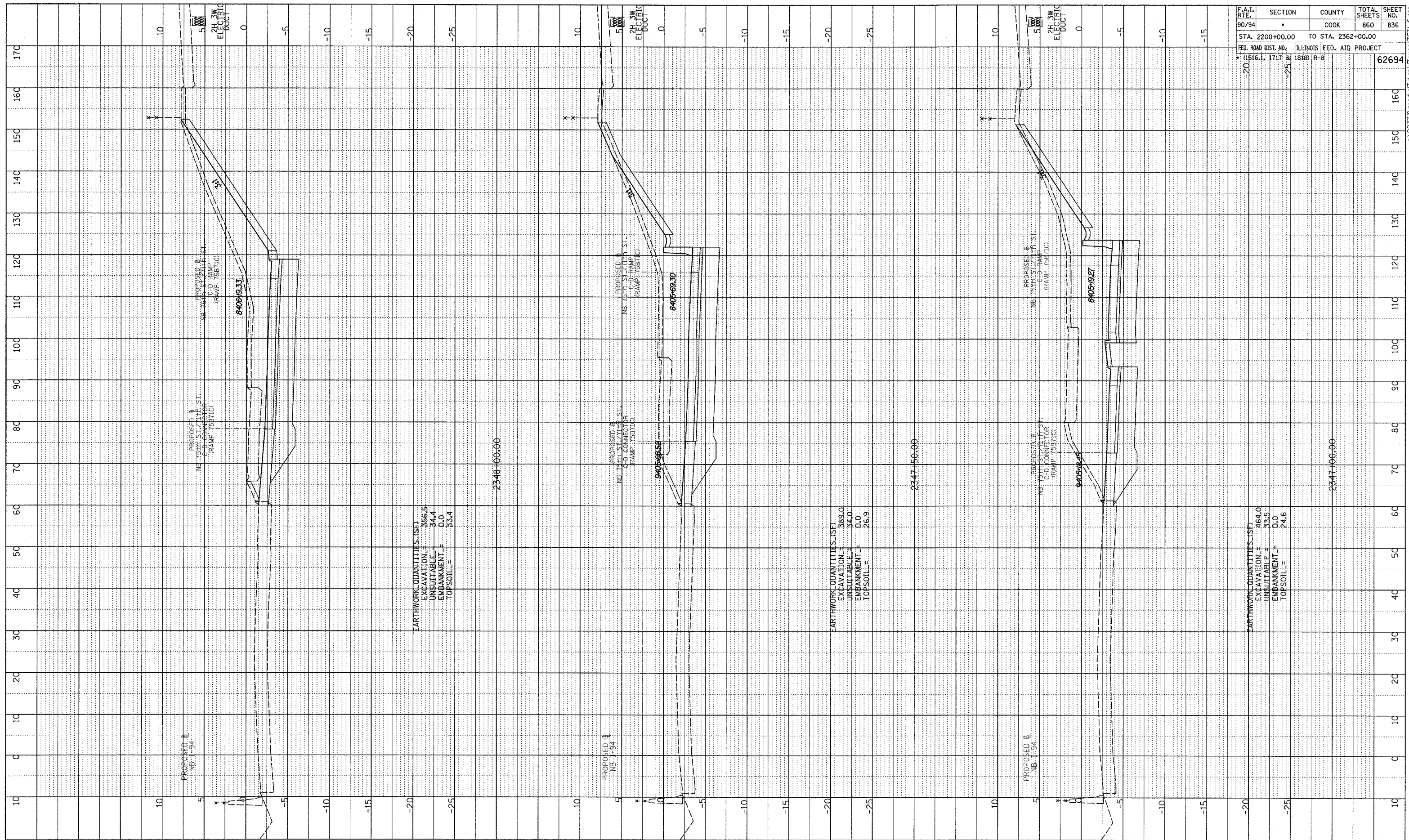

F.A.I. RTE.	SECTION	COUNTY	TOTAL SHEETS	SHEET NO.
90/94		COOK	860	836
STA. 2200+00.00 TO STA. 2362+00.00		ILLINOIS FED. AID PROJECT		
• (1516.1, 1717 & 1818) R-8		62694		

TYLIN INTERNATIONAL

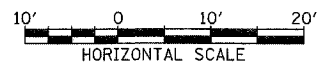

NB 75th TO 71st. C-D RAMP
 STA. 2347+00 TO STA. 2348+00

P:\0237\3\coord\94\94\pki\taxssn\571_f.dgn