

PLOTTED
 DATE CHECKED
 DRAWING NO. 2351-100-00
 STRUCTURE NOTATION 0190

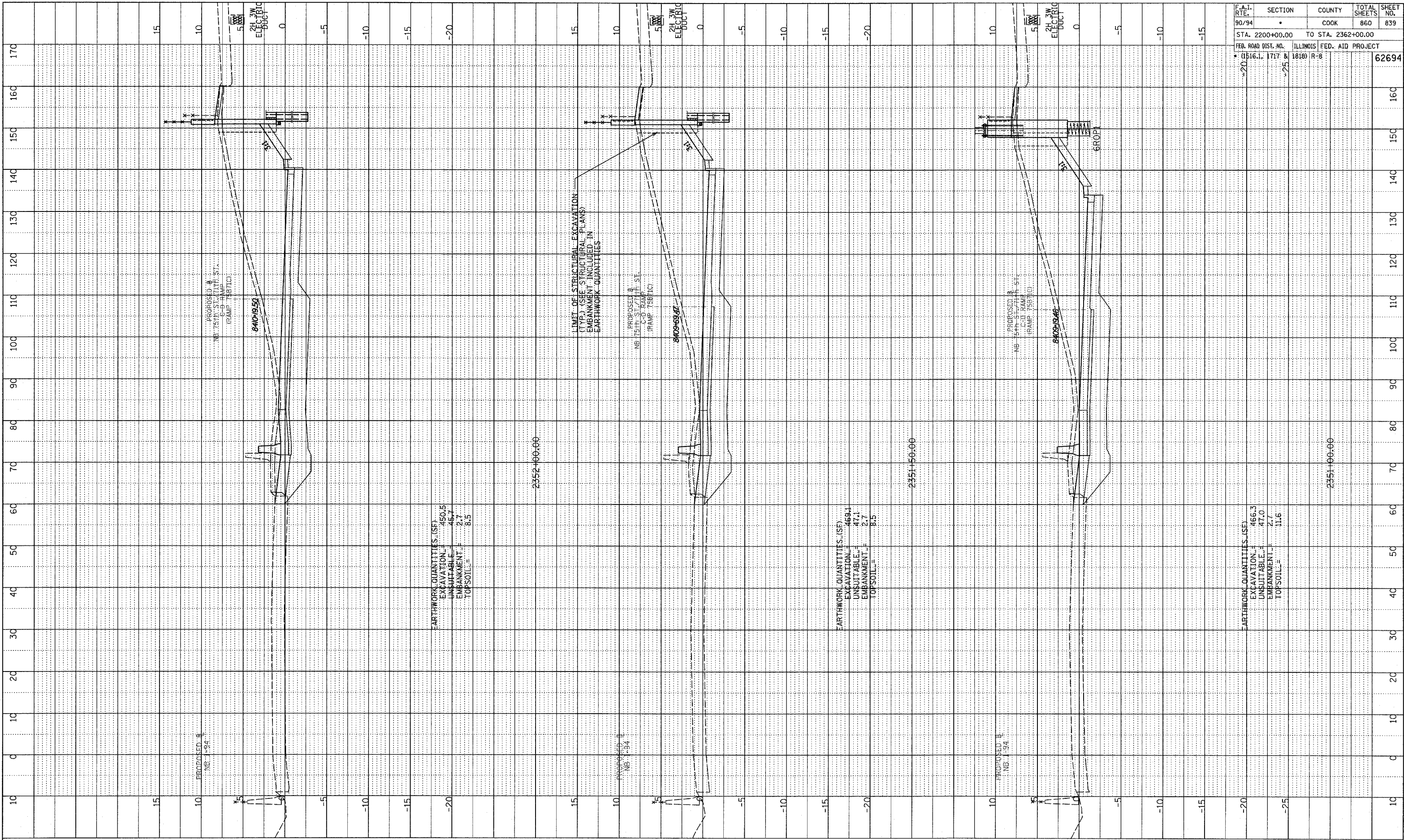

TYLIN INTERNATIONAL

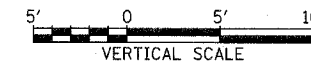
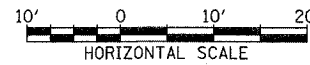

NB 75th TO 71st. C-D RAMP
 STA. 2351+00 TO STA. 2352+00

F.A.I. RTE.	SECTION	COUNTY	TOTAL SHEETS	SHEET NO.
90/94		COOK	860	839
STA. 2200+00.00 TO STA. 2362+00.00				
FED. ROAD DIST. NO. ILLINOIS FED. AID PROJECT			62694	
• (1516.1, 1717 & 1818) R-8				

P:\0237\3\road\c-d\c-gpk\cross\571-f.dgn