

F.A.P. RTE.	SECTION	COUNTY	TOTAL SHEETS	SHEET NO.
330	2004-018TS	COOK	28	26
STA.		TO STA.		
FED. ROAD DIST. NO. 1		ILLINOIS	FED. AID PROJECT	
CONTRACT NO. 62737				

INTERCONNECT SCHEDULE OF QUANTITIES

PAY ITEM	UNIT	INTERCONNECT
TRAFFIC CONTROL AND PROTECTION, STANDARD 701501	L SUM	0.2
TRAFFIC CONTROL AND PROTECTION, STANDARD 701606	L SUM	0.2
TRAFFIC CONTROL AND PROTECTION, STANDARD 701701	L SUM	0.2
TRAFFIC CONTROL AND PROTECTION, STANDARD 701801	L SUM	0.2
CONDUIT IN TRENCH, 2" DIA., GALVANIZED STEEL	FOOT	3566
CONDUIT PUSHED, 2" DIA., GALVANIZED STEEL	FOOT	1114
HANDHOLE	EACH	8
TRENCH AND BACKFILL FOR ELECTRICAL WORK	FOOT	3566
MASTER CONTROLLER	EACH	1
DRILL EXISTING HANDHOLE	EACH	3
ELECTRIC CABLE IN CONDUIT, TRACER NO. 14 1C	FOOT	4950
FIBER OPTIC CABLE IN CONDUIT, NO. 62.5/125, MM12F SM12F	FOOT	4950
RE-OPTIMIZE TRAFFIC SIGNAL SYSTEM	L SUM	1

INTERCONNECT SCHEMATIC LEGEND

- | | |
|--|--|
| EXISTING INTERSECTION CONTROLLER | |
| PROPOSED INTERSECTION CONTROLLER | |
| EXISTING MASTER CONTROLLER | |
| PROPOSED MASTER CONTROLLER | |
| MASTER MASTER CONTROLLER | |
| EXISTING INTERSECTION AND SAMPLING (SYSTEM) DETECTORS | |
| PROPOSED INTERSECTION AND SAMPLING (SYSTEM) DETECTORS | |
| EXISTING INTERSECTION LOOP DETECTORS | |
| PROPOSED SAMPLING (SYSTEM) DETECTORS | |
| EXISTING SAMPLING (SYSTEM) DETECTORS | |
| PROPOSED SAMPLING (SYSTEM) DETECTORS | |
| EXISTING INTERCONNECT CABLE - NO. 62.5/125 12F FIBER OPTIC CABLE | |
| PROPOSED INTERCONNECT CABLE - NO. 62.5/125 12F FIBER OPTIC CABLE | |
| EXISTING INTERCONNECT CABLE - NO. 18 3 PAIR TWISTED, SHIELDED | |
| PROPOSED INTERCONNECT CABLE - NO. 18 3 PAIR TWISTED, SHIELDED | |
| EXISTING LOOP DETECTOR CABLE - 2/C TWISTED, SHIELDED | |
| PROPOSED LOOP DETECTOR CABLE - 2/C TWISTED, SHIELDED | |
| EXISTING ELECTRIC CABLE 1/C (AS SPECIFIED) | |
| PROPOSED ELECTRIC CABLE 1/C (AS SPECIFIED) | |
| EXISTING TELEPHONE CONNECTION | |
| PROPOSED TELEPHONE CONNECTION | |

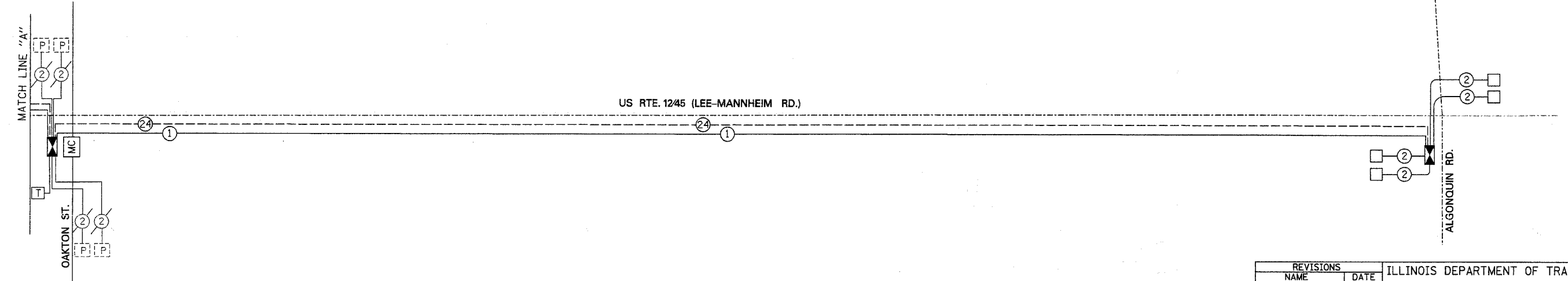
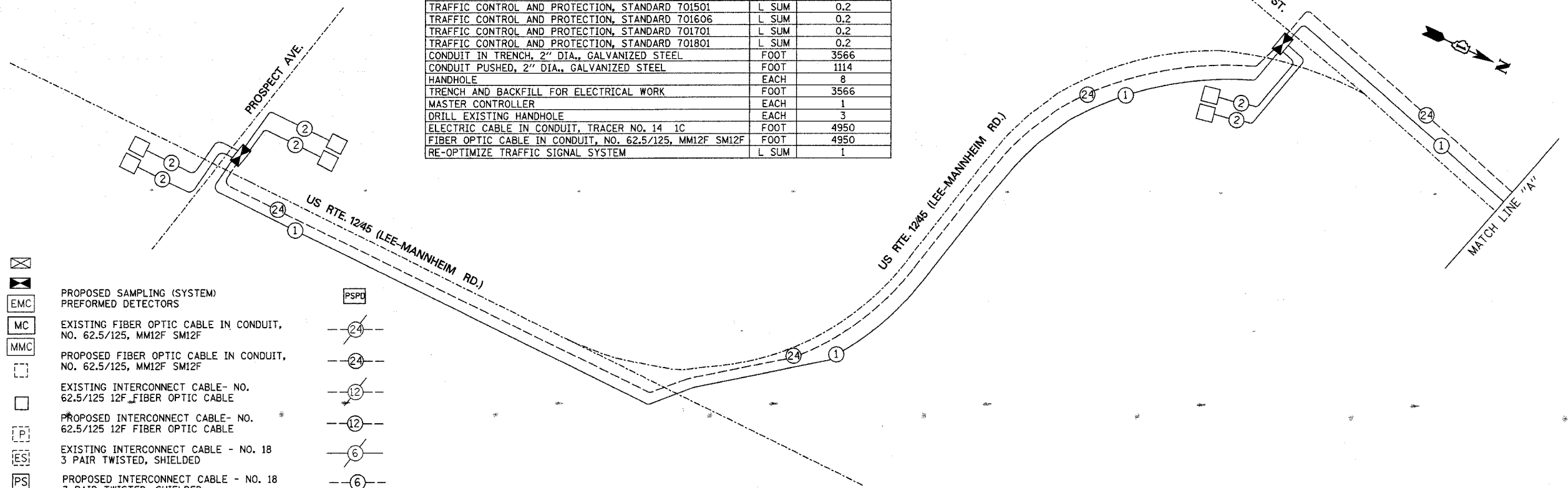

REVISIONS	
NAME	DATE

ILLINOIS DEPARTMENT OF TRANSPORTATION

INTERCONNECT SCHEMATIC PLAN
US RTE. 12/45 (LEE-MANNHEIM RD.)
FROM PROSPECT AVE. TO ALGONQUIN RD.

SCALE: NONE
DATE: FEBRUARY, 2005

DRAWN BY: RV/MD
DESIGNED BY: DS
CHECKED BY: AS/KG

K&E KAM ENGINEERING, INC.
CONSULTING ENGINEERS
707A Davis Road, Suite 205
Elgin, Illinois 60123-1369

G:\Projects\337\SH1\Mannheim\Schematic.sht 02/17/2005