

INFRASTRUCTURE ENGINEERING, INC.
 29 S. LASALLE ST., SUITE 345
 CHICAGO, IL 60603-1557
 PHONE: 312.425.9360
 FAX: 312.425.9360
 WWW: www.infrastructure-eng.com

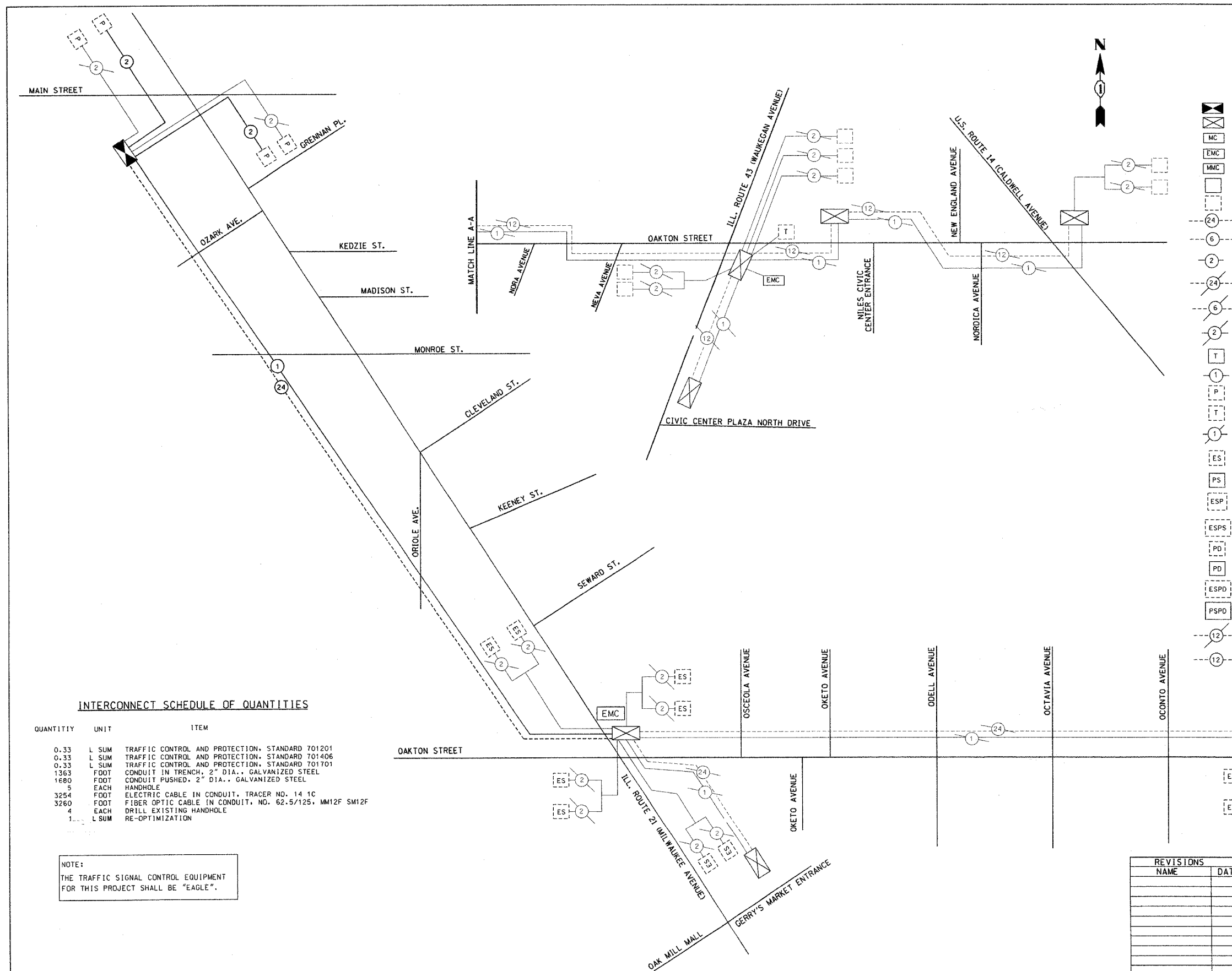

F.A.P. RTE.	SECTION	COUNTY	TOTAL SHEETS	SHEET NO.
374	2004-020 TS	COOK	13	13
STA.		TO STA.		
FED. ROAD DIST. NO.		ILLINOIS FED. AID PROJECT		
CONTRACT NUMBER: 62739				



INTERCONNECT SCHEMATIC LEGEND

- INTERSECTION CONTROLLER
- EXISTING INTERSECTION CONTROLLER
- MASTER CONTROLLER
- EXISTING MASTER CONTROLLER
- MASTER MASTER CONTROLLER
- PROPOSED INTERSECTION & SAMPLING (SYSTEM) DETECTORS
- EXISTING INTERSECTION & SAMPLING (SYSTEM) DETECTORS
- PROPOSED FIBER OPTIC CABLE- NO. 62.5/125 MM12F SM12F
- EXISTING FIBER OPTIC CABLE-NO. 18 3 PAIR TWISTED, SHIELDED
- LOOP DETECTOR CABLE-2/C TWISTED, SHIELDED
- EXISTING FIBER OPTIC CABLE-NO. 62.5/125 MM12F SM12F
- EXISTING INTERCONNECT CABLE-NO. 18 3 PAIR TWISTED, SHIELDED
- EXISTING LOOP DETECTOR CABLE-2/C TWISTED, SHIELDED
- TELEPHONE CONNECTION
- PROPOSED TRACER CABLE NO. 14 1C
- EXISTING INTERSECTION LOOP DETECTORS AND PROPOSED SAMPLING (SYSTEM) DETECTORS
- EXISTING TELEPHONE CONNECTION
- EXISTING TRACER CABLE 1/C (AS SPECIFIED)
- EXISTING SAMPLING (SYSTEM) DETECTORS
- PROPOSED SAMPLING (SYSTEM) DETECTORS
- EXISTING SAMPLING (SYSTEM) DETECTORS, PROPOSED INTERSECTION AND SAMPLING (SYSTEM) DETECTORS.
- EXISTING SAMPLING (SYSTEM) DETECTORS, PROPOSED SAMPLING (SYSTEM) DETECTORS.
- EXISTING PREFORMED INTERSECTION & SAMPLING (SYSTEM) DETECTORS.
- PROPOSED PREFORMED INTERSECTION & SAMPLING (SYSTEM) DETECTORS.
- EXISTING SAMPLING (SYSTEM) PREFORMED DETECTORS.
- PROPOSED SAMPLING (SYSTEM) PREFORMED DETECTORS.
- EXISTING INTERCONNECT CABLE-NO. 62.5/125 12F FIBER OPTIC CABLE
- PROPOSED INTERCONNECT CABLE-NO. 62.5/125 12F FIBER OPTIC CABLE

INTERCONNECT SCHEDULE OF QUANTITIES

QUANTITY	UNIT	ITEM
0.33	L SUM	TRAFFIC CONTROL AND PROTECTION, STANDARD 701201
0.33	L SUM	TRAFFIC CONTROL AND PROTECTION, STANDARD 701406
0.33	L SUM	TRAFFIC CONTROL AND PROTECTION, STANDARD 701701
1363	FOOT	CONDUIT IN TRENCH, 2" DIA., GALVANIZED STEEL
1680	FOOT	CONDUIT PUSHED, 2" DIA., GALVANIZED STEEL
5	EACH	HANDHOLE
3254	FOOT	ELECTRIC CABLE IN CONDUIT, TRACER NO. 14 1C
3260	FOOT	FIBER OPTIC CABLE IN CONDUIT, NO. 62.5/125, MM12F SM12F
4	EACH	DRILL EXISTING HANDHOLE
1	L SUM	RE-OPTIMIZATION

NOTE:
 THE TRAFFIC SIGNAL CONTROL EQUIPMENT FOR THIS PROJECT SHALL BE "EAGLE".

REVISIONS	
NAME	DATE

ILLINOIS DEPARTMENT OF TRANSPORTATION
INTERCONNECT SCHEMATIC
ILL. 21 (MILWAUKEE AVENUE)
FROM MAIN STREET TO OAKTON STREET

SCALE: 1"=20'
 DATE 09-20-04
 DRAWN BY N.B.
 DESIGNED BY N.B.
 CHECKED BY D.B./M.S.