

F.A.U. RTE.	SECTION	COUNTY	TOTAL SHEETS	SHEET NO.
1602	2004-021TS	COOK	25	22
STA.		TO STA.		
FED. ROAD DIST. NO.	ILLINOIS	FED. AID PROJECT		
CONTRACT NO. 62740				

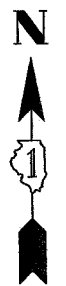

MATCH LINE STA. 22+00
SEE SHEET 1 OF 3

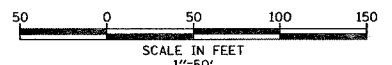
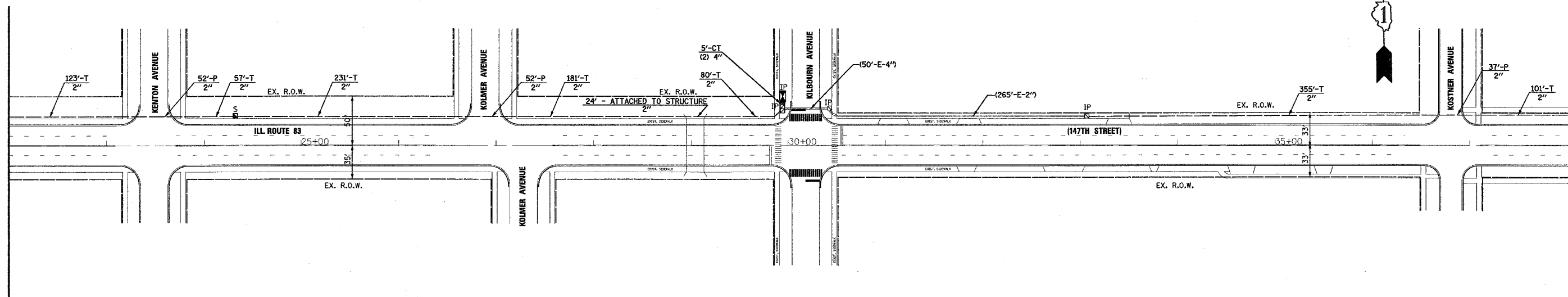

MATCH LINE STA. 38+00
SEE BELOW LEFT

MATCH LINE STA. 38+00
SEE ABOVE RIGHT

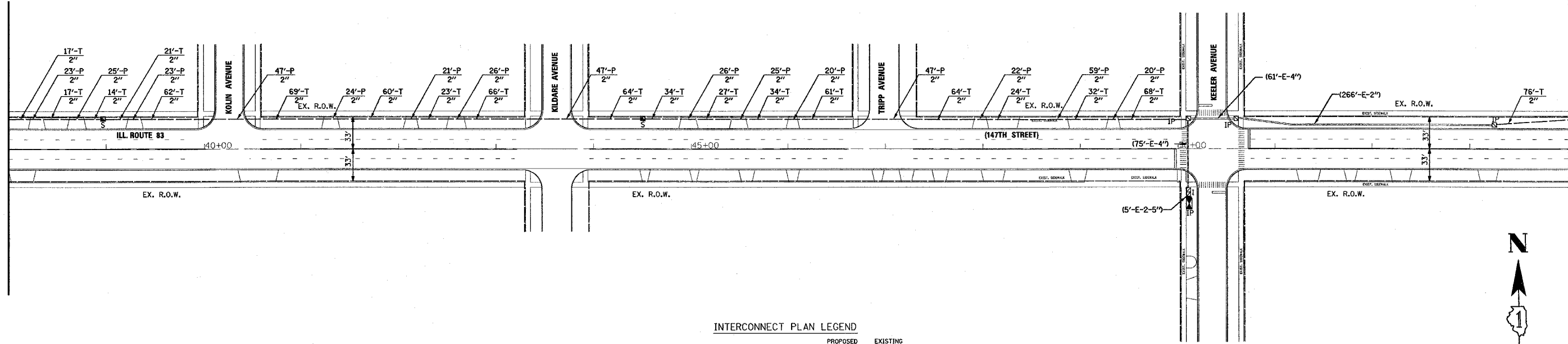

MATCH LINE STA. 54+00
SEE SHEET 3 OF 3



INTERCONNECT PLAN LEGEND

	PROPOSED	EXISTING
CONTROLLER		
HANDHOLE		
DOUBLE HANDHOLE		
HEAVY DUTY HANDHOLE		
G.S. CONDUIT IN TRENCH (T) OR PUSHED (P)		
DETECTOR LOOP		
UNIT DUCT	UD	
SYSTEM	S	
INTERSECTION	IP	I
TELEPHONE CONNECTION		

NOTE:
THE EXISTING MASTER CONTROLLER IS LOCATED AT
IL. RTE. 50 (CICERO AVENUE) AND 159TH STREET.

NOTE:
THE TRAFFIC SIGNAL CONTROL EQUIPMENT
FOR THIS PROJECT SHALL BE "ECONOLITE"
TO MATCH THE ADJACENT SYSTEM.

SETON ENGINEERING
SERVICE CORPORATION
CIVIL ENGINEERS
19 S. BOTHWELL STREET
PALATINE, ILLINOIS 60067
VOICE: 847-776-7200 FAX: 847-776-7239

REVISIONS	
NAME	DATE

ILLINOIS DEPARTMENT OF TRANSPORTATION
INTERCONNECT PLAN
ILL. ROUTE 83 (147TH STREET) FROM
ILL. ROUTE 50 (CICERO AVENUE) TO
PULASKI ROAD
MIDLOTHIAN, IL
SHEET 2 OF 3
SCALE: 1"=50'
DATE 09-20-2004
DRAWN BY CWC
DESIGNED BY VO
CHECKED BY TJM