

SCHEDULE OF QUANTITIES

ITEM	UNIT	QUANTITY
CONDUIT IN TRENCH, 2" DIA, GALVANIZED STEEL	FOOT	15
TRENCH AND BACKFILL FOR ELECTRICAL WORK	FOOT	15
MAINTENANCE OF EXISTING TRAFFIC SIGNAL INSTALLATION	EACH	1
* LIGHT DETECTOR	EACH	2
* LIGHT DETECTOR AMPLIFIER	EACH	1
FULL-ACTUATED CONTROLLER AND TYPE V CABINET	EACH	1
TRANSCIVER-FIBER OPTIC	EACH	1
ELECTRIC CABLE IN CONDUIT, SIGNAL, NO. 14 3C	FOOT	570
ELECTRIC CABLE IN CONDUIT, GROUNDING, NO. 6 1C	FOOT	114
REMOVE EXISTING TRAFFIC SIGNAL EQUIPMENT	EACH	1
SIGNAL HEAD, 1-FACE, 3-SECTION, BRACKET MOUNTED	EACH	2
INDUCTIVE LOOP DETECTOR	EACH	8
SERVICE INSTALLATION, POLE MOUNTED	EACH	1
ELECTRIC CABLE IN CONDUIT, NO. 20 3C, TWISTED, SHIELDED	FOOT	570

* 100% COST TO VILLAGE OF MORTON GROVE

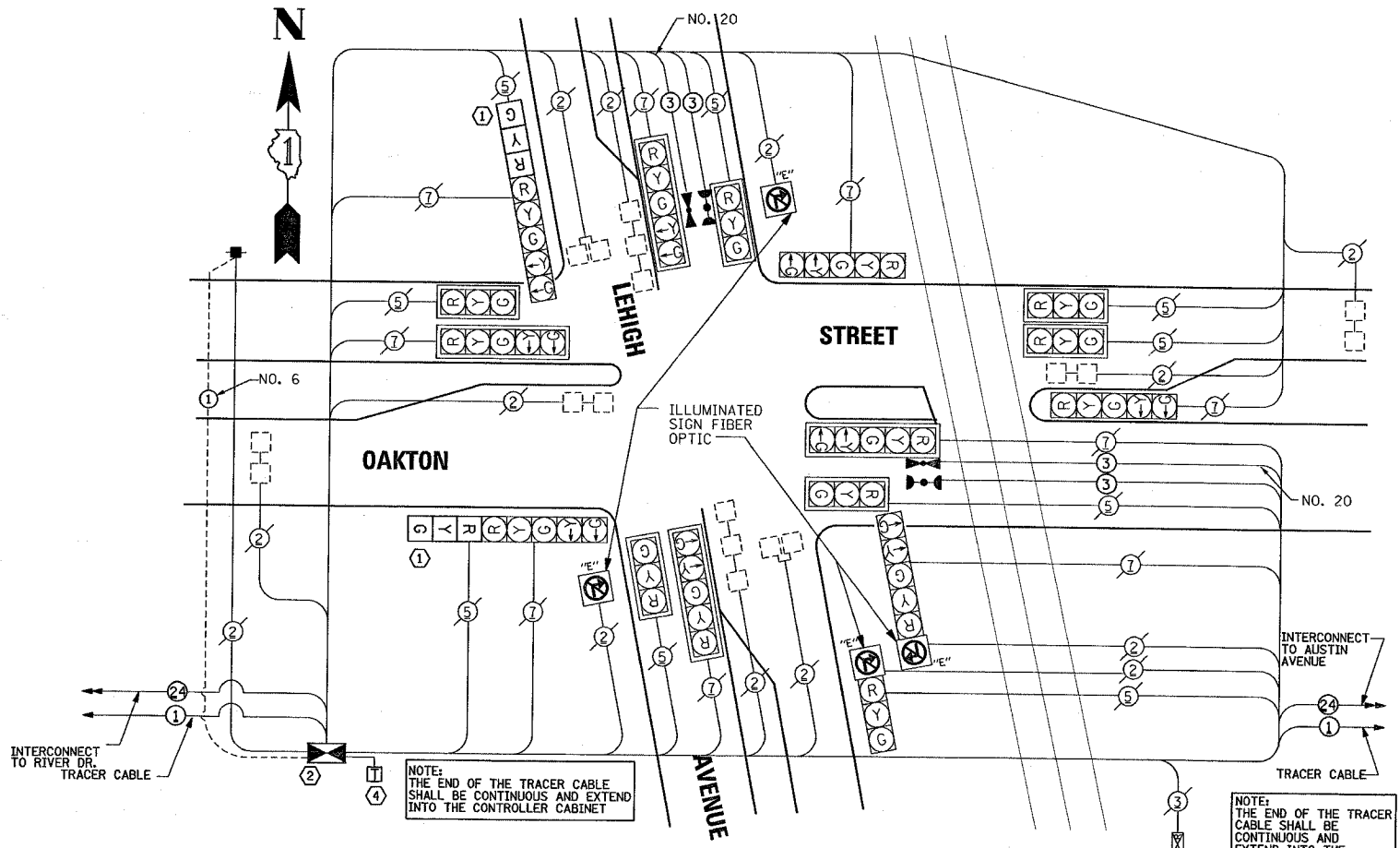

NOTE: THE END OF THE TRACER CABLE SHALL BE CONTINUOUS AND EXTEND INTO THE CONTROLLER CABINET

NOTE: THE END OF THE TRACER CABLE SHALL BE CONTINUOUS AND EXTEND INTO THE CONTROLLER CABINET

CABLE PLAN LEGEND

EXISTING	PROPOSED	DESCRIPTION
⊗	⊗	8" (200mm) TRAFFIC SIGNAL SECTION
⊗	⊗	12" (300mm) TRAFFIC SIGNAL SECTION
⊗	⊗	12" (300mm) PEDESTRIAN SIGNAL SECTION
⊗	⊗	12" (300mm) PEDESTRIAN SIGNAL SECTION
⊗	⊗	CONTROLLER CABINET
⊗	⊗	SERVICE INSTALLATION
⊗	⊗	TELEPHONE CONNECTION
⊗	⊗	VEHICLE DETECTOR, INDUCTION LOOP
⊗	⊗	MAGNETIC DETECTOR
⊗	⊗	EMERGENCY VEHICLE LIGHT DETECTOR
⊗	⊗	CONFIRMATION BEACON
⊗	⊗	PUSHBUTTON DETECTOR
⊗	⊗	GROUND CABLE IN CONDUIT NO. 6 SOLID COPPER (GREEN)
⊗	⊗	FIBER OPTIC CABLE IN CONDUIT NO. 62.5/125 MM12F SM12F
⊗	⊗	SIGNAL FACE WITH BACKPLATE, "P" INDICATES PROGRAMMED HEAD
⊗	⊗	RAILROAD CONTROL CABINET
⊗	⊗	ILLUMINATED SIGN "NO LEFT TURN"
⊗	⊗	ILLUMINATED SIGN "NO RIGHT TURN"
⊗	⊗	GROUND ROD AT HANDHOLE (H), OR MAST ARM POLE (MA).
⊗	⊗	GROUND ROD AT ELECTRIC SERVICE INSTALLATION
⊗	⊗	MICROWAVE VEHICLE SENSOR

I.D.O.T. TRAFFIC SIGNAL INSTALLATION ELECTRICAL SERVICE REQUIREMENTS					TOTAL WATTAGE
TYPE	NO. LAMPS	WATTAGE INCAND.	WATTAGE LED	X % OPERATION	
SIGNAL (RED)	18	135	17	0.50	1215.00
(YELLOW)	18	135	25	0.25	607.50
(GREEN)	18	135	15	0.25	607.50
ARROW	18	135	12	0.10	243.00
PED. SIGNAL	0	90	25	1.00	0.00
CONTROLLER	1	100	100	1.00	100.0
ILLUM. SIGN	4	84	35	0.05	16.8
FLASHER	0			0.50	0.00
TOTAL =					2789.80

- CONSTRUCTION NOTES:
- REMOVE EXISTING 8" SIGNAL HEAD, 1-FACE, 3-SECTION, BRACKET MOUNTED, INSTALL NEW 12" SIGNAL HEAD, 1-FACE, 3-SECTION, BRACKET MOUNTED.
 - REMOVE EXISTING CONTROLLER AND CABINET. INSTALL MASTER CONTROLLER AND LOCAL CONTROLLER IN TYPE V CABINET, RE-USE EXISTING FOUNDATION.
 - THE CONTRACTOR SHALL BE REQUIRED TO MAINTAIN THE OPERATION OF THE TRAFFIC SIGNALS DURING THE ENTIRE PROJECT.
 - INSTALL 1" UNIT DUCT FOR THE AMERITECH SERVICE FROM THE POINT OF ENTRY OF THE TELEPHONE CONDUIT IN THE DOUBLE HANDHOLE THROUGH THE CONTROLLER CABINET FOUNDATION. THIS WORK SHALL BE INCIDENTAL TO THE MASTER CONTROLLER PAY ITEM.

FOUNDATION (DEPTH)	(FT.) (m)	CABLE SLACK	(FT.) (m)	VERTICAL	(FT.) (m)
TYPE A - POST	4 (1.2)	HANDHOLE	6.5 (2.0)	ALL FOUNDATIONS	3.5 (1.0)
D - CONTROLLER	4 (1.2)	DOUBLE HANDHOLE	13 (4.0)	MAST ARM (L) POLE	20' + L - 2' = (6m + L - 0.6m) =
E - M. ARM POLE		SIGNAL POST	2 (1.0)	BRACKET MOUNTED	13 (4.0)
24" (600mm)	10 (3.0)	CONTROLLER CAB.	1 (0.5)	PED. PUSHBUTTON	4 (1.2)
30" (750mm)	15 (4.6)	FIBER OPTIC	13 (4.0)	ELECTRIC SERVICE	13.5 (4.1)
		ELECTRIC SERVICE	1 (0.5)	SERVICE TO GROUND	13.5 (4.1)
		GROUND CABLE	1 (0.5)	POST MOUNTED	6 (1.8)

ENERGY COSTS - BILLED TO: 75% - VILLAGE OF MORTON GROVE
 (ADDRESS) 6101 CAPULINA AVENUE
 MORTON GROVE, IL 60053

25% - VILLAGE OF SKOKIE
 5127 OAKTON STREET
 P.O. BOX 309
 SKOKIE, IL 60077

ENERGY SUPPLY - CONTACT: MR. MIKE LYNCH
 PHONE: (847) 816-5331
 COMPANY: COMED

SETON ENGINEERING
 SERVICE CORPORATION
 CIVIL ENGINEER

19 S. BOTHWELL STREET
 PALATINE, ILLINOIS 60067
 VOICES 847-776-7200 FAX 847-776-7239

REVISIONS	
NAME	DATE

ILLINOIS DEPARTMENT OF TRANSPORTATION
 CABLE PLAN, PHASE DESIGNATION DIAGRAM
 AND SCHEDULE OF QUANTITIES

OAKTON STREET AT LEHIGH AVENUE
 MORTON GROVE, ILLINOIS

SCALE: 1/8" = 1'-0"
 DATE: 09-20-2004

DRAWN BY: BR
 DESIGNED BY: JO
 CHECKED BY: TJM