

F.A.U. RTE.	SECTION	COUNTY	TOTAL SHEETS	SHEET NO.
1332	2004-022TS	COOK	20	18
STA.		TO STA.		
FED. ROAD DIST. NO.		ILLINOIS FED. AID PROJECT		
CONTRACT NO. 62741				

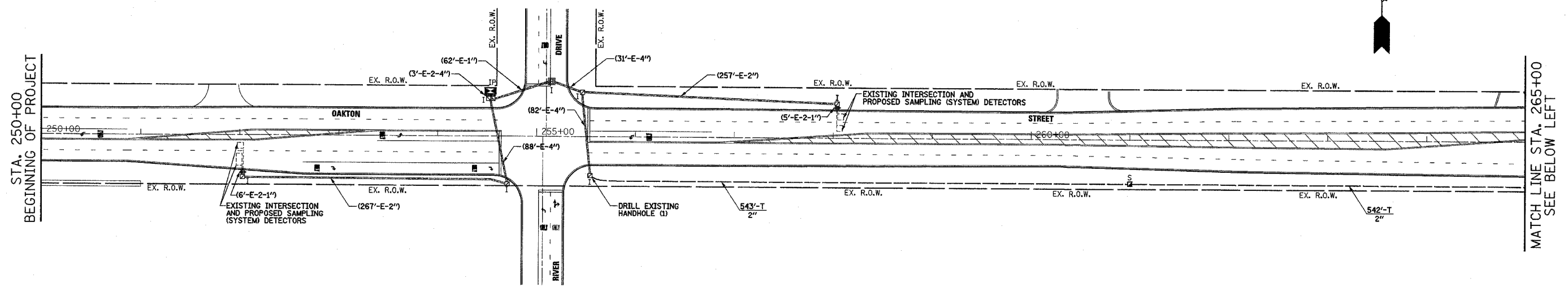

STA. 250+00
BEGINNING OF PROJECT

MATCH LINE STA. 265+00
SEE BELOW LEFT

INTERCONNECT PLAN LEGEND

	PROPOSED	EXISTING
CONTROLLER		
HANDHOLE		
DOUBLE HANDHOLE		
HEAVY DUTY HANDHOLE		
G.S. CONDUIT IN TRENCH (T) OR PUSHED (P)		
DETECTOR LOOP		
UNIT DUCT SYSTEM	UD S	
INTERSECTION	IP	I
TELEPHONE CONNECTION		
MASTER CONTROLLER	MC	

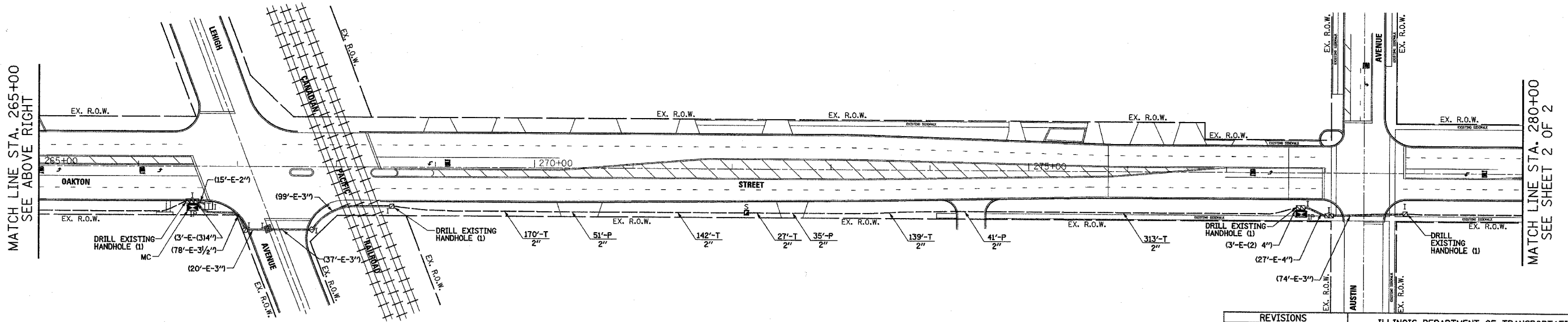

MATCH LINE STA. 265+00
SEE ABOVE RIGHT

MATCH LINE STA. 280+00
SEE SHEET 2 OF 2

SETON ENGINEERING
SERVICE CORPORATION
CIVIL ENGINEERS
19 S. BOTHWELL STREET
PALATINE, ILLINOIS 60067
VOICE: 847-776-7200 FAX: 847-776-7239

REVISIONS	
NAME	DATE

ILLINOIS DEPARTMENT OF TRANSPORTATION
INTERCONNECT PLAN
OAKTON AVENUE
FROM RIVER DRIVE TO AUSTIN AVENUE
MORTON GROVE, IL
SHEET 1 OF 2

SCALE: 1" = 50'
DATE 09-20-2004

DRAWN BY BR
DESIGNED BY VO
CHECKED BY TJM