

CONTRACT NO. 62746				
F.A.I. RTE.	SECTION	COUNTY	TOTAL SHEETS	SHEET NO.
90		COOK	82	29
STA. 3375+00		TO STA. 3390+00		
FED. ROAD DIST. NO.		ILLINOIS FED. AID PROJECT		
• (1012, 1214, 1415, & 1517) RS-3				

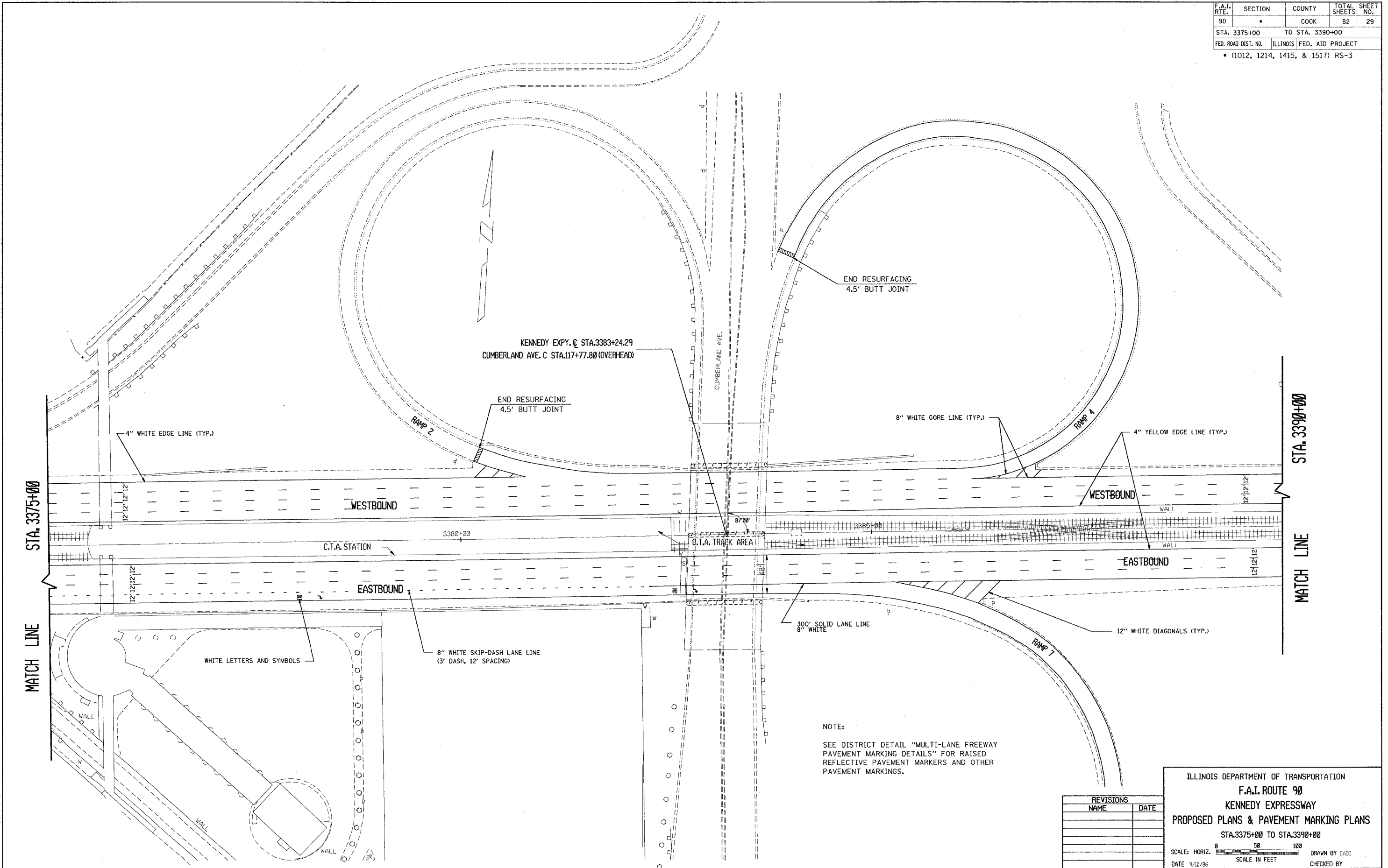

NOTE:  
SEE DISTRICT DETAIL "MULTI-LANE FREEWAY PAVEMENT MARKING DETAILS" FOR RAISED REFLECTIVE PAVEMENT MARKERS AND OTHER PAVEMENT MARKINGS.

REVISIONS	
NAME	DATE

ILLINOIS DEPARTMENT OF TRANSPORTATION  
**F.A.I. ROUTE 90**  
**KENNEDY EXPRESSWAY**  
**PROPOSED PLANS & PAVEMENT MARKING PLANS**  
 STA. 3375+00 TO STA. 3390+00

SCALE: HORIZ. SCALE IN FEET  
 DATE 9/18/86 DRAWN BY CADD CHECKED BY

5/2/2005  
 Z:\PROJECTS\19000\19000.DWG  
 LEVITZIS = 3.6.27.28.35.38

5/2/2005  
 ci:\projects\19000\19000.m32