

F.A.I. RTE.	SECTION	COUNTY	TOTAL SHEETS	SHEET NO.
90/94	2004-0561	COOK	47	36
STA. 601+25		TO STA. 606+25		
FED. ROAD DIST. NO. 1 ILLINOIS FED. AID PROJECT				

62795

LEGEND:

- PAVEMENT REMOVAL (BY OTHERS)
- MEDIAN REMOVAL (BY OTHERS)
- LINEAR REMOVALS (BY OTHERS)
- SIDEWALK REMOVAL (BY OTHERS)
- APPROACH SLAB REMOVAL (BY OTHERS)
- DRIVEWAY PAVEMENT REMOVAL (BY OTHERS)
- PAVED SHOULDER REMOVAL (BY OTHERS)
- TREE REMOVAL (WITH SIZE) (BY OTHERS)

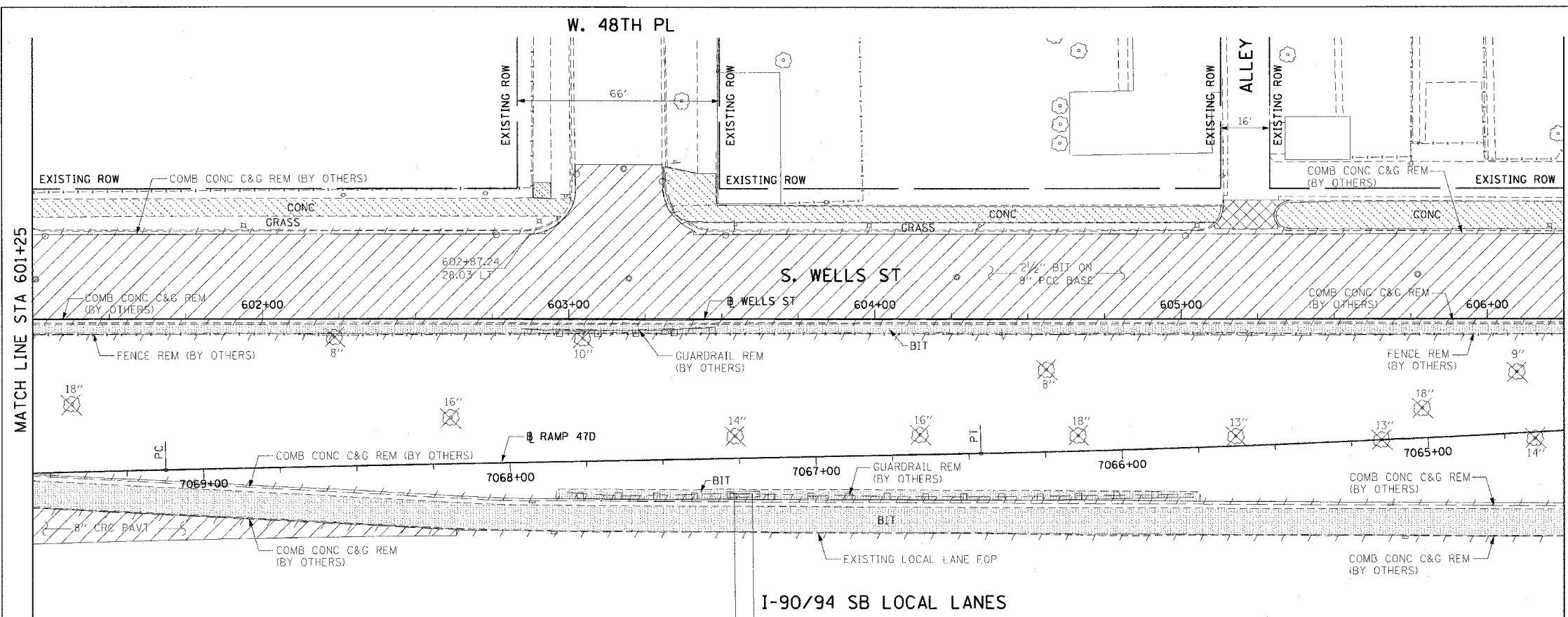

EXISTING CONDITIONS AND REMOVAL  
PROPOSED IMPROVEMENTS

LEGEND:

- WORK TO BE DONE BY OTHERS

NOTES:

1. SEE CURB DETAIL ON SHEETS 39 AND 44.
2. SEE SIDEWALK RAMP DETAIL ON SHEET 40.
3. SEE SIDEWALK DETAIL ON SHEET 41.
4. SEE ALLEY DETAIL ON SHEET 43.

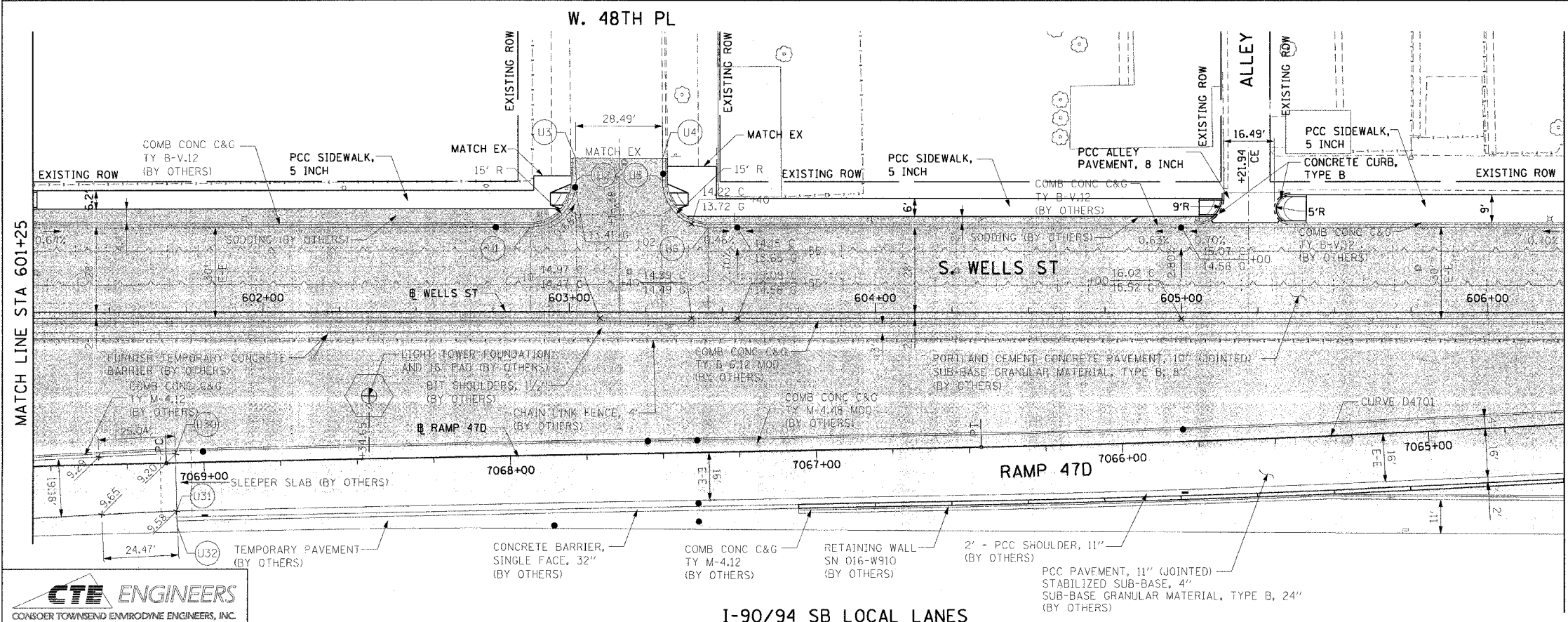

PT.	STATION	OFFSET	PT.	STATION	OFFSET
U1	602+87.24	28.00' LT	U6	603+45.62	28.00' LT
U2	603+02.24	43.21' LT	U30	7069+09.22	3.00' R1
U3	603+02.14	50.66' LT	U31	7069+09.22	16.00' L1
U4	603+30.62	50.66' L1	U32	7069+09.21	20.83' LT
U5	603+30.62	43.01' LT			

REVISIONS	NAME	DATE

ILLINOIS DEPARTMENT OF TRANSPORTATION  
F.A.I. 90/94 (DAN RYAN EXPRESSWAY)  
59th ST TO 47th ST (WELLS ST SIDEWALKS)  
EXISTING AND PROPOSED ROADWAY PLANS  
WELLS STREET

SCALE: 1"=20'  
DATE: MARCH 4, 2005  
DRAWN BY: LC  
CHECKED BY: JAL

**CTE ENGINEERS**  
CONSOER TOWNSEND ENVIRODYNE ENGINEERS, INC.  
303 EAST WACKER DRIVE, SUITE 600  
CHICAGO, ILLINOIS 60601-5202, PHONE: (312) 938-0300

I-90/94 SB LOCAL LANES