

F.A.I. R.T.E.	SECTION	COUNTY	TOTAL SHEETS	SHEET NO.
90/94	2004-0571	COOK	47	21
STA. 128+00		TO STA. 133+00		
FED. ROAD DIST. NO. 1 ILLINOIS FED. AID PROJECT				

62796

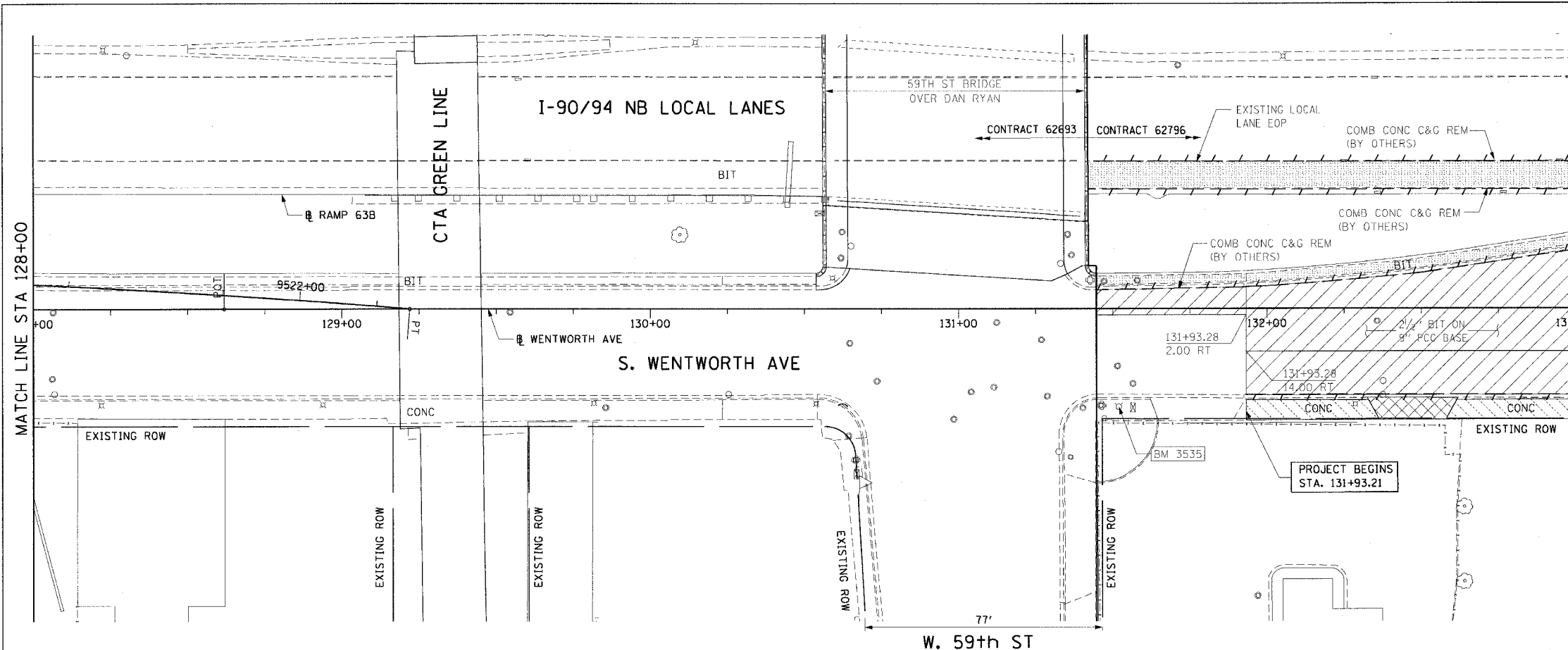

LEGEND:

- PAVEMENT REMOVAL (BY OTHERS)
- MEDIAN REMOVAL (BY OTHERS)
- LINEAR REMOVALS (BY OTHERS)
- SIDEWALK REMOVAL (BY OTHERS)
- APPROACH SLAB REMOVAL (BY OTHERS)
- DRIVEWAY PAVEMENT REMOVAL (BY OTHERS)
- PAVED SHOULDER REMOVAL (BY OTHERS)
- TREE REMOVAL (WITH SIZE) (BY OTHERS)

EXISTING CONDITIONS AND REMOVAL  
PROPOSED IMPROVEMENTS

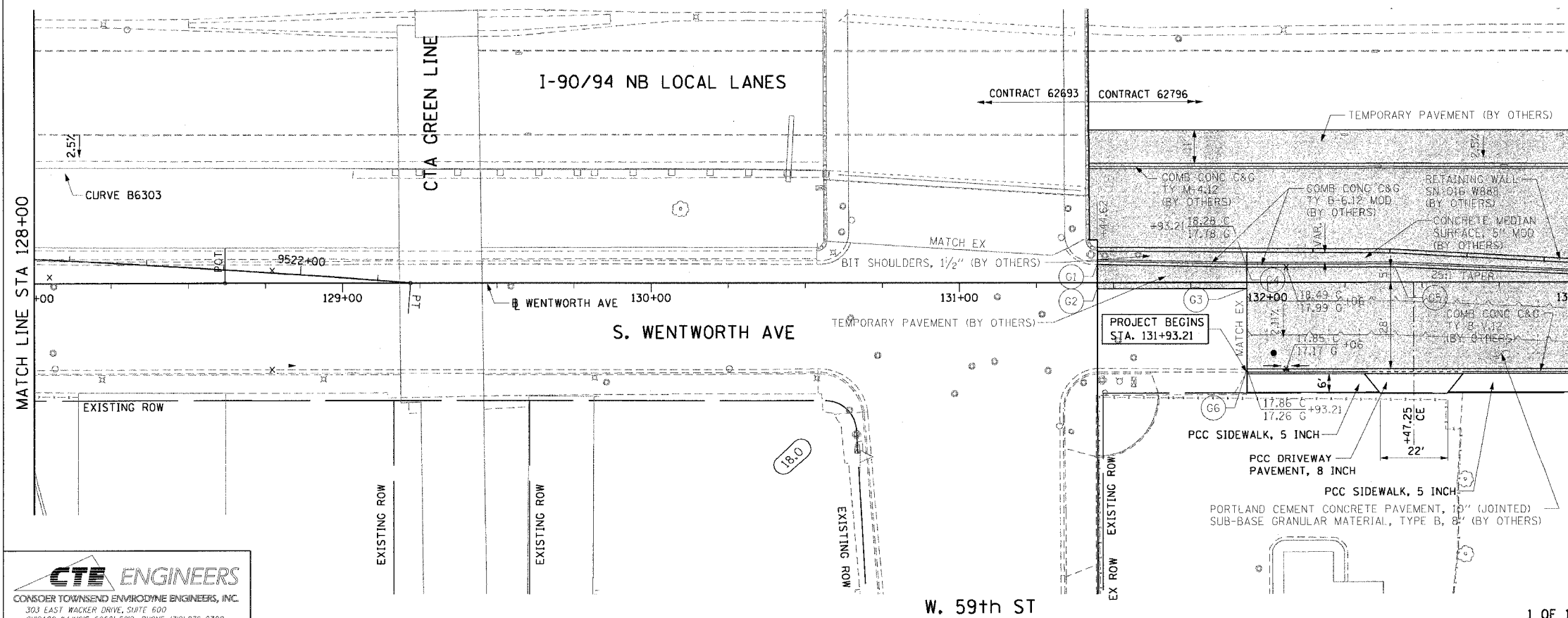

LEGEND:

- WORK TO BE DONE BY OTHERS

NOTES:

1. SEE SIDEWALK DETAIL ON SHEET 40.
2. SEE DRIVEWAY DETAIL ON SHEET 41.

PT.	STATION	OFFSET
G1	131+44.62	5.94' LT
G2	131+44.62	2.00' RT
G3	131+88.53	2.00' RT
G4	131+93.21	5.00' LT
G5	132+41.22	5.00' LT
G6	131+93.21	28.00' RT

REVISIONS	
NAME	DATE

ILLINOIS DEPARTMENT OF TRANSPORTATION  
F.A.I. 90/94 (DAN RYAN EXPRESSWAY)  
59th ST TO 47th ST (WENTWORTH AVE SIDEWALKS)

**EXISTING AND PROPOSED ROADWAY PLANS  
WENTWORTH AVENUE**

SCALE: 1"=20'  
DATE: MARCH 4, 2005

DRAWN BY: AMM/MRK  
CHECKED BY: JAL

**CTE ENGINEERS**  
CONSOER TOWNSEND ENVIRONMENTAL ENGINEERS, INC.  
303 EAST WACKER DRIVE, SUITE 600  
CHICAGO ILLINOIS 60601-5202, PHONE: (312) 938-0300

W. 59th ST

02/24/2005 04:51:28 PM