

- LEGEND:**
- PAVEMENT REMOVAL (BY OTHERS)
 - MEDIAN REMOVAL (BY OTHERS)
 - LINEAR REMOVALS (BY OTHERS)
 - SIDEWALK REMOVAL (BY OTHERS)
 - APPROACH SLAB REMOVAL (BY OTHERS)
 - DRIVEWAY PAVEMENT REMOVAL (BY OTHERS)
 - PAVED SHOULDER REMOVAL (BY OTHERS)
 - TREE REMOVAL (WITH SIZE) (BY OTHERS)

EXISTING CONDITIONS AND REMOVAL

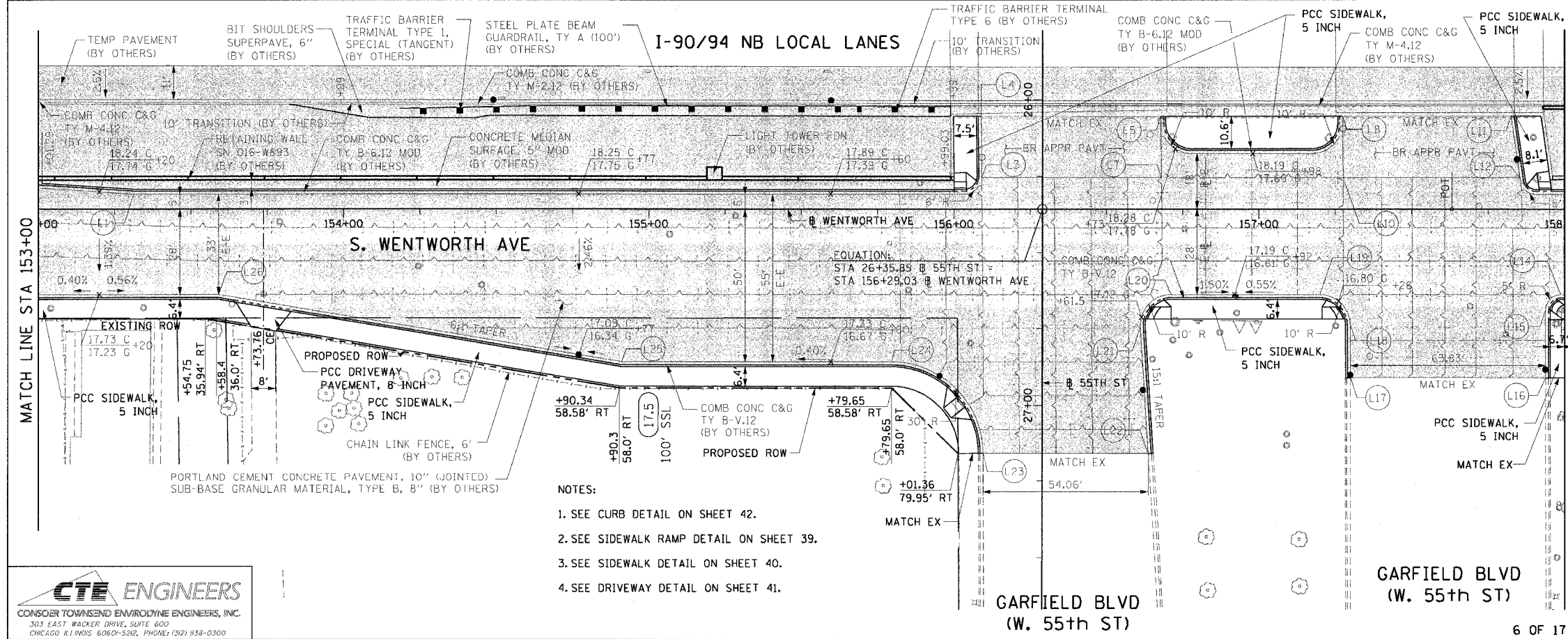

- LEGEND:**
- WORK TO BE DONE BY OTHERS

PT.	STATION	OFFSET	PT.	STATION	OFFSET
L1	153+31.21	5.00' LT	L16	157+93.87	55.12' RT
L3	156+09.20	10.44' LT	L17	157+29.98	55.15' RT
L4	156+08.99	30.44' LT	L18	157+29.93	37.97' RT
L5	156+67.83	30.44' LT	L19	157+19.93	28.00' RT
L7	156+68.11	10.44' LT	L20	156+71.09	28.00' RT
L8	157+27.39	30.43' LT	L21	156+61.11	38.61' RT
L10	157+27.54	10.43' LT	L22	155+63.63	79.96' RT
L11	157+82.50	30.45' LT	L23	156+09.57	79.88' RT
L12	157+85.44	10.45' LT	L24	155+79.57	50.00' RT
L14	157+98.85	28.00' RT	L25	154+91.05	50.00' RT
L15	157+93.85	33.00' RT	L26	153+59.05	28.00' RT

- NOTES:**
- SEE CURB DETAIL ON SHEET 42.
 - SEE SIDEWALK RAMP DETAIL ON SHEET 39.
 - SEE SIDEWALK DETAIL ON SHEET 40.
 - SEE DRIVEWAY DETAIL ON SHEET 41.

REVISIONS	
NAME	DATE

ILLINOIS DEPARTMENT OF TRANSPORTATION
F.A.I. 90/94 (DAN RYAN EXPRESSWAY)
 59th ST TO 47th ST (WENTWORTH AVE SIDEWALKS)
EXISTING AND PROPOSED ROADWAY PLANS
 WENTWORTH AVENUE

SCALE: 1"=20'
 DATE: MARCH 4, 2005

DRAWN BY: AMM/WRK
 CHECKED BY: JAL

I:\Projects\9094\9094-0571\9094-0571-26.dwg 04/03/05 04:59:18 PM