

I-90/94 NB EXPRESS LANES

F.A.I. RTE.	SECTION	COUNTY	TOTAL SHEETS	SHEET NO.
90/94	2004-0571	COOK	47	32
STA. 183+00		TO STA. 188+00		
FED. ROAD DIST. NO. 1 ILLINOIS FED. AID PROJECT				

62796

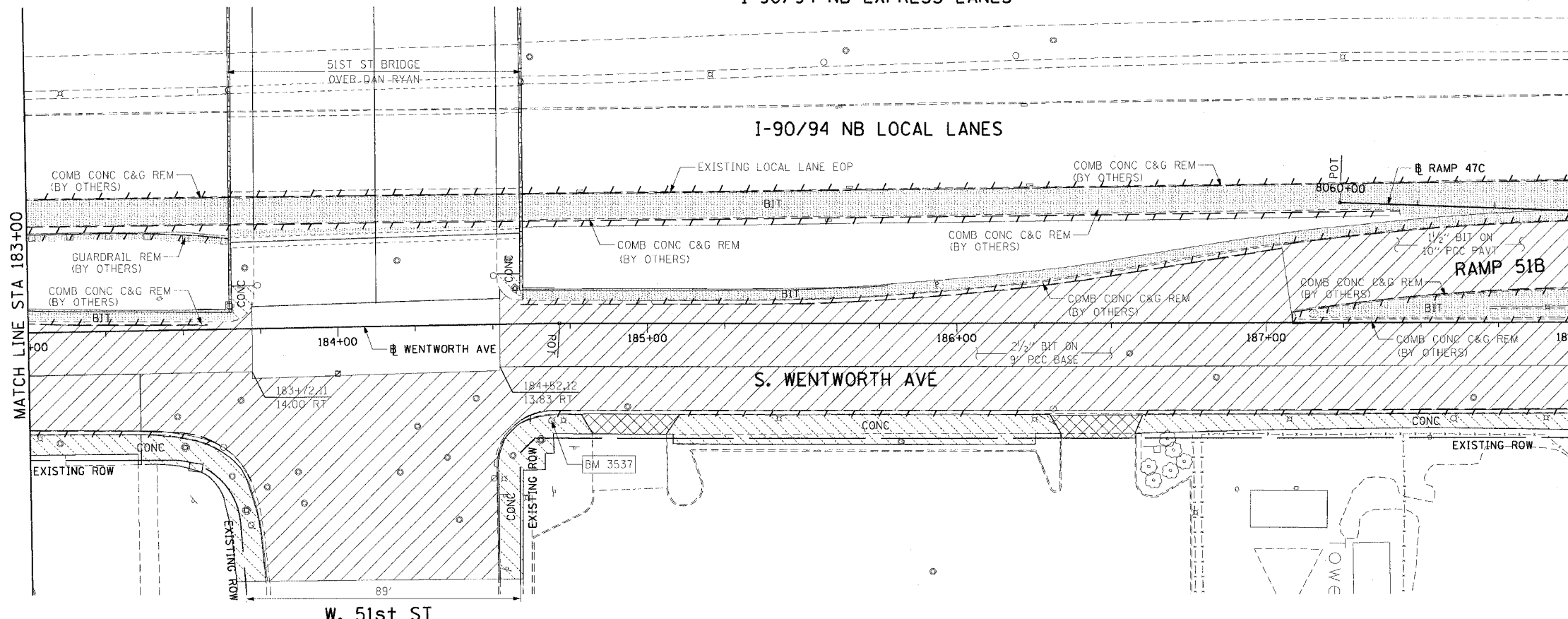

- LEGEND:
- PAVEMENT REMOVAL (BY OTHERS)
 - MEDIAN REMOVAL (BY OTHERS)
 - LINEAR REMOVALS (BY OTHERS)
 - SIDEWALK REMOVAL (BY OTHERS)
 - APPROACH SLAB REMOVAL (BY OTHERS)
 - DRIVEWAY PAVEMENT REMOVAL (BY OTHERS)
 - PAVED SHOULDER REMOVAL (BY OTHERS)
 - TREE REMOVAL (WITH SIZE) (BY OTHERS)

EXISTING CONDITIONS AND REMOVAL
PROPOSED IMPROVEMENTS

I-90/94 NB EXPRESS LANES

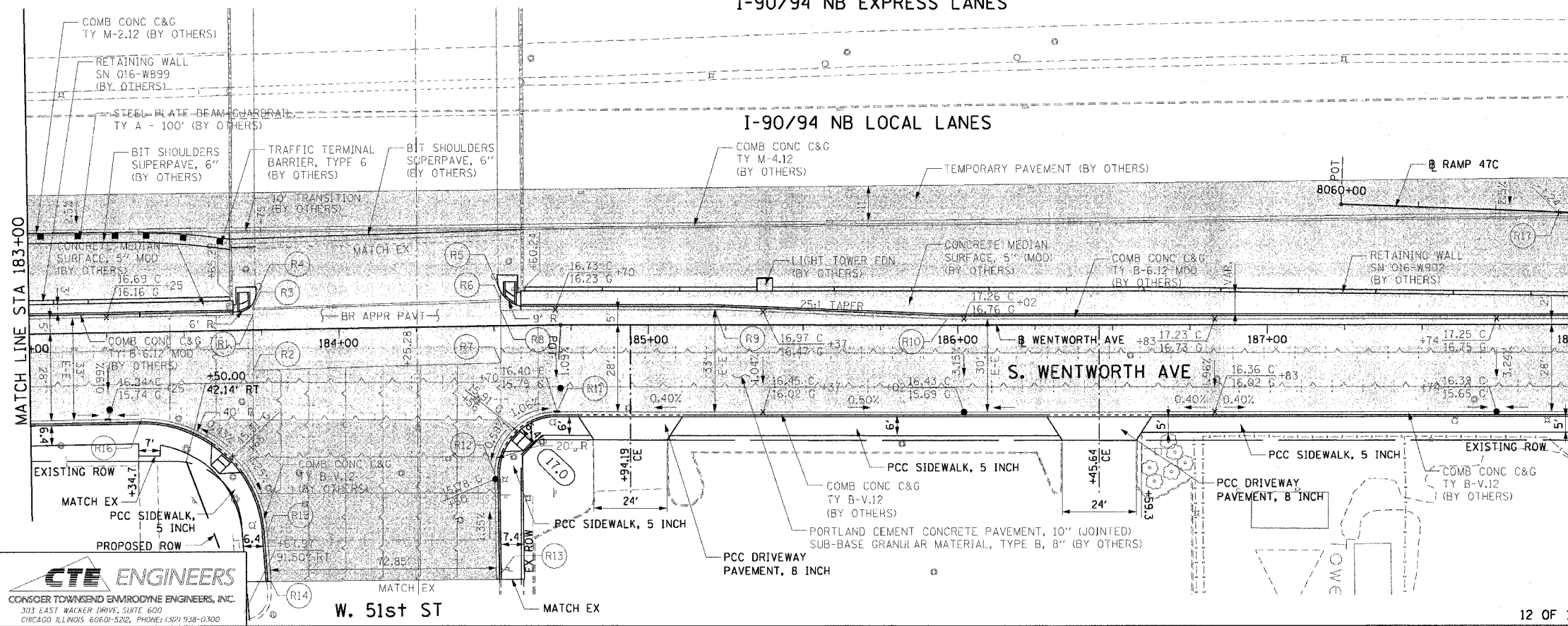

- LEGEND:
- WORK TO BE DONE BY OTHERS

- NOTES:
- SEE SIDEWALK RAMP DETAIL ON SHEET 39.
 - SEE SIDEWALK DETAIL ON SHEET 40.
 - SEE DRIVEWAY DETAIL ON SHEET 41.

PT.	STATION	OFFSET	PT.	STATION	OFFSET
R1	183+72.34	5.00' LT	R9	185+21.46	5.00' LT
R2	183+72.13	13.09' RT	R10	185+96.46	2.00' LT
R3	183+72.32	7.10' LT	R11	184+69.91	28.00' RT
R4	184+51.60	27.95' LT	R12	184+45.59	47.65' RT
R5	184+52.41	11.15' LT	R13	184+19.56	82.16' RT
R6	184+52.40	8.40' LT	R14	183+76.71	81.57' RT
R7	185+52.15	12.05' RT	R15	183+75.76	65.60' RT
R8	184+52.34	5.04' LT	R16	183+35.83	28.00' RT

REVISIONS	
NAME	DATE

ILLINOIS DEPARTMENT OF TRANSPORTATION
F.A.I. 90/94 (DAN RYAN EXPRESSWAY)
59th ST TO 47th ST (WENTWORTH AVE SIDEWALKS)

EXISTING AND PROPOSED ROADWAY PLANS
WENTWORTH AVENUE

SCALE: 1"=20'
DATE: MARCH 4, 2005

DRAWN BY: AMM/MRK
CHECKED BY: JAL

CTE ENGINEERS
CONSER TOWNSEND ENVIRONMENTAL ENGINEERS, INC.
303 EAST WACKER DRIVE, SUITE 600
CHICAGO ILLINOIS 60601-5262, PHONE: (312) 938-0300