

FAI RTE	SECTION	COUNTY	TOTAL SHEETS	SHEET NO.
80/94	0203.1B	COOK	200	16
STA.		TO STA.		
FED ROAD DIST. NO.		ILLINOIS FED. AID PROJECT		

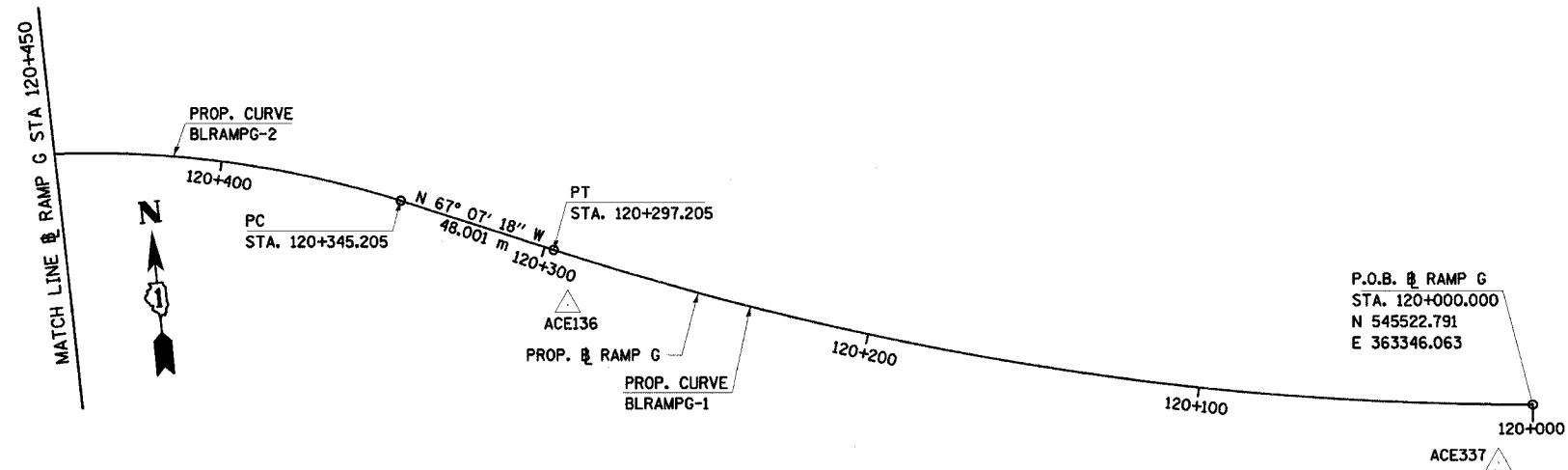

CURVE PI COORDINATES

NAME	NORTH	EAST
BLRAMPG-1	545535.900	363196.820
BLRAMPG-2	545791.118	362591.997

<p>PROP. CURVE BLRAMPG-1 PI STA. = 120+149.817 $\Delta = 17^\circ 51' 30.26''$ (RT) R = 953.533 m T = 149.817 m L = 279.205 m E = 11.698 m e = 6.0 P.C. STA. = 120+000.000 P.T. STA. = 120+297.205</p>	<p>PROP. CURVE BLRAMPG-2 PI STA. = 120+803.853 $\Delta = 113^\circ 16' 25''$ (LT) R = 302.000 m T = 458.648 m L = 597.053 m E = 247.147 m e = 6.0 S.E. OUT = STA. 121+926 TO STA. 121+025 P.C. STA. = 120+345.205 P.T. STA. = 120+942.259</p>
--	---

TB-2

ILLINOIS DEPARTMENT OF TRANSPORTATION
 I-80/94 WB FLYOVER RAMP
 TO SB IL 394 (RAMP G)

HORIZONTAL ALIGNMENT

HORIZ SCALE: 1:1000
 VERT SCALE: NONE
 DATE: MARCH 23, 2005

DRAWN BY: BAJ/JYMC
 CHECKED BY: JES

REVISIONS	
NAME	DATE

NOTE:
 COORDINATE DATA IS STATE PLANE

