

FAI RTE	SECTION	COUNTY	TOTAL SHEETS	SHEET NO.
80/94	0203.1B	COOK	200	18
STA.		TO STA.		
FED ROAD DIST. NO.		ILLINOIS FED. AID PROJECT		

NOTE:
ALL MEASUREMENTS ARE IN METERS (m)
UNLESS OTHERWISE NOTED.

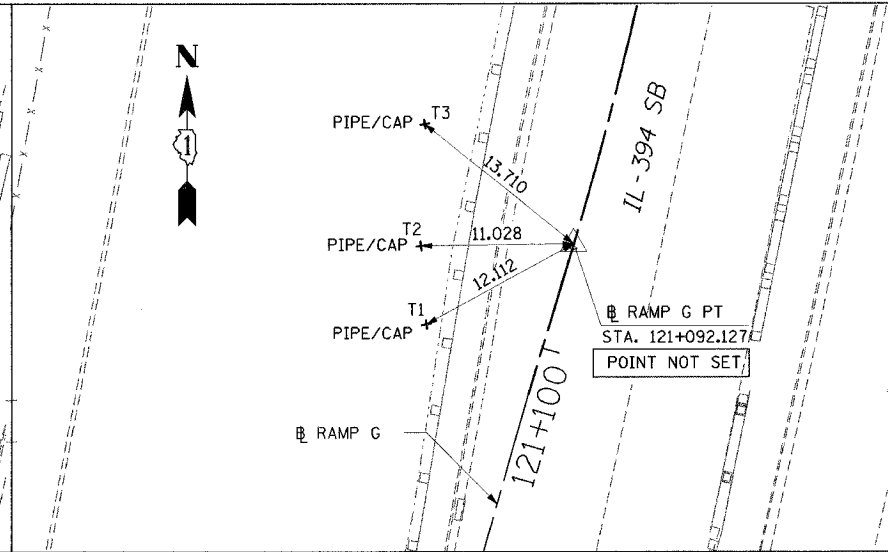
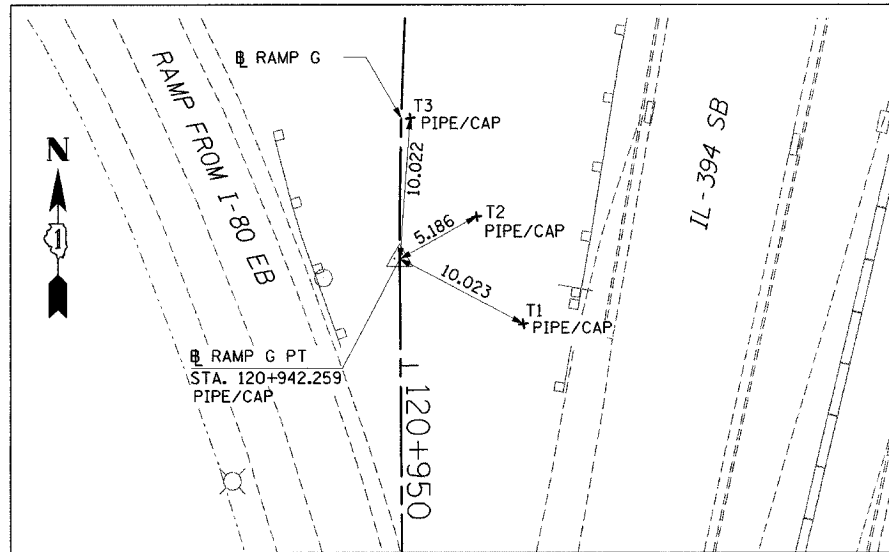

RAMP G PT STA 120+942.259
NORTHING: 545332.481 EASTING: 362595.161

RAMP G PT STA 121+092.127
NORTHING: 545183.779 EASTING: 362583.715

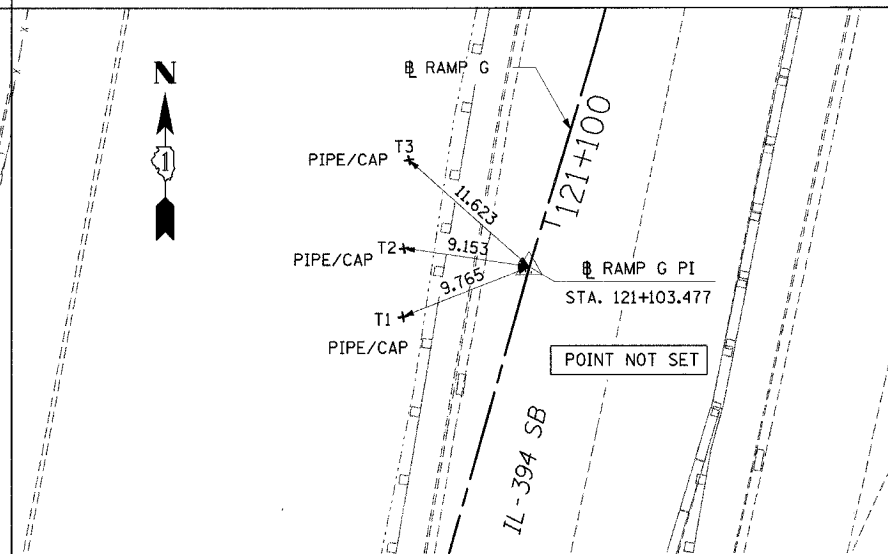
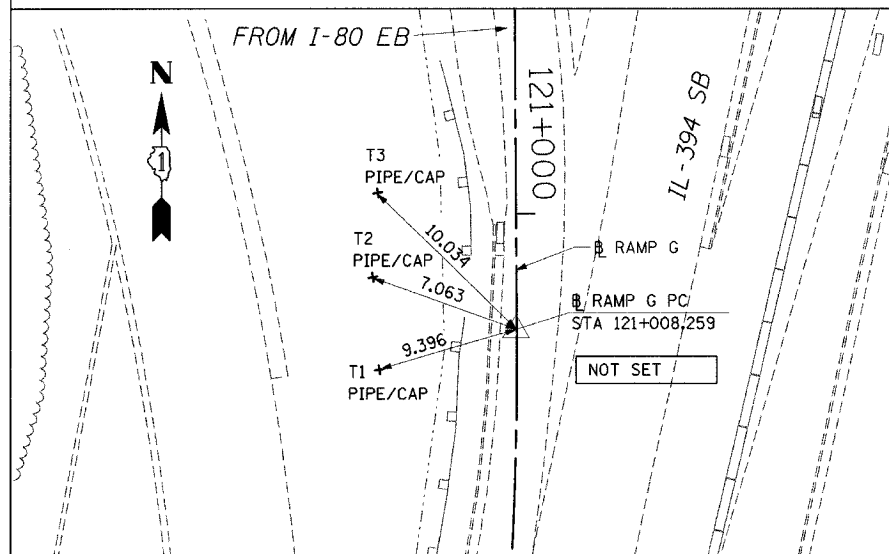

RAMP G PC STA 121+008.259
NORTHING: 545266.483 EASTING: 362583.715

RAMP G PI STA 121+103.477
NORTHING: 545172.912 EASTING: 362580.440

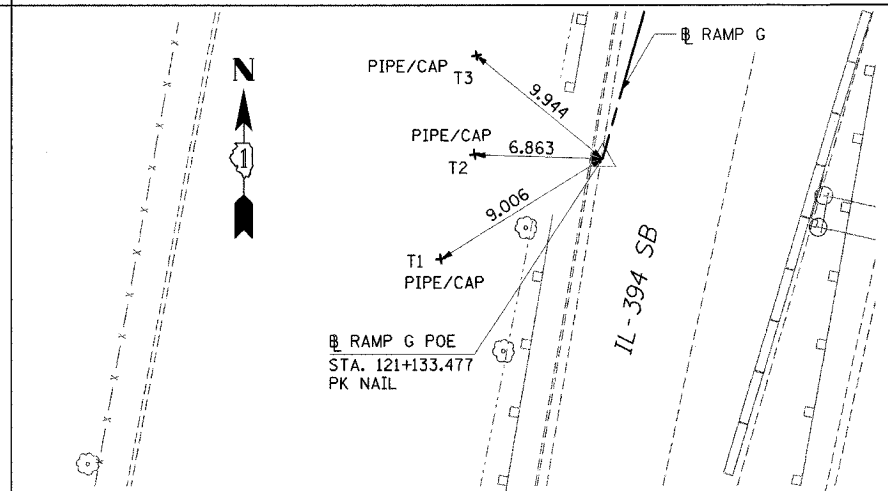
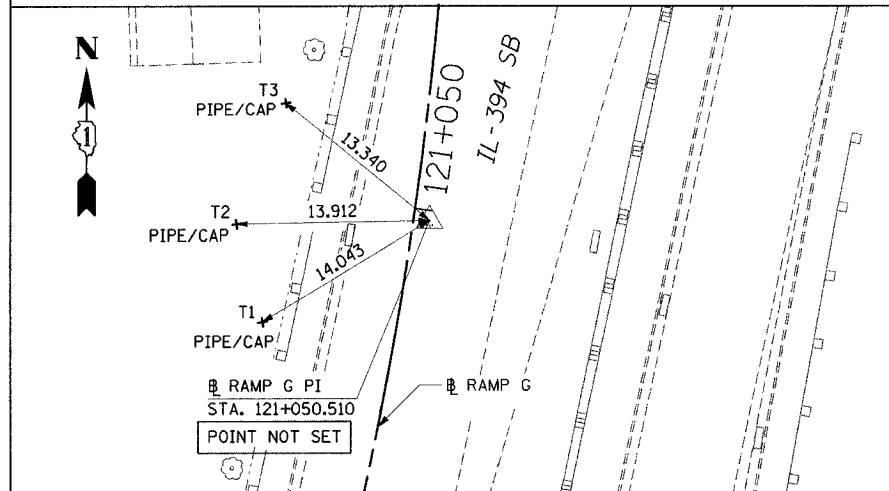

RAMP G PI STA 121+050.510
NORTHING: 545224.233 EASTING: 362595.908

RAMP G POE STA 121+133.477
NORTHING: 545144.034 EASTING: 362572.314

TB-4

ILLINOIS DEPARTMENT OF TRANSPORTATION
I-80/94 WB FLYOVER RAMP
TO SB IL 394 (RAMP G)

ALIGNMENT TIES

HORIZ SCALE: N.T.S.
VERT SCALE:
DATE: MARCH 23, 2005

DRAWN BY:BAJ/JYMC
CHECKED BY:JES



REVISIONS	
NAME	DATE