

FBI RTE	SECTION	COUNTY	TOTAL SHEETS	SHEET NO.
80/94	0203.1B	COOK	200	33
STA. 120+575		TO STA. 120+925		
FED ROAD DIST. NO.		ILLINOIS FED. AID PROJECT		

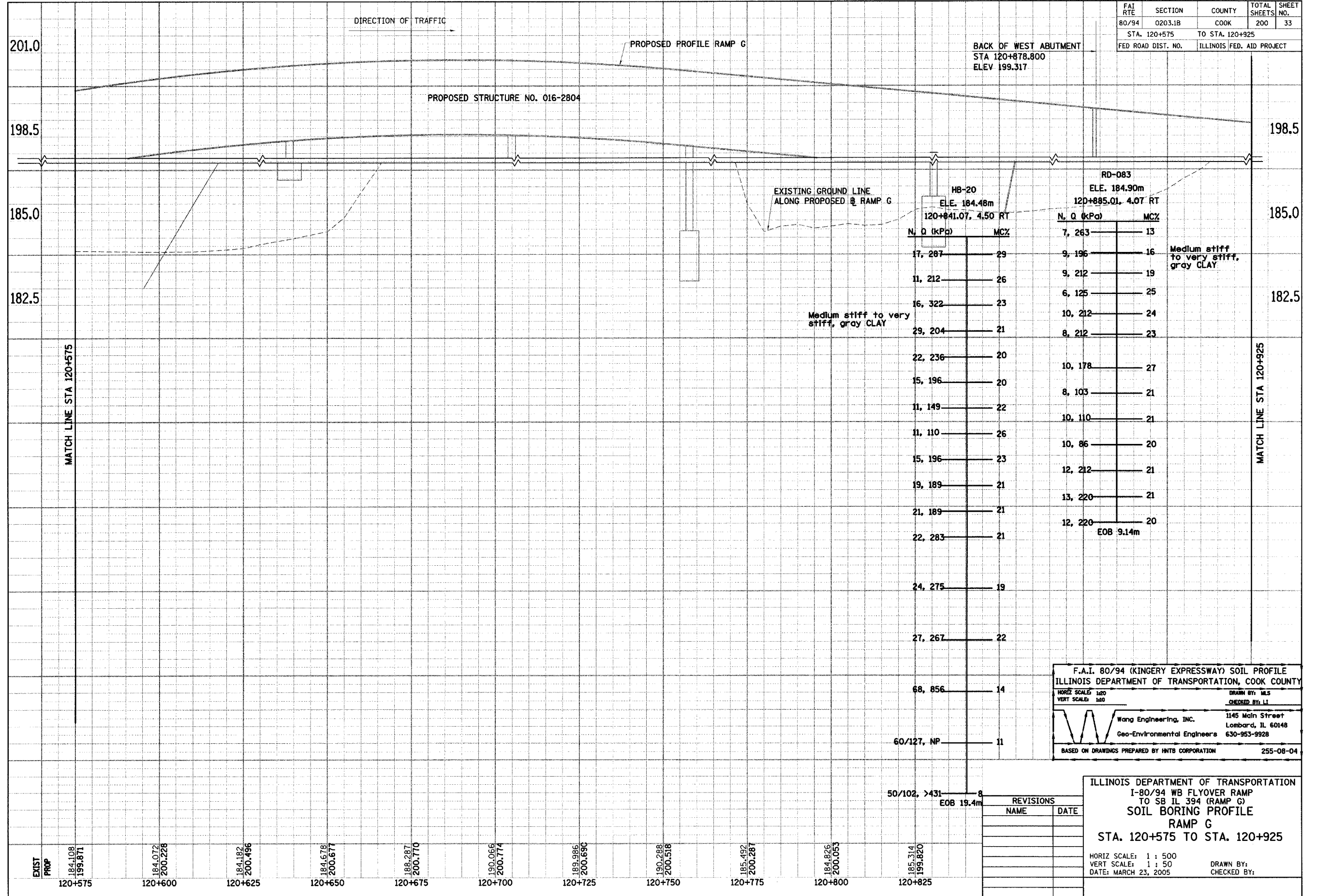

F.A.I. 80/94 (KINGERY EXPRESSWAY) SOIL PROFILE  
 ILLINOIS DEPARTMENT OF TRANSPORTATION, COOK COUNTY  
 HORIZ SCALE: 1:20  
 VERT SCALE: 1:10  
 DRAWN BY: MLS  
 CHECKED BY: LI  
 Wang Engineering, Inc. 1145 Main Street  
 Lombard, IL 60148  
 Geo-Environmental Engineers 630-953-9928  
 BASED ON DRAWINGS PREPARED BY INTB CORPORATION 255-08-04

REVISIONS	
NAME	DATE

ILLINOIS DEPARTMENT OF TRANSPORTATION  
 I-80/94 WB FLYOVER RAMP  
 TO SB IL 394 (RAMP G)  
 SOIL BORING PROFILE  
 RAMP G  
 STA. 120+575 TO STA. 120+925  
 HORIZ SCALE: 1 : 500  
 VERT SCALE: 1 : 50  
 DATE: MARCH 23, 2005  
 DRAWN BY:  
 CHECKED BY: