

STATE OF ILLINOIS  
DEPARTMENT OF TRANSPORTATION

ROUTE NO.	SECTION	COUNTY	TOTAL SHEETS	SHEET NO.
F. A. I. 80/94	0203.1B	COOK	200	64
91 SHEETS				
CONTRACT NO. 62854				

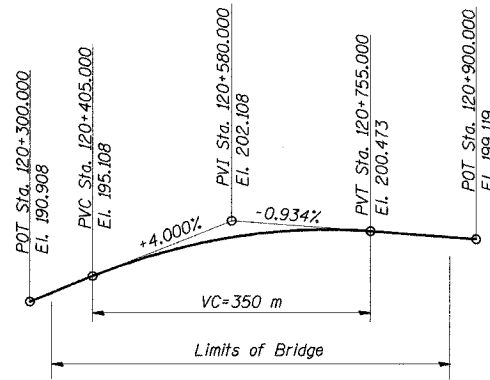

PROPOSED PROFILE GRADE RAMP G

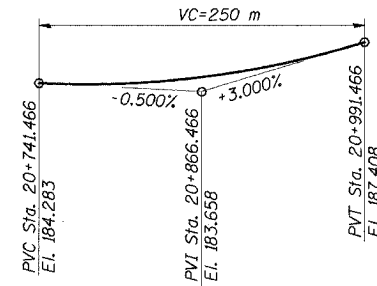

PROPOSED PROFILE GRADE I-94 EB

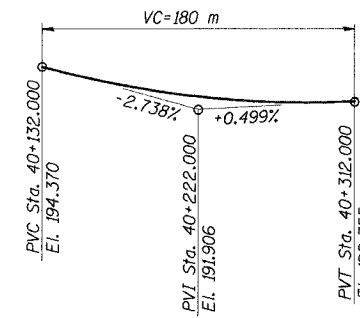

PROPOSED PROFILE GRADE NB IL 394

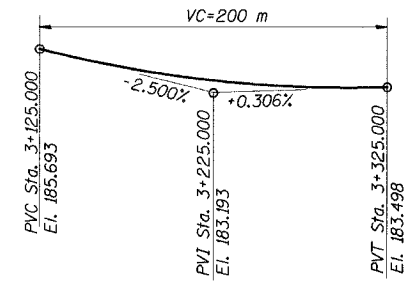

PROPOSED PROFILE GRADE I-80

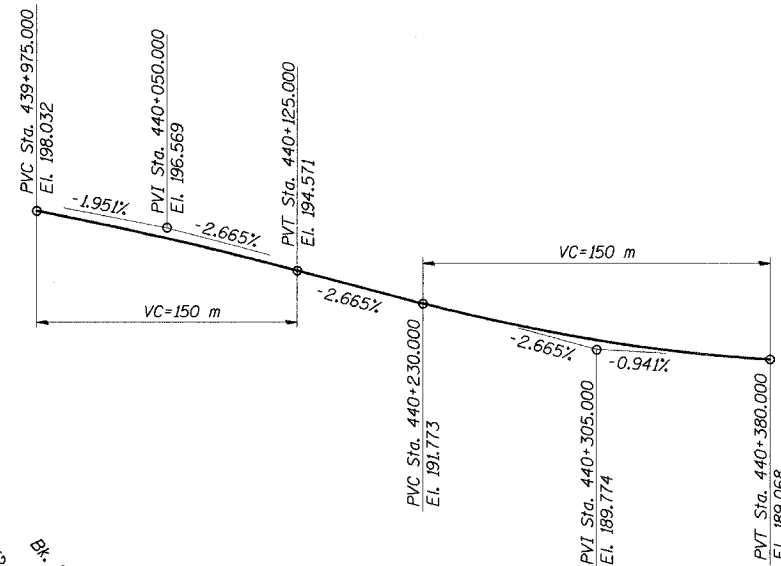

PROPOSED PROFILE GRADE SB IL 394

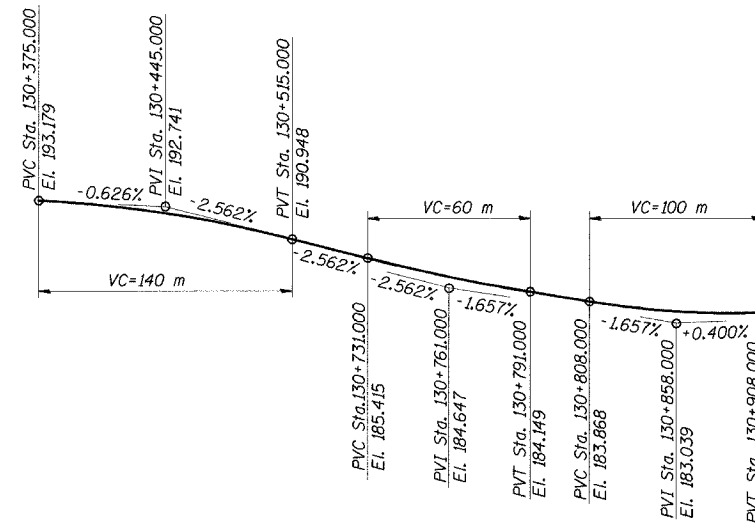

PROPOSED PROFILE GRADE RAMP H

Curve BLRAMPH-2

P.I. Sta. = 130+591.957  
 $\Delta = 241^\circ 55' 32''$   
 $D = 63^\circ 39' 43''$   
 $T = 150.006 \text{ m}$   
 $L = 380.016 \text{ m}$   
 $R = 90.000 \text{ m}$   
 $E = 264.934 \text{ m}$   
 $S.E. = 6\%$   
 $P.C. \text{ Sta.} = 130+441.951$   
 $P.C.C. \text{ Sta.} = 130+821.967$

Curve BL394NB-1

P.I. Sta. = 40+402.644  
 $\Delta = 38^\circ 44' 03''$   
 $D = 5^\circ 43' 46''$   
 $T = 351.510 \text{ m}$   
 $L = 676.039 \text{ m}$   
 $R = 1,000.000 \text{ m}$   
 $E = 59.981 \text{ m}$   
 $S.E. = 4.8\%$   
 $P.C. \text{ Sta.} = 40+051.134$   
 $P.T. \text{ Sta.} = 40+727.173$

Curve BL394SB-1

P.I. Sta. = 440+282.451  
 $\Delta = 38^\circ 53' 33''$   
 $D = 7^\circ 09' 43''$   
 $T = 282.451 \text{ m}$   
 $L = 543.043 \text{ m}$   
 $R = 800.000 \text{ m}$   
 $E = 48.398 \text{ m}$   
 $S.E. = 5.4\%$   
 $P.C. \text{ Sta.} = 440+000.000$   
 $P.T. \text{ Sta.} = 440+543.043$

\*\* Dimension measured along @ Ramp G only.  
 $90^\circ-00'-00''$  measured to Tangent to @ Ramp G at Back W. Abut.

Notes:  
 1. All dimensions are in millimeters (mm) except as noted.

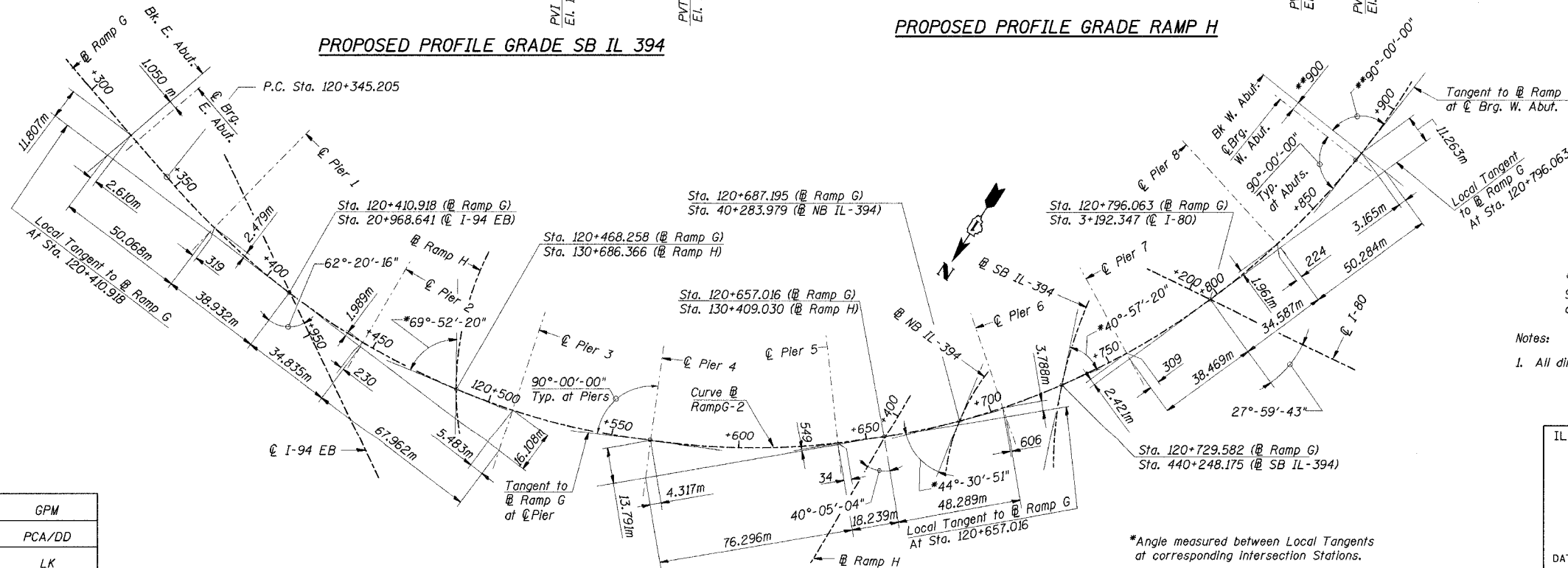

OFFSET SKETCH

J:\Research\DDA\1\CTR\_28\_2804\cadd\1500044\_2804.dgn  
 28-MAR-2005 12:37

DESIGNED	GPW
CHECKED	PCA/DD
DRAWN	LK
CHECKED	PCA/DD

ILLINOIS DEPARTMENT OF TRANSPORTATION  
 I-94/IL 394 SOUTH BOUND  
**OFFSET SKETCH AND PROFILES**  
 WB I-80/94 TO SB IL 394 - RAMP G  
 FAI 80/94 - FAP 332 SECTION 0203.1B  
 COOK COUNTY  
 STA. 120+796.063 STRUCTURE NO. 016-2804  
 DATE 3/23/05  
 SCALE

