

STATE OF ILLINOIS
DEPARTMENT OF TRANSPORTATION

ROUTE NO.	SECTION	COUNTY	TOTAL SHEETS	SHEET NO.	SHEET NO. 8 91 SHEETS
F. A. I. 80/94	0203.1B	COOK	200	70	
FED. ROAD DIST. NO. 1	ILLINOIS	FED. AID PROJECT-	CONTRACT NO. 62854		

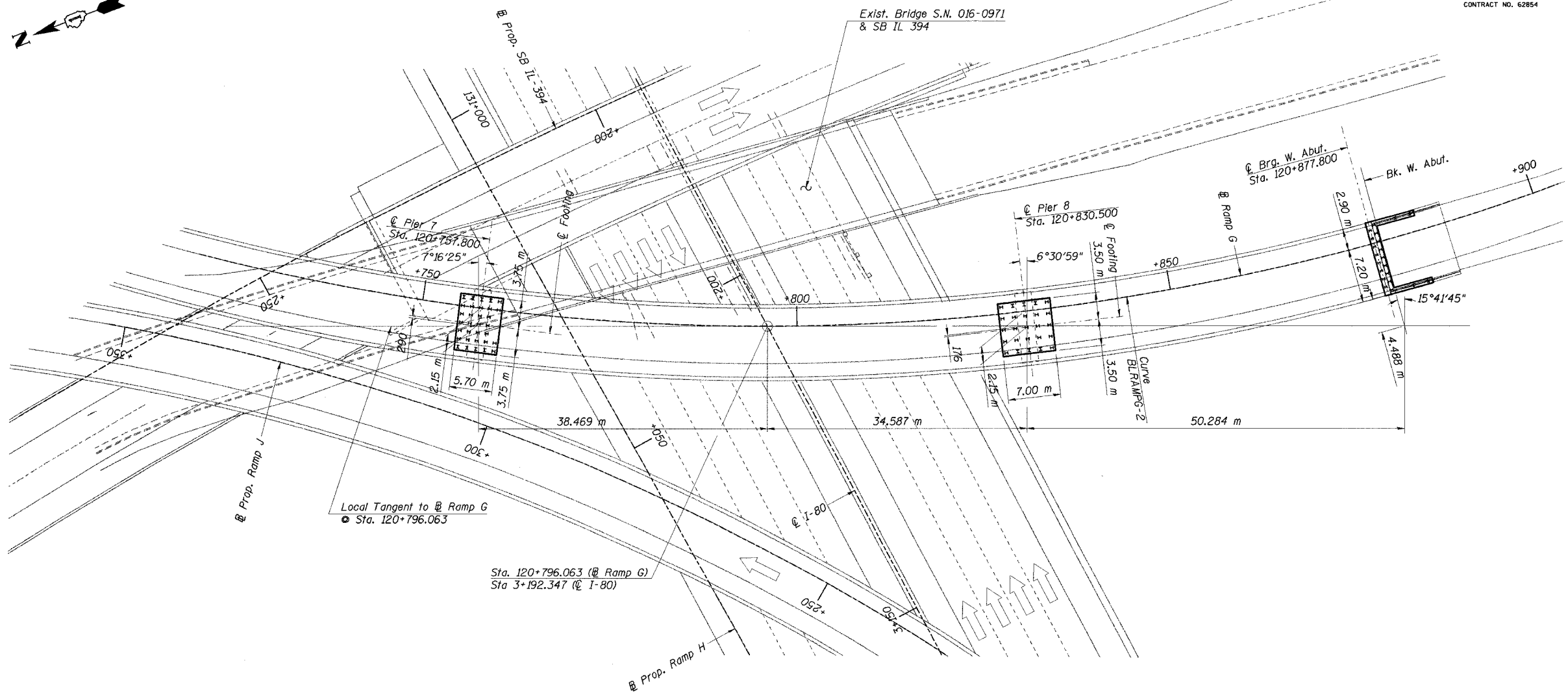

FOOTING LAYOUT - SPANS 7-9

Notes:
1. All excavation for Pier foundations shall be backfilled with CA-6 compacted to the satisfaction of the Engineer, cost included with Structure Excavation.

J:\Beauchamp
E:\34562\CD\01\CTR_28_2884\cda\1150034e_2884.dgn
28-MAR-2005 12:57

DESIGNED	JJK
CHECKED	GPM
DRAWN	LK
CHECKED	MEA

ILLINOIS DEPARTMENT OF TRANSPORTATION
I-94/IL 394 SOUTH BOUND
FOOTING LAYOUT - SPANS 7-9
WB I-80/94 TO SB IL 394 - RAMP G
FAI 80/94 - FAP 332 SECTION 0203.1B
COOK COUNTY
STA. 120+796.063 STRUCTURE NO. 016-2804
DATE 3/23/05
SCALE ---

HNTB