

F. & L. SHE.	SECTION	COUNTY	TOTAL SHEETS	SHEET NO.
80/94	0203-1B	COOK	200	168
STA.	TO STA.			
FED. ROAD DIST. NO. 7	BLINDS	FEB. AID PROJECT		

CONTRACT NO. 62854

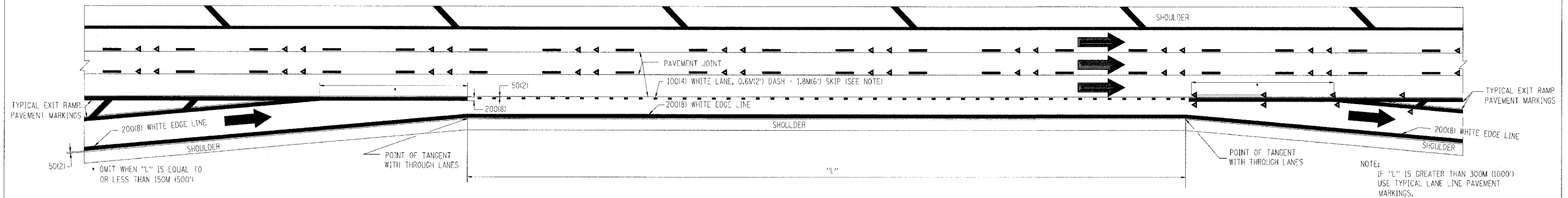

TYPICAL ENTRANCE/EXIT RAMP COMBINATION PAVEMENT MARKINGS

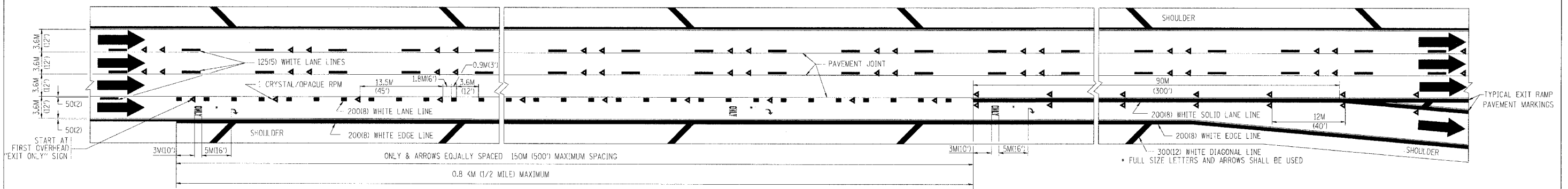

TYPICAL EXIT ONLY LANE PAVEMENT MARKINGS

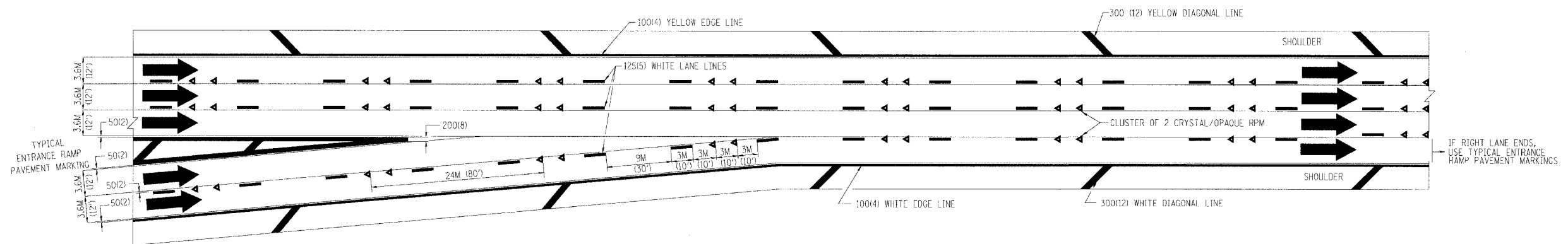

TYPICAL TWO LANE ENTRANCE RAMP PAVEMENT MARKINGS

•DATE-TIME•  
•DGN-SPEC•  
VI-TC12

REVISIONS	
NAME	DATE
DWS	1/90
DWS	5/91

ILLINOIS DEPARTMENT OF TRANSPORTATION

**MULTI-LANE FREEWAY  
PAVEMENT MARKING  
DETAILS**

SCALE: NONE  
DATE: \*\*DATE\*\*

DRAWN BY C.A.D.D.  
CHECKED BY