

Benchmarks: BM 3551 Set "+" northerly flange bolt of hydrant at southwest intersection of 95th St. and Lafayette Ave. El. 17.50
 Existing Structure: None.

F.A.I. RTE.	SECTION	COUNTY	TOTAL SHEETS	SHEET NO.
94	*	COOK	36	10
STA. 1200+00.00 TO STA. 1330+00.00				
FED. ROAD DIST. NO.		ILLINOIS	FED. AID PROJECT	
* (1516.1, 1717 & 1818) I-2		62931		

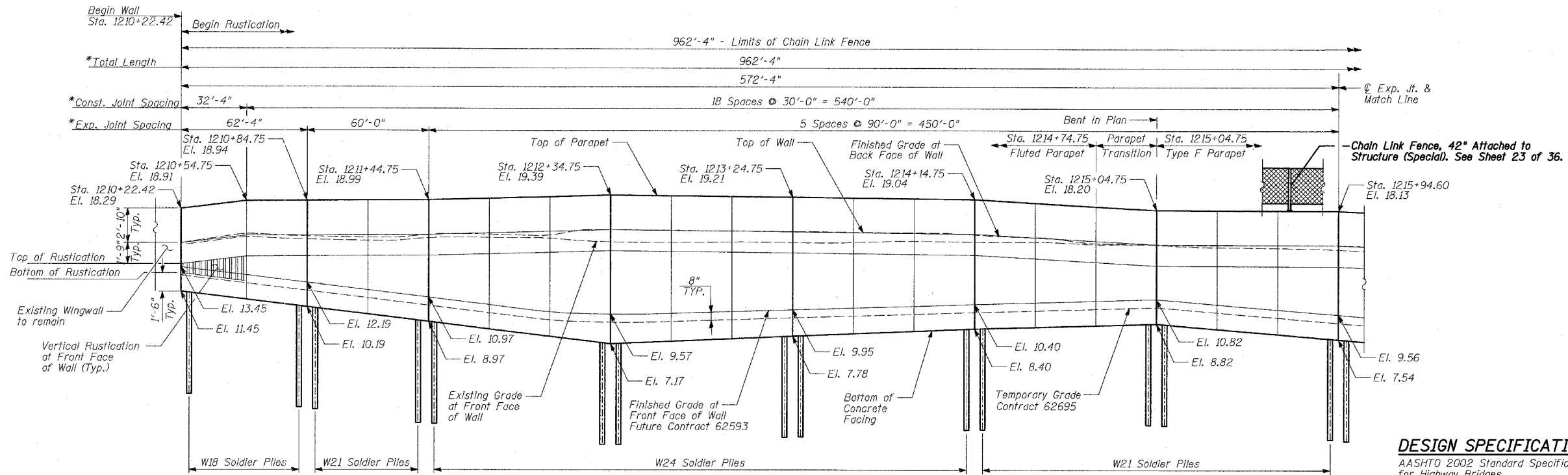

DESIGN SPECIFICATION
 AASHTO 2002 Standard Specifications for Highway Bridges

DESIGN STRESSES
FIELD UNITS

$f'_c = 3,500$ psi
 $f_y = 60,000$ psi (Reinforcement)
 $f_y = 36,000$ psi (M270 Grade 36)
 Solder Piles

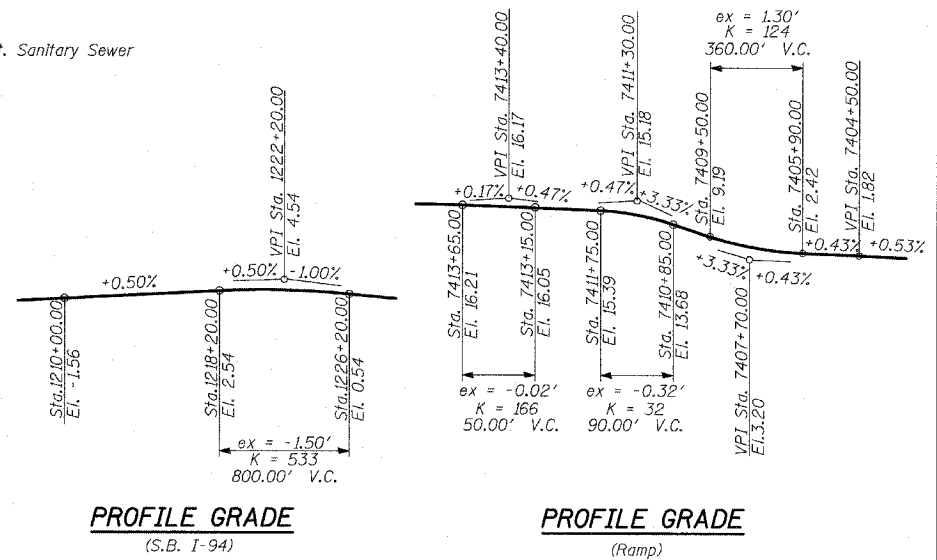
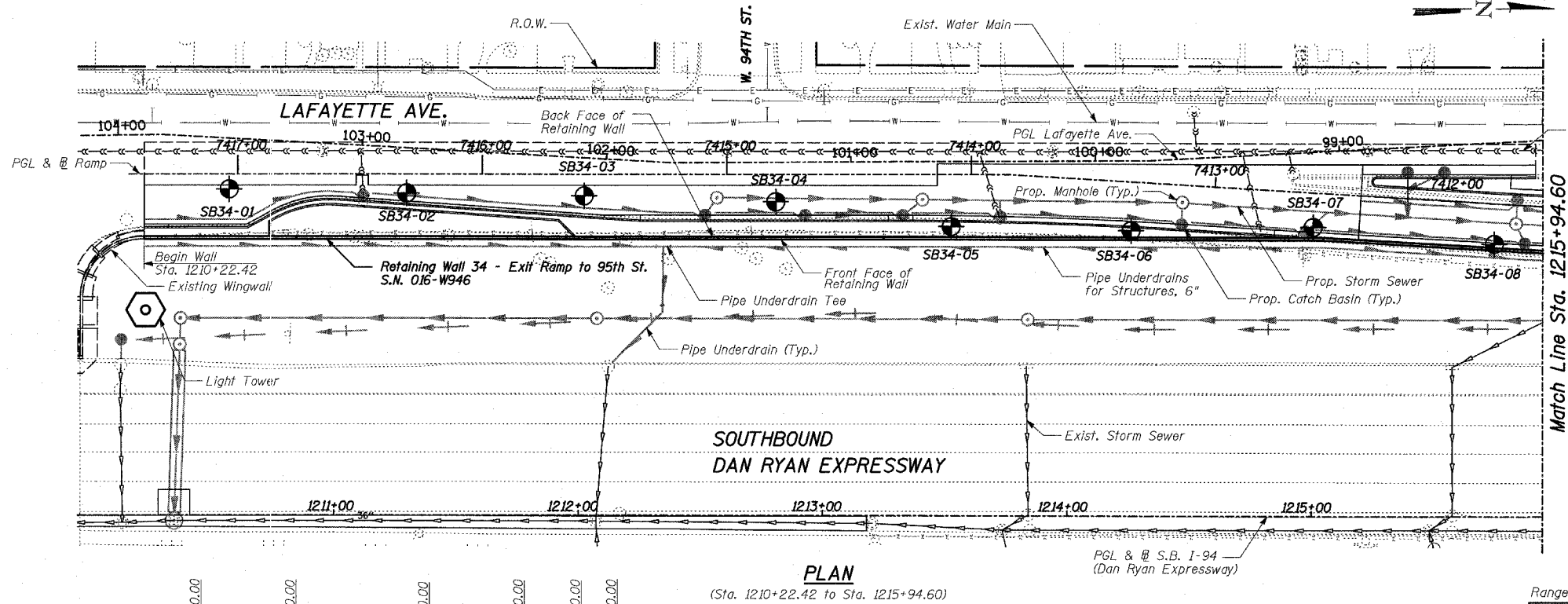

LEGEND

• Boring Location
 * Measured along Front Face of Wall.

TYLIN INTERNATIONAL

PROFILE GRADE
 (Lafayette Ave.)

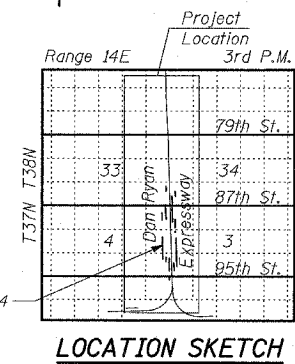
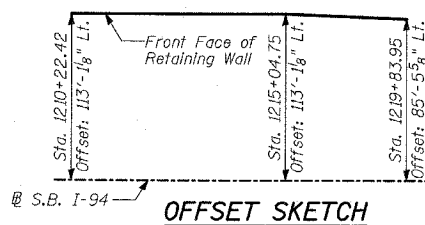

REVISIONS	
NAME	DATE

ILLINOIS DEPARTMENT OF TRANSPORTATION
F.A.I. 94 (DAN RYAN EXPRESSWAY)
RETAINING WALL ALONG LAFAYETTE AVE.
EXIT RAMP TO 95TH ST.
WALL 34 - GENERAL PLAN
 STA. 1210+22.42 TO STA. 1219+83.95
 S.N. 016-W946
 SCALE: N.T.S.
 DATE: APRIL 15, 2005

DESIGNED BY: MI, DJR
 DRAWN BY: DJR, TB
 CHECKED BY: TD, MI