

| | | | | |
|------------------------------------|---------|-----------------------------|--------------|-----------|
| F.A.I. RTE. | SECTION | COUNTY | TOTAL SHEETS | SHEET NO. |
| 94 | | COOK | 36 | 14 |
| STA. 1200+00.00 TO STA. 1330+00.00 | | ILLINOIS FED. AID PROJECT | | |
| FED. ROAD DIST. NO. | | • (1516.1, 1717 & 1818) I-2 | | |
| | | 62931 | | |

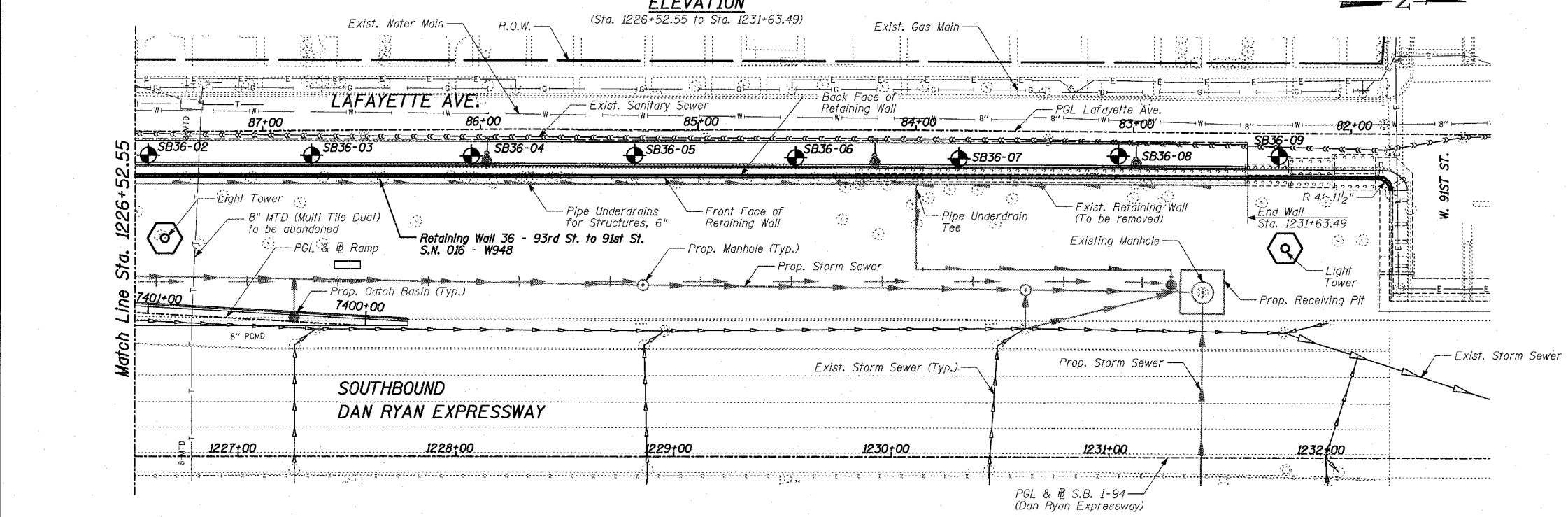
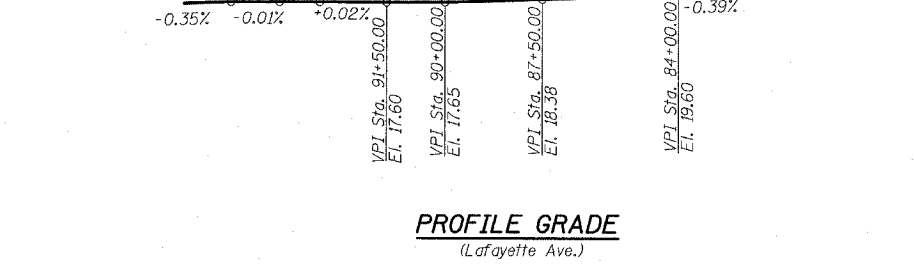
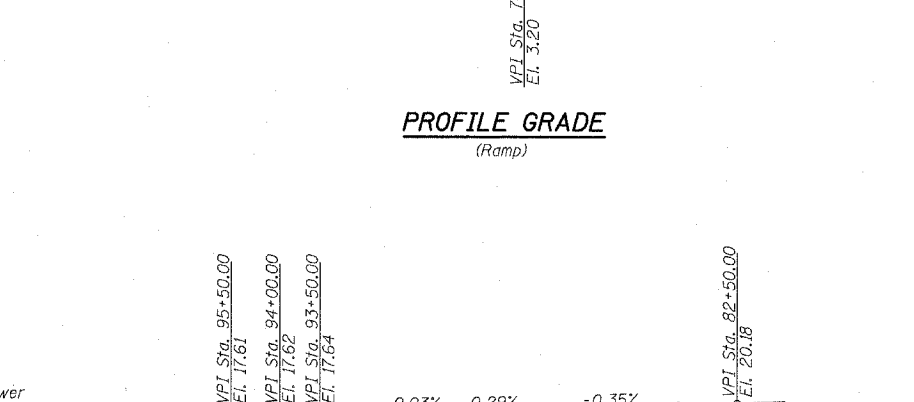
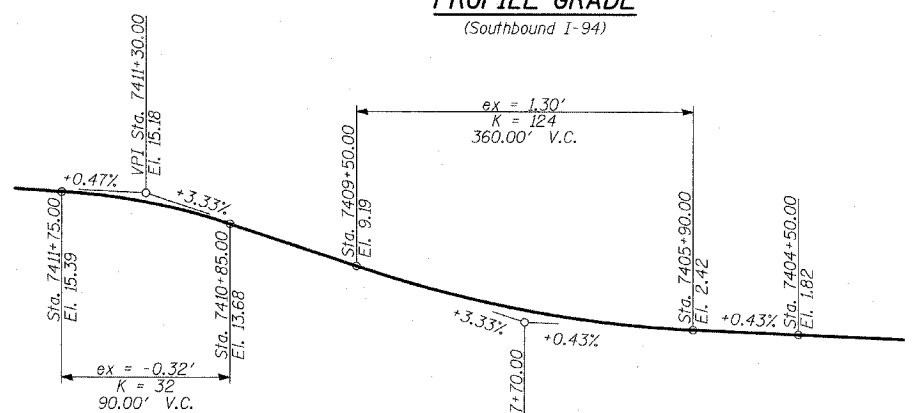
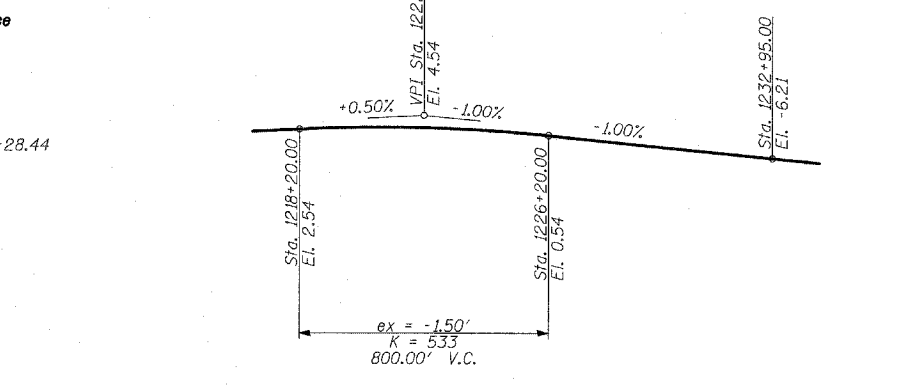
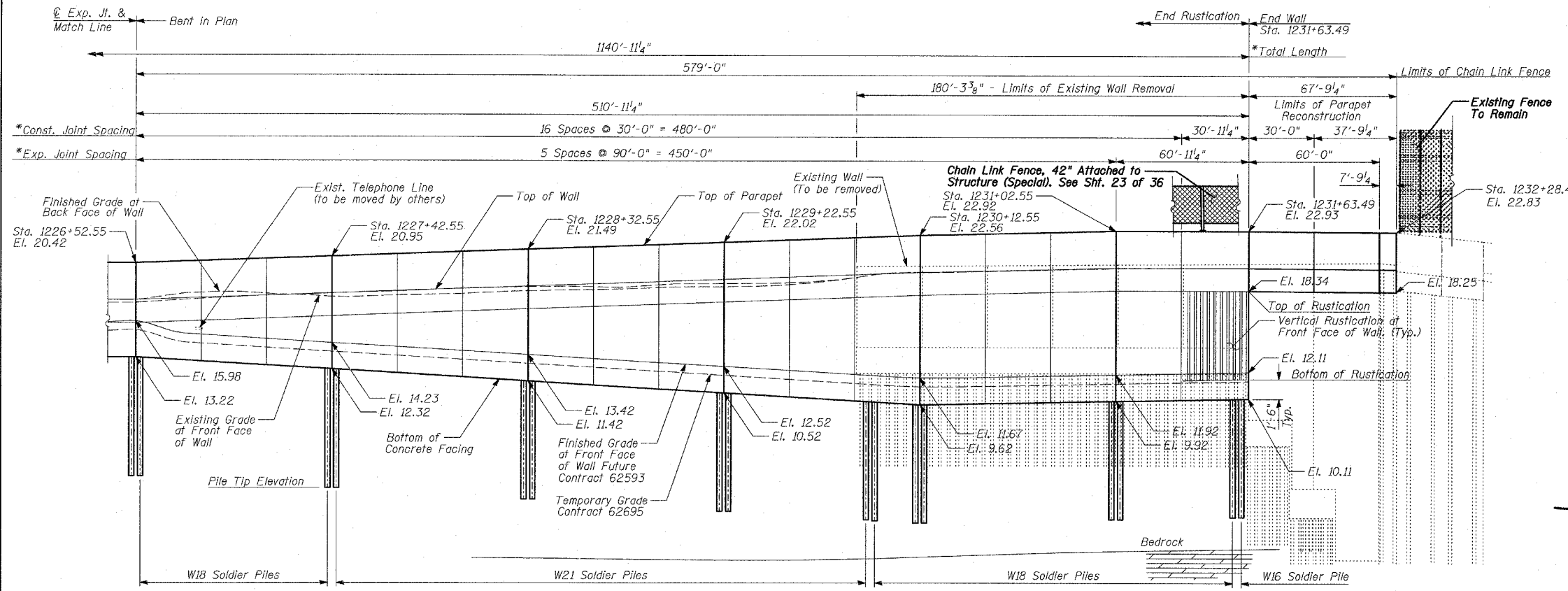

LEGEND
 • Boring Location
 * Measured along Front Face of Wall.

TYLIN INTERNATIONAL

| REVISIONS | |
|-----------|------|
| NAME | DATE |
| | |
| | |
| | |
| | |
| | |

ILLINOIS DEPARTMENT OF TRANSPORTATION
 F.A.I. 94 (DAN RYAN EXPRESSWAY)
 RETAINING WALL ALONG LAFAYETTE AVE.
 93RD ST. TO 91ST ST.
 WALL 36 - GENERAL PLAN
 STA. 1220+22.59 TO STA. 1231+63.49
 S.N. 016-W948
 SCALE: N.T.S.
 DATE: APRIL 15, 2005

DESIGNED BY: MI, DJR
 DRAWN BY: DJR, TB
 CHECKED BY: TD, MI

7/14/2005 7:17:40 AM