

F.A.I. RTE.	SECTION	COUNTY	TOTAL SHEETS	SHEET NO.
94		COOK	36	25
STA. 1200+00.00		TO STA. 1330+00.00		
FED. ROAD DIST. NO.		ILLINOIS FED. AID PROJECT		
(1516.1, 1717 & 1818) I-2				62931

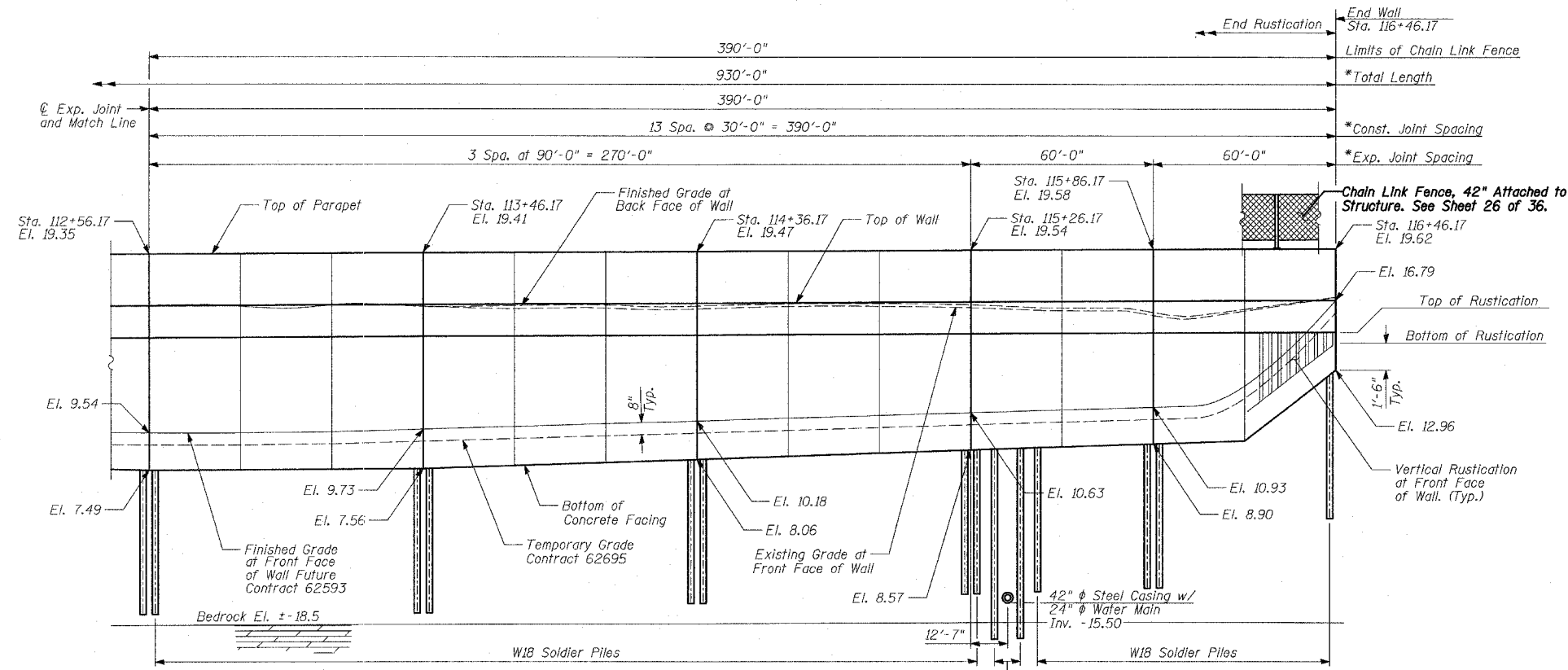

ELEVATION
(Sta. 112+56.17 to Sta. 116+46.17)

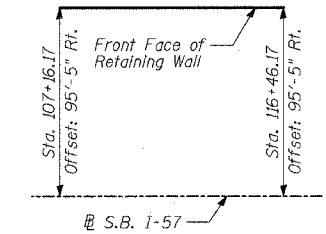

OFFSET SKETCH

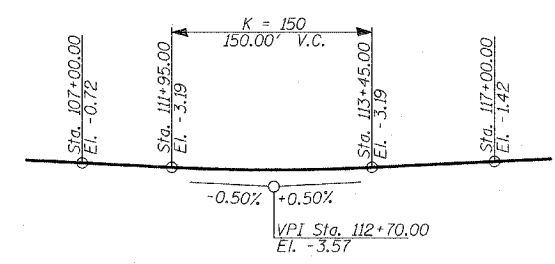

PROFILE GRADE
(S.B. I-57)

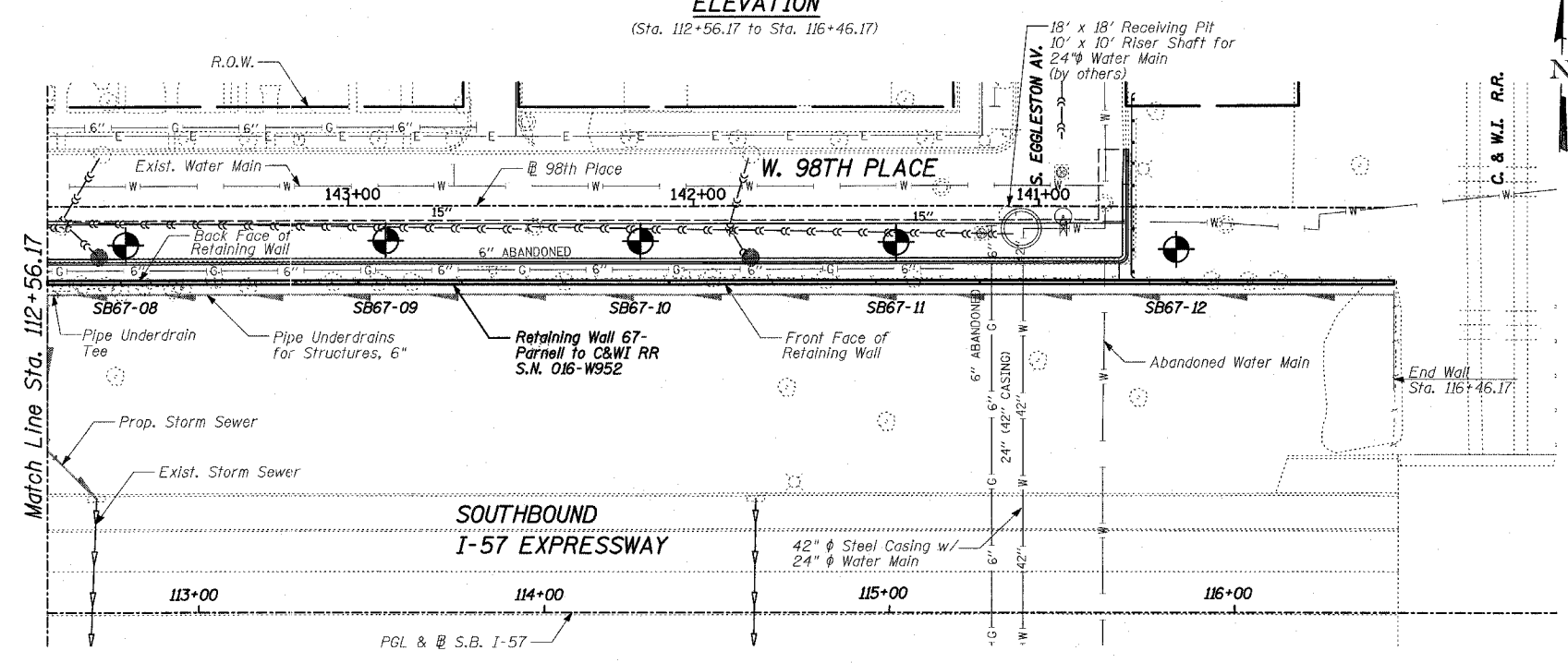

PLAN
(Sta. 112+56.17 to Sta. 116+46.17)

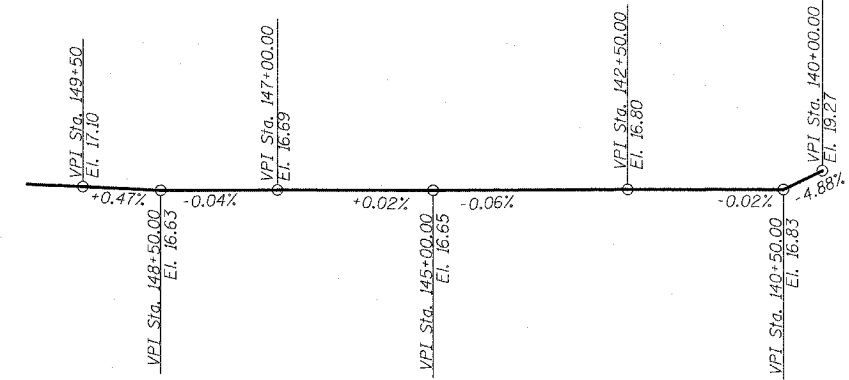

PROFILE GRADE
(W. 98th Place)

LEGEND

- Boring Location
- * Measured along Front Face of Wall.

TYLIN INTERNATIONAL

REVISIONS	
NAME	DATE

ILLINOIS DEPARTMENT OF TRANSPORTATION
F.A.I. 94 (DAN RYAN EXPRESSWAY)
RETAINING WALL ALONG W. 98TH PLACE
PARNELL TO C&WI RR
WALL 67 - GENERAL PLAN
STA. 107+16.17 TO STA. 116+46.17
 S.N. 016-W952 DESIGNED BY: MI, DJR
 SCALE: N.T.S. DRAWN BY: DJR, TB
 DATE: APRIL 15, 2005 CHECKED BY: TD, MI

P:\02373\road\of\ng\ret\1\ret\st1253-w982.dgn 4/14/2005 7:18:44 AM