

Benchmarks: BM 3553 Set "+" northwest bolt of traffic signal/light base at northeast intersection of 87th St. and State St. El. 8.47

Existing Structure: None.

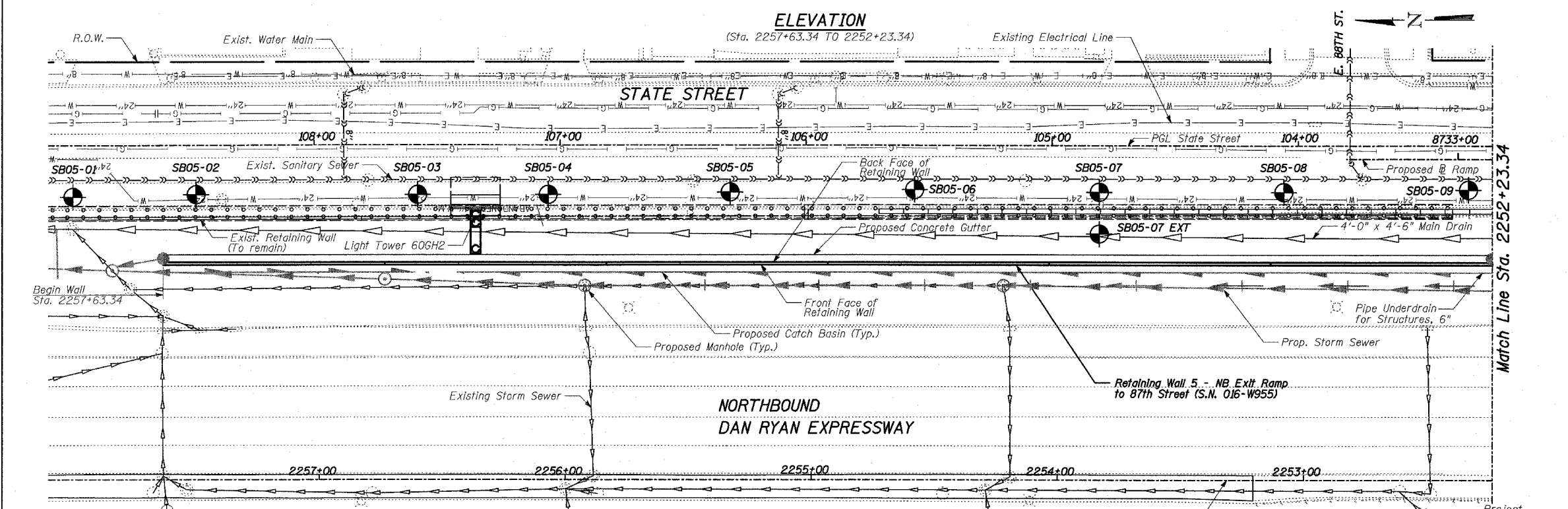
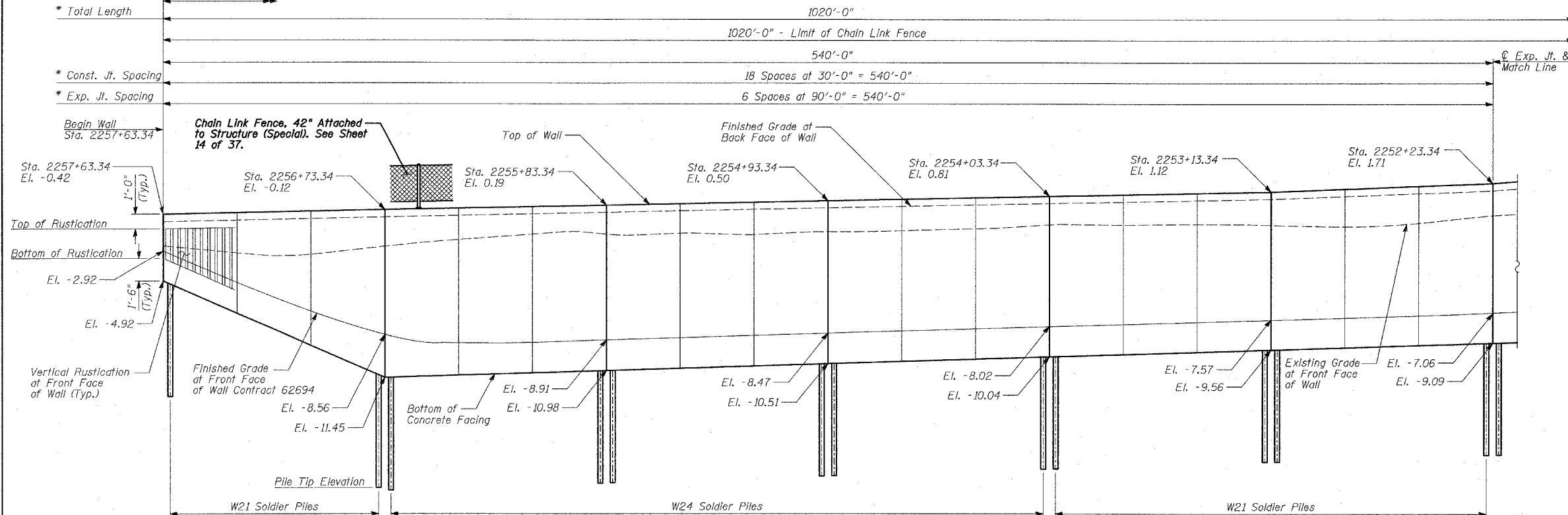

**LEGEND**  
 ● Boring Location  
 \* Measured along Front Face of Wall.

**TYLIN INTERNATIONAL**

F.A.I. RTE.	SECTION	COUNTY	TOTAL SHEETS	SHEET NO.
94		COOK	37	11
STA. 2210+00.00 TO STA. 2356+00.00				
FED. ROAD DIST. NO.		ILLINOIS FED. AID PROJECT		
(1516.1, 1717 & 1818) I-3				62932

**DESIGN SPECIFICATION**  
 AASHTO 2002 Standard Specifications for Highway Bridges

**DESIGN STRESSES**  
**FIELD UNITS**  
 f'c = 3,500 psi  
 fy = 60,000 psi (Reinforcement)  
 fy = 36,000 psi (M270 Grade 36) Soldier Piles

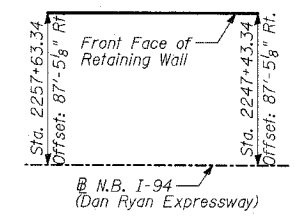

**OFFSET SKETCH**

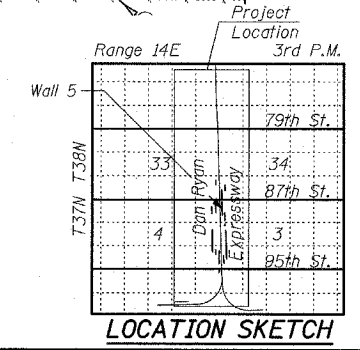

**LOCATION SKETCH**

REVISIONS	
NAME	DATE

ILLINOIS DEPARTMENT OF TRANSPORTATION  
 F.A.I. 94 (DAN RYAN EXPRESSWAY)  
 RETAINING WALL ALONG STATE ST.  
 EXIT RAMP TO 87TH ST.  
 WALL 5 - GENERAL PLAN  
 STA. 2257+63.34 TO STA. 2247+43.34  
 S.N. 016-W955 DESIGNED BY: MI, TB  
 SCALE: N.T.S. DRAWN BY: TB, DJR  
 DATE: APRIL 15, 2005 CHECKED BY: TD, MI

04/15/2005 07:28:48 AM